

CLAIM OF BENEFICIAL USE MAP
 GLENN WILLIS PETERSON
 FILE NO. SWR-277
 SECTION 12, T24S, R13W, W.M.

RECEIVED

JAN 24 1994

WATER RESOURCES DEPT.
 SALEM, OREGON

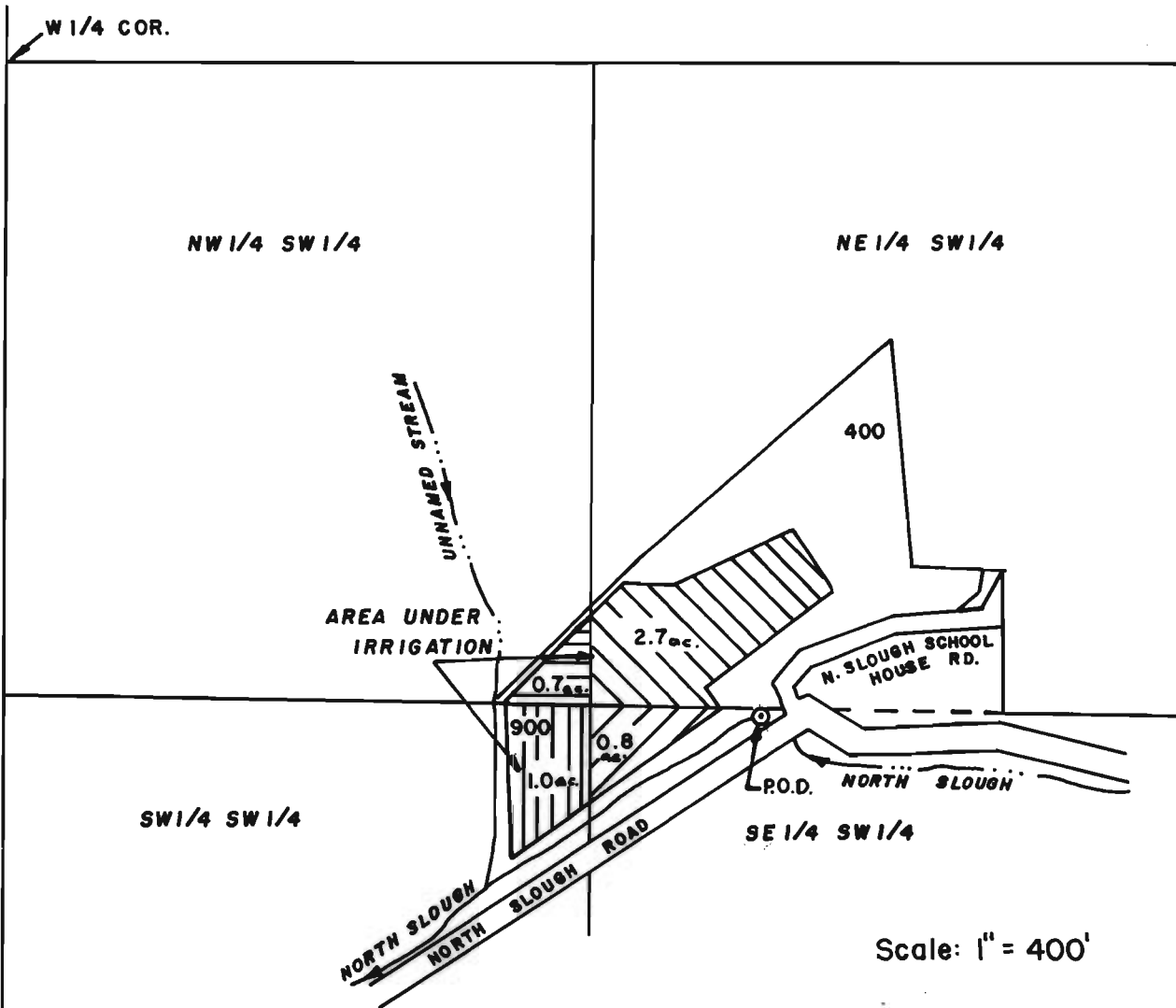

The point of diversion is S50°06'E, 2220' from the W 1/4 corner between sections 11 & 12.

11	12
14	13

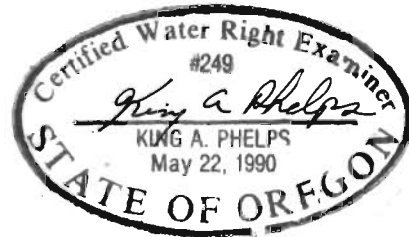

THE PURPOSE OF THIS MAP IS TO IDENTIFY THE LOCATION OF THE WATER RIGHT IT IS NOT INTENDED TO PROVIDE INFORMATION RELATIVE TO THE LOCATION OF PROPERTY OWNERSHIP BOUNDARY LINES.