

T. 28 S., R. 13 W. Sec. 26 SWR 282

Map for a pre-1909 Surface Water Registration

Scale: 1" = 400ft.

Survey date: Feb. 4, 1993

This map is not the result of a property survey and is not to be used as such.

For: Virginia E. Robison

Fishtrap Creek is a tributary of Coquille River.

A 1/2 h.p. motor lifts the water 15' ft. and delivers 0.165 CFS to a water trough for 50 cows, OREGON

RECEIVED

MAR - 2 1993

WATER RESOURCES DEPT. SALEM, OREGON

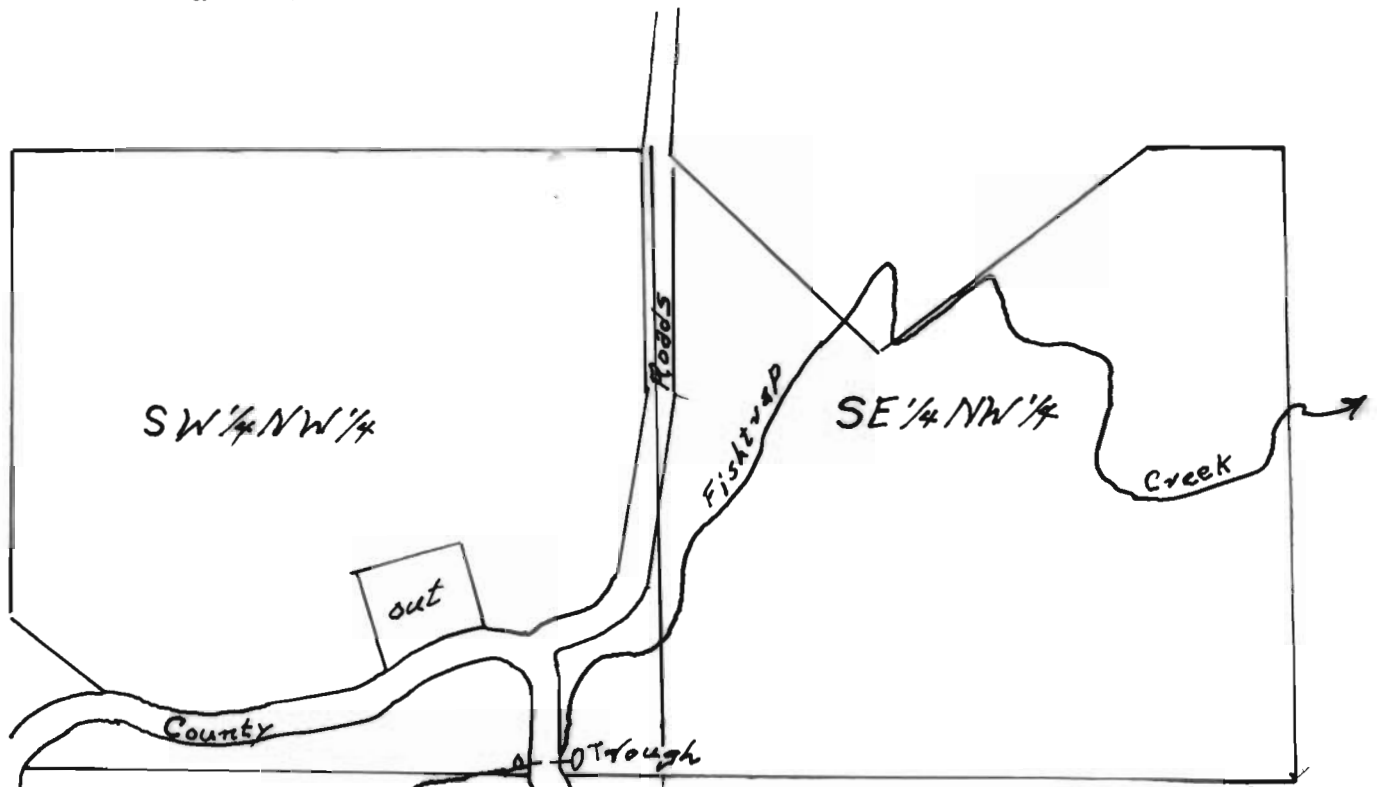

POD is 25 ft. N. + 14.85 ft. W. of C. 1/4 Sec. 26

Water Use: Stock Watering from troughs.

C. 1/4 Sec. 26

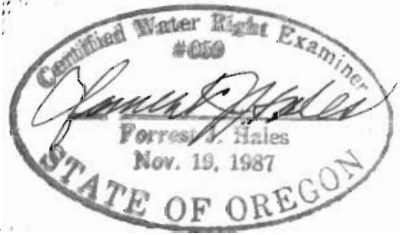

10-18-93.

RECEIVED

OCT 26 1993

WATER RESOURCES DEPT. SALEM, OREGON