

REGISTRATION STATEMENT MAP
PRE-1909 VESTED WATER RIGHT CLAIM

IN THE NAME OF HOYT L. LITTERELL

SECTIONS 16, 21 & 22, T 32 S, R 15 W, W.M.

MAP 1 of 2
(1908 - 1968)

RECEIVED

DEC 29 1992

WATER RESOURCES DEPT.
SALEM, OREGON

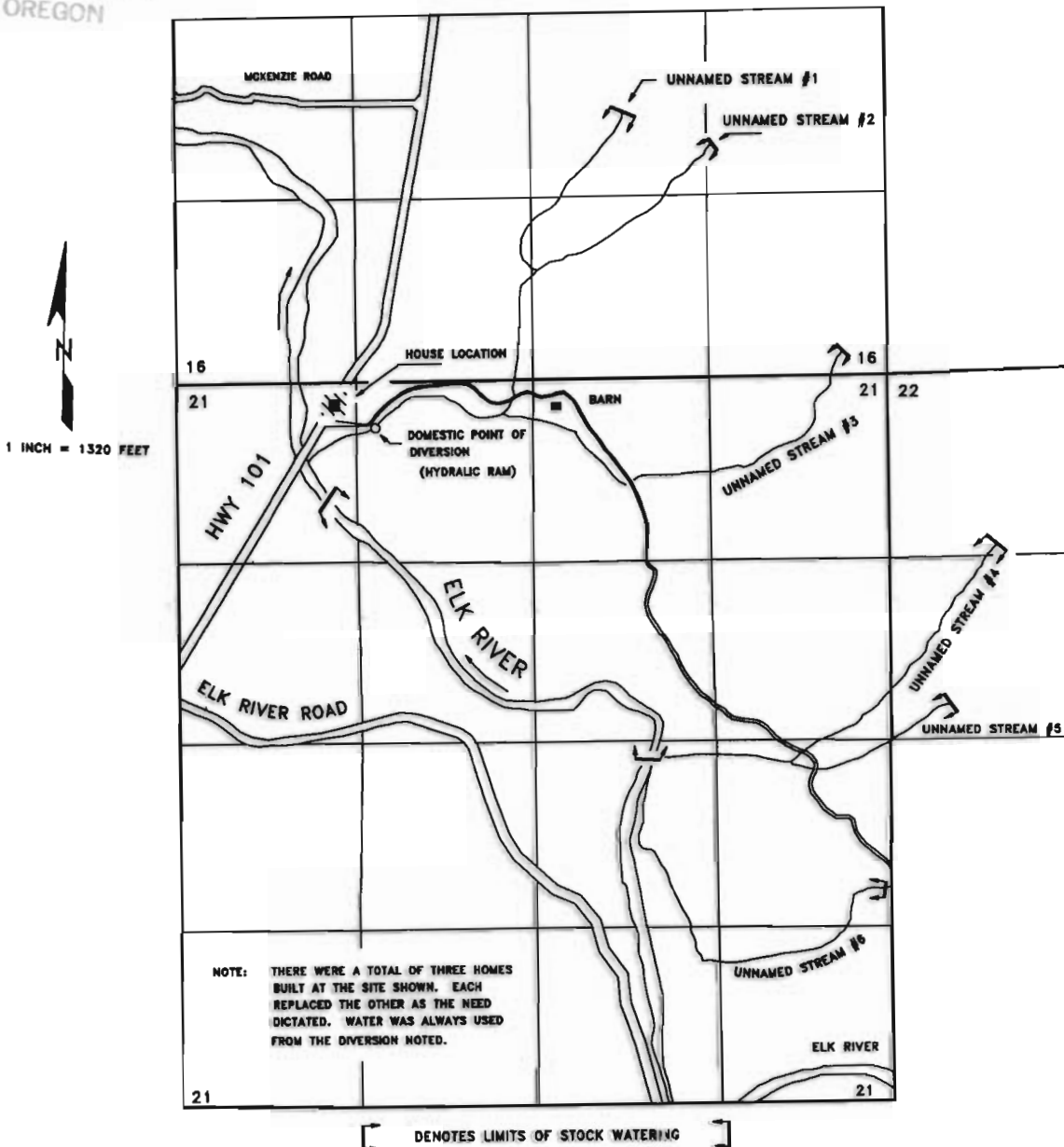

THE POINT OF DIVERSION FOR DOMESTIC USE WAS LOCATED 340 FEET SOUTH AND 1460 FEET EAST FROM THE NORTHWEST CORNER OF SECTION 21, BEING WITHIN THE NE¼NW¼ OF SECTION 21, TOWNSHIP 32 SOUTH, RANGE 15 WEST, W.M., COOS COUNTY.

STOCK WAS NORMALLY WATERED FROM THE NATURAL CREEK/RIVER CHANNEL AS DEPICTED ON THE MAP.

THE PURPOSE OF THIS MAP IS TO IDENTIFY THE LOCATION OF THE WATER RIGHT. IT IS NOT INTENDED TO PROVIDE INFORMATION RELATIVE TO THE LOCATION OF PROPERTY OWNERSHIP BOUNDARY LINES.

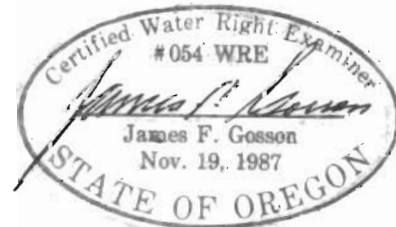

REGISTRATION STATEMENT MAP
PRE-1909 VESTED WATER RIGHT CLAIM

IN THE NAME OF HOYT L. LITTERELL

SECTIONS 16, 21 & 22, T 32 S, R 15 W, W.M.

MAP 2 of 3
(1968 - 1992)

RECEIVED

DEC 29 1992

WATER RESOURCES DEPT.
SALEM, OREGON

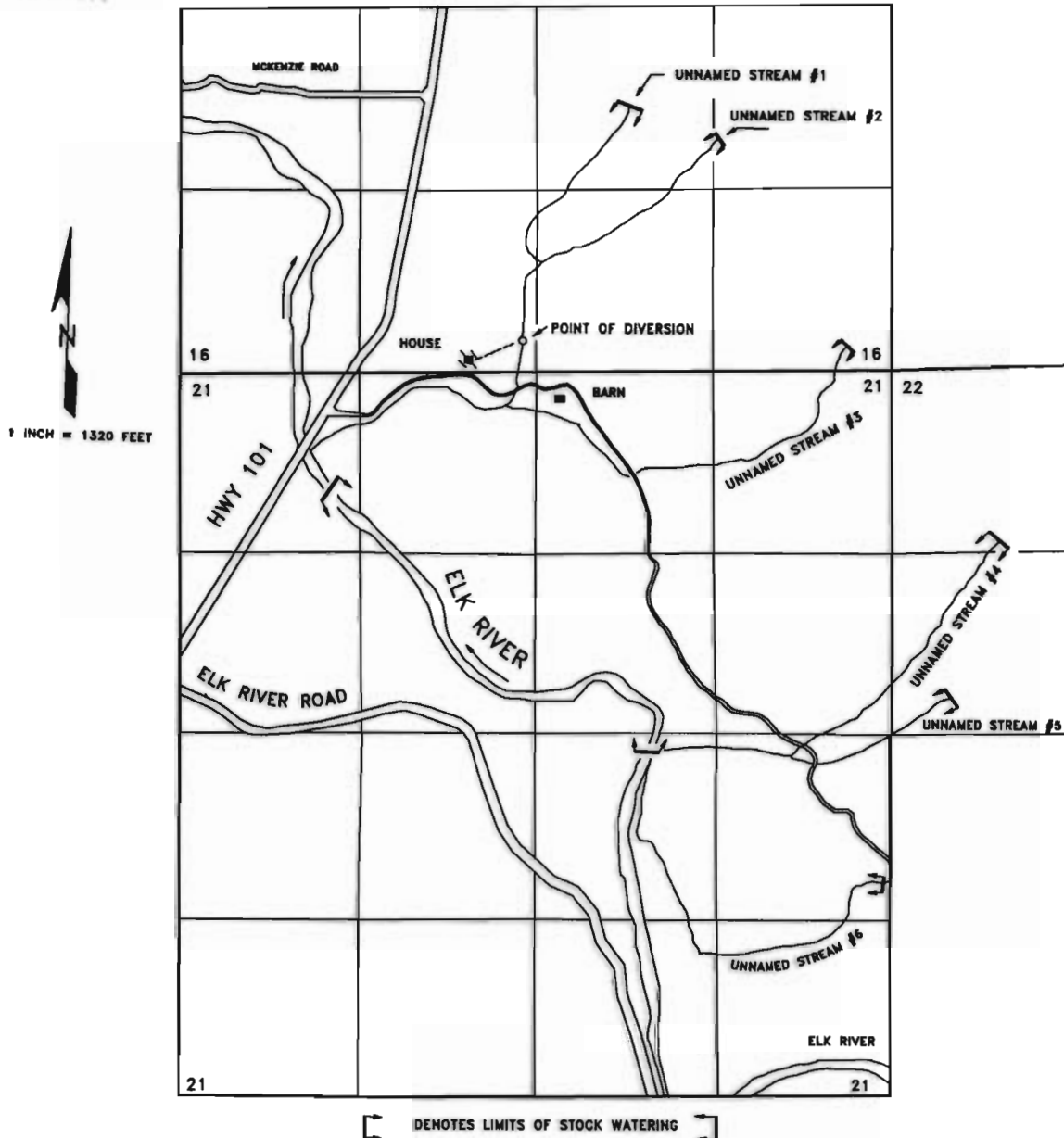

THE POINT OF DIVERSION FOR DOMESTIC USE IS LOCATED 220 FEET NORTH AND 2530 FEET EAST FROM THE NORTHWEST CORNER OF SECTION 21, BEING WITHIN THE SE¹/₄SW¹/₄ OF SECTION 16, TOWNSHIP 32 SOUTH, RANGE 15 WEST, W.M., COOS COUNTY.

STOCK WAS NORMALLY WATERED FROM THE NATURAL CREEK/RIVER CHANNEL AS DEPICTED ON THE MAP.

THE PURPOSE OF THIS MAP IS TO IDENTIFY THE LOCATION OF THE WATER RIGHT. IT IS NOT INTENDED TO PROVIDE INFORMATION RELATIVE TO THE LOCATION OF PROPERTY OWNERSHIP BOUNDARY LINES.

