

T. 29 S., R. 12 W.

Sections 28, 29, 32 + 33

Scale: 1" = 1320 ft.

Survey date: Apr. 24, 1993.

Map For a pre-1909 Surface Water Registration.

This map is not the result of a property survey and is not to be used as such.

For: Alan L. Laird, successor to Estate of Kenneth O. Laird.

Stockwatering Area shown: ( ) for 100 cows.

SWR. 289

A 1 h.p. motor lifts the water 40' and delivers 0.165 CFS for domestic use.

RECEIVED

APR 30 1993

WATER RESOURCES DEPT.  
SALEM, OREGON

RECEIVED

OCT 26 1993

WATER RESOURCES DEPT.  
SALEM, OREGON

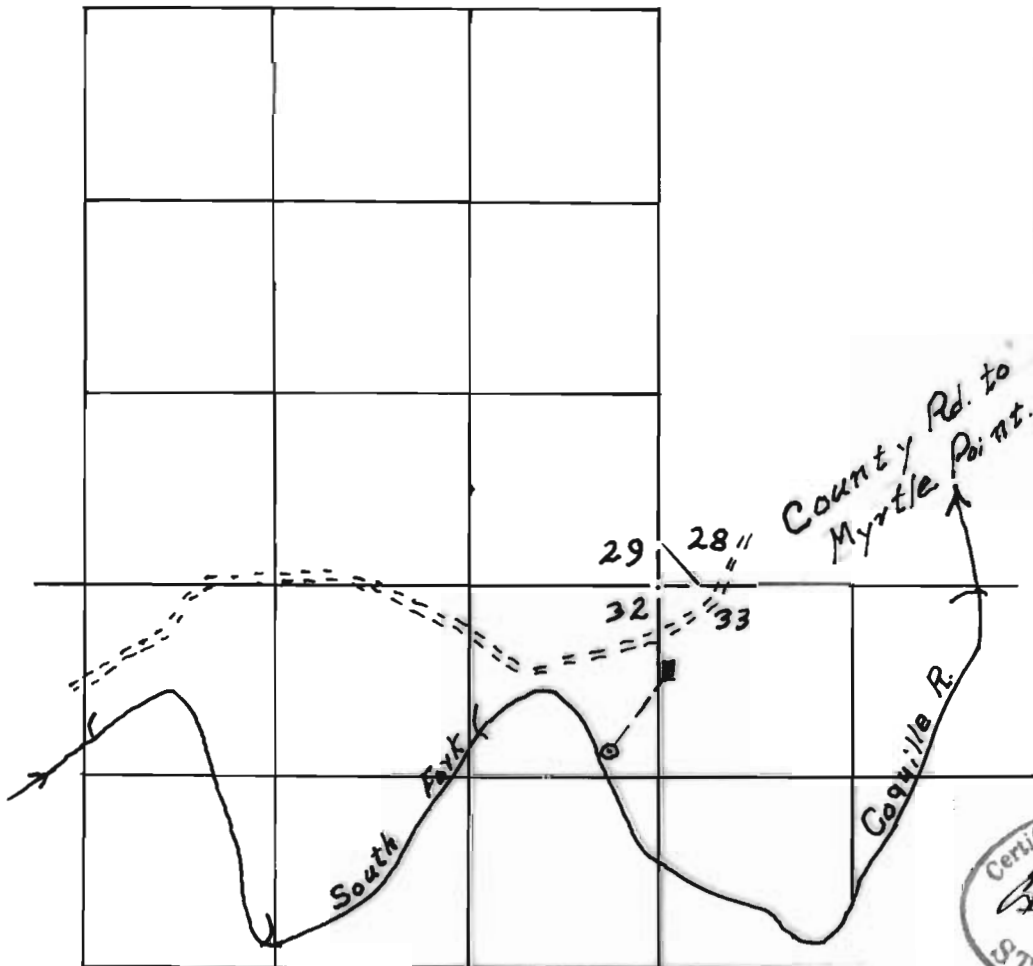

P.O.D. is 1128 ft. S +  
300 ft. W. of Sec Cor.

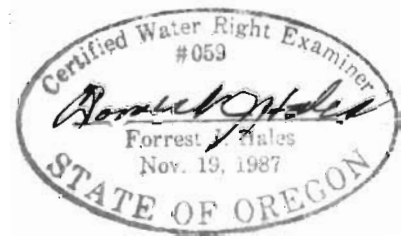

10-18-93