

# T.7S. R.IW.W.M.

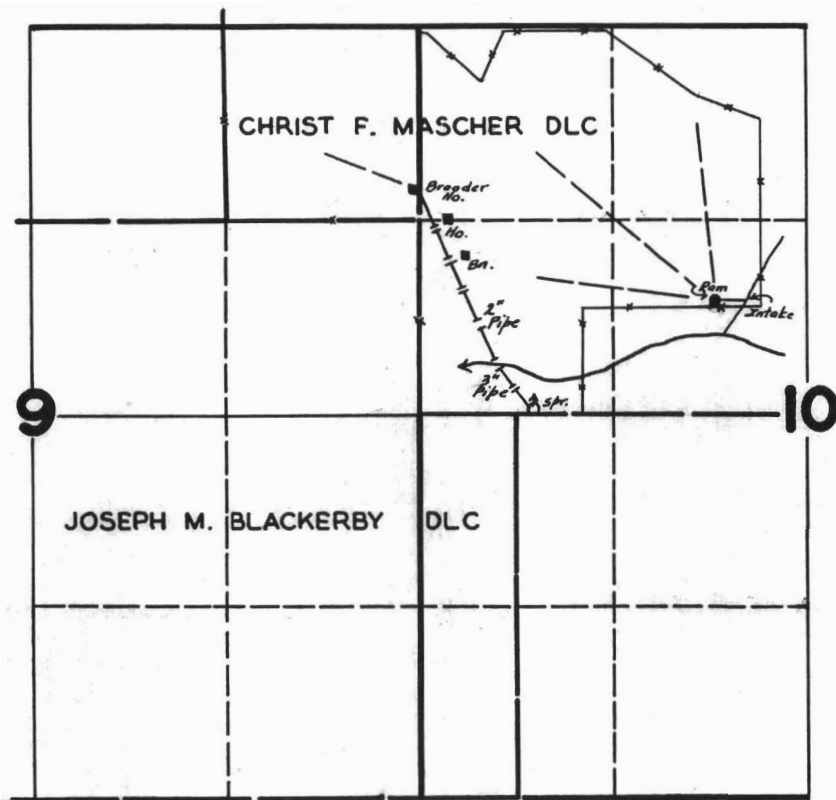

## FINAL PROOF SURVEY UNDER

Application No. 19867 Permit No. 15444

IN NAME OF  
R. STADELI

Surveyed DEC. 16, 1944 by [Signature]

~~APPLICATION  
INDICATES  
CONSTRUCTION OF  
WELL NOT  
FINISHED  
IN 1943~~

RECEIVED

APR 01 1991

WATER RESOURCES DEPT  
SALEM, OREGON

T.7S. R.1W. W.M.

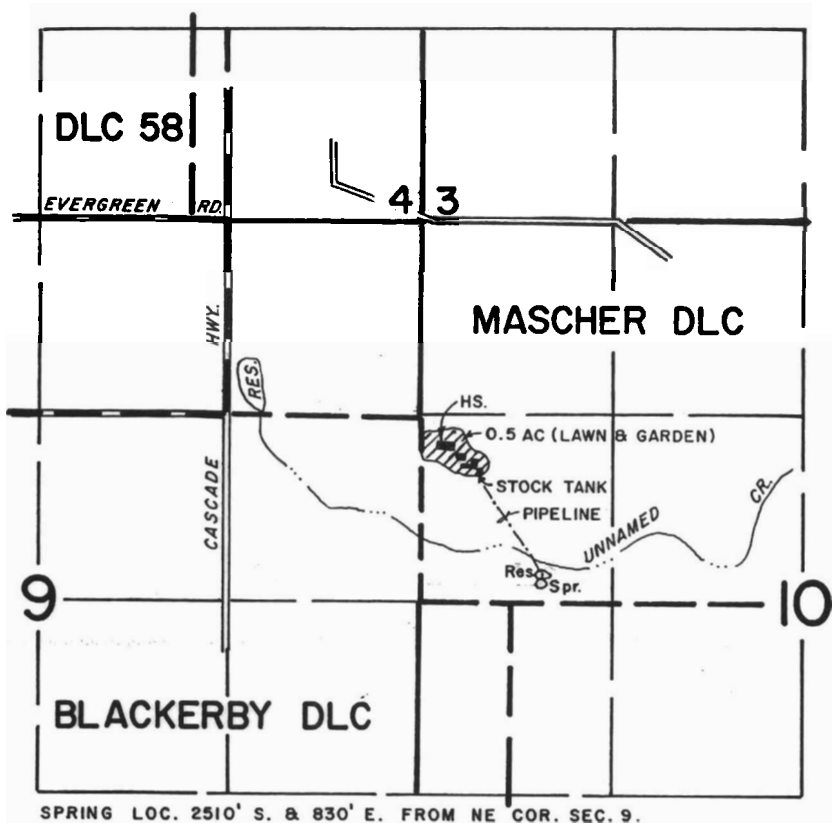
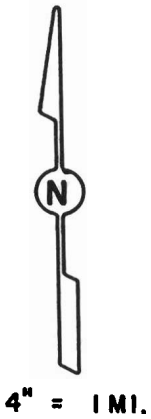

WATER RIGHT MAP FOR  
WALTER KLOPFENSTEIN

SURVEYED ON FEBRUARY 5, 1991

BY :

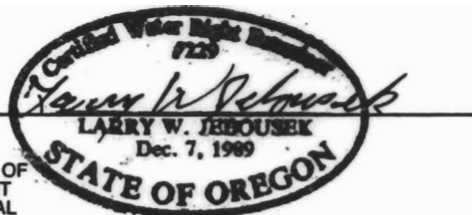

THIS MAP WAS PREPARED FOR THE PURPOSE OF IDENTIFYING THE LOCATION OF A WATER RIGHT ONLY AND IS NOT INTENDED TO PROVIDE LEGAL DIMENSIONS OR LOCATION OF PROPERTY OWNERSHIP LINES.

RECEIVED

T.7S. R.1W. W.M.

APR 01 1991

WATER RESOURCES DEPT  
SALEM, OREGON

SWR-29

BASIN Z-B



4" = 1 MI.

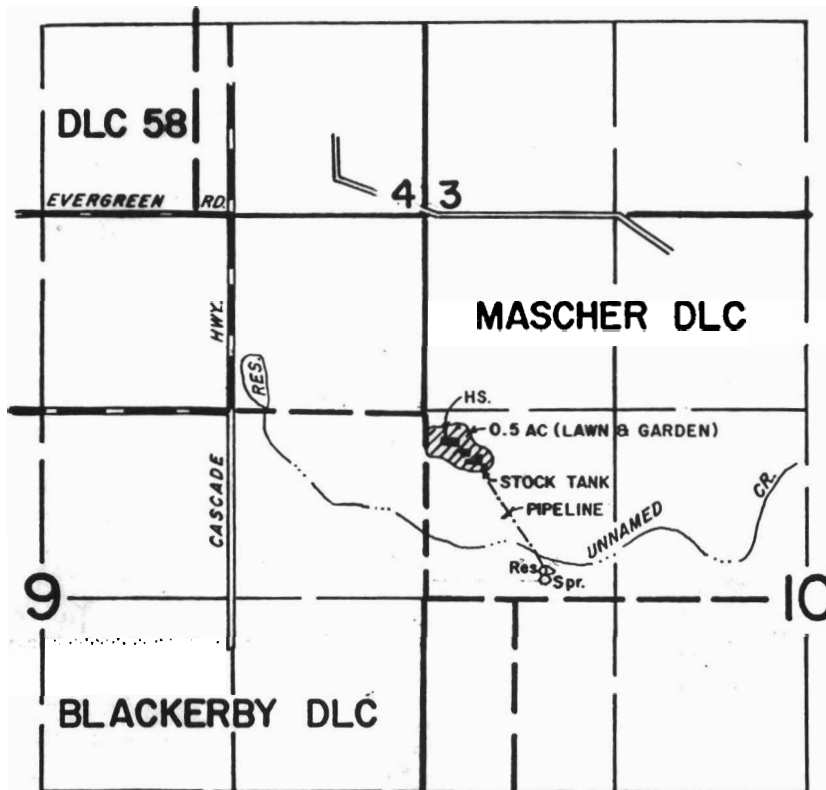

SPRING LOC. 2510' S. & 830' E. FROM NE COR. SEC. 9.

WATER RIGHT MAP FOR  
WALTER KLOPFENSTEIN

SURVEYED ON FEBRUARY 5, 1991

BY:



THIS MAP WAS PREPARED FOR THE PURPOSE OF IDENTIFYING THE LOCATION OF A WATER RIGHT ONLY AND IS NOT INTENDED TO PROVIDE LEGAL DIMENSIONS OR LOCATION OF PROPERTY OWNERSHIP LINES.