

T27S, R2W, WM

SCALE 1" = 1320'
COUNTY OF DOUGLAS

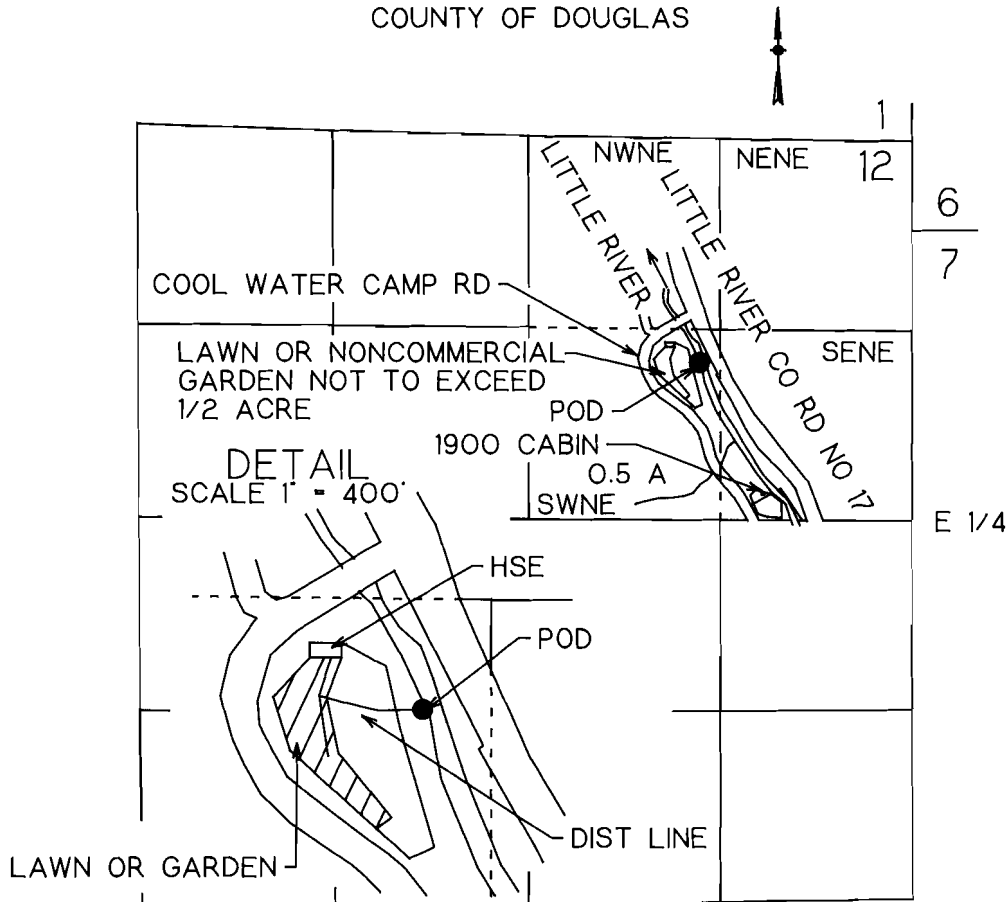

POD IS 1090 FT N AND 1460 FT W FROM E 1/4 COR SEC 12

VESTED WATER RIGHT MAP

PRE-1909 CLAIM OF BENEFICIAL USE

THIS IS A LOCATION MAP FOR A VESTED WATER RIGHT BY JAMES L OR KAREN HAZLETT. THIS MAP IS FOR THE PURPOSE OF IDENTIFYING THE LOCATION OF THE VESTED WATER RIGHT ONLY AND IS NOT INTENDED TO PROVIDE LEGAL DIMENSIONS OR LOCATIONS OF PROPERTY OWNERSHIP LINES.



EXPIRES 12-31-95