

N

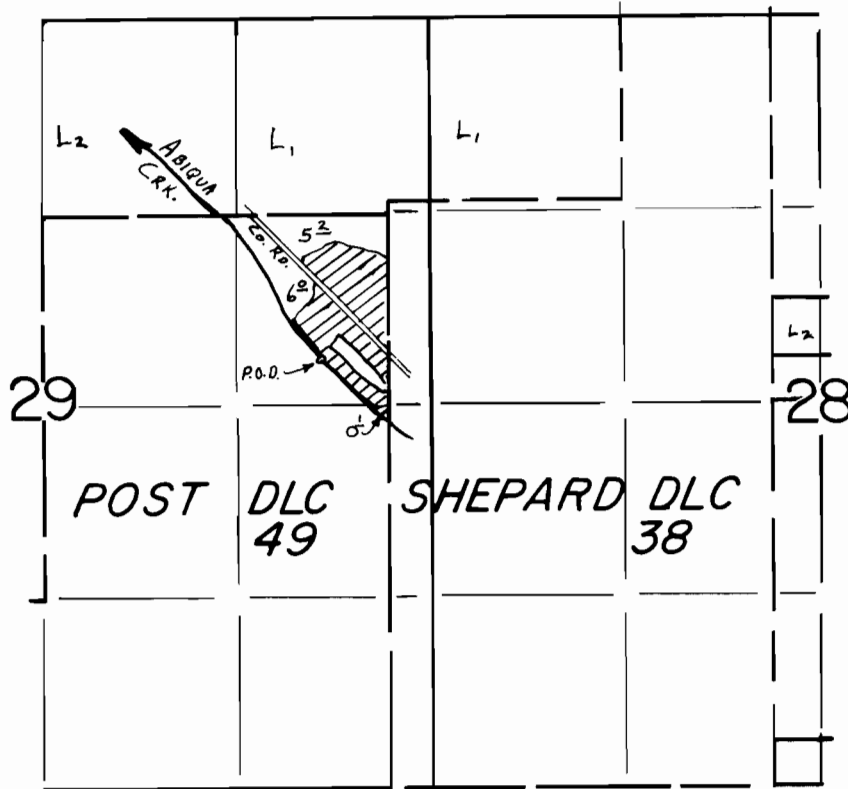

T. 6 S., R. 1 E., W. M.

Scale : 1" = 1320'



P.O.D. Loc. : 1070' S. & 460' W. from NE Cor. Post DLC 49

THIS MAP WAS PREPARED SOLELY FOR THE PURPOSE OF DEPICTING THE LOCATION OF A WATER RIGHT, AND HAS NO INTENTION OF BEING USED TO DETERMINE REAL PROPERTY BOUNDARIES.

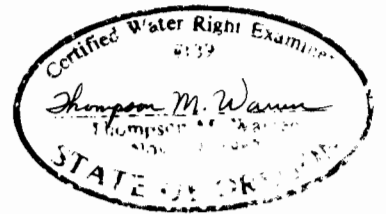

SITE MAP FOR SWR CLAIM # 322

IN THE NAME OF

ARTHUR C. & ANN BEESLEY