

TOWNSHIP 17 SOUTH, RANGE 7 WEST, W.M.

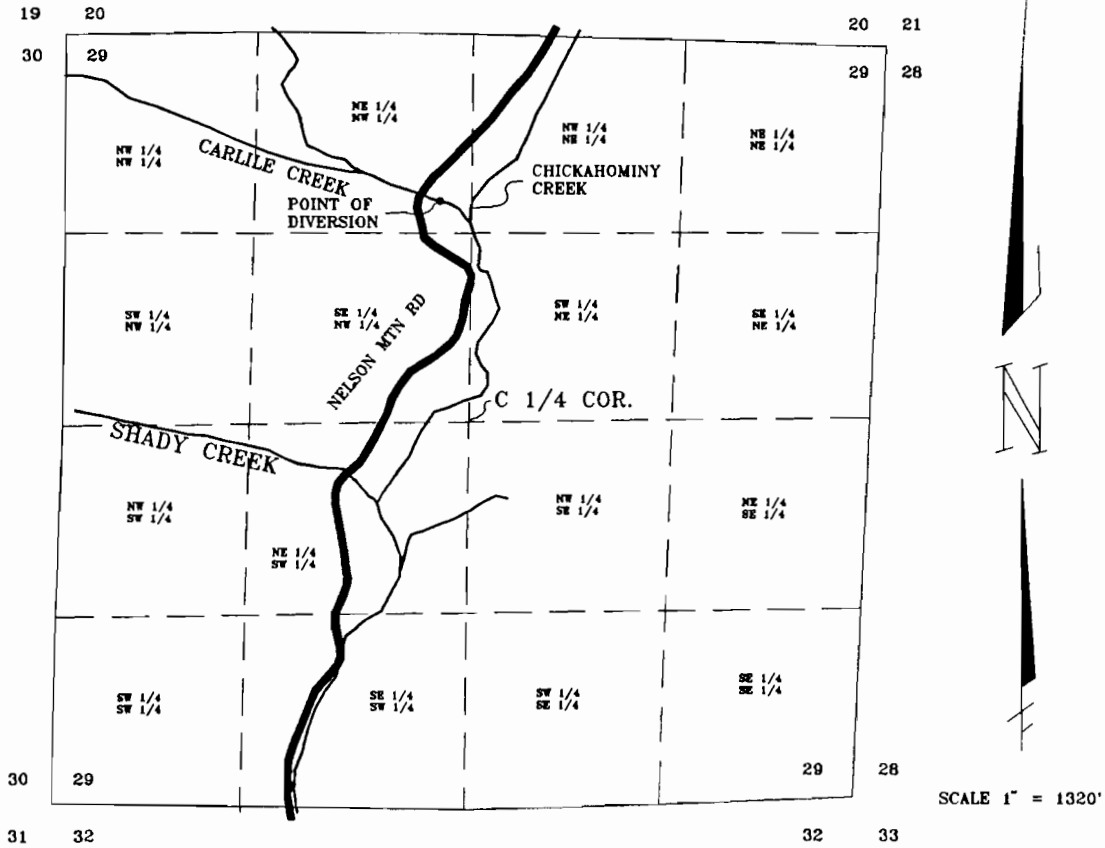

POINT OF DIVERSION:
 N 6° 53' 24" W 1514.25'
 FROM THE CENTER 1/4
 OF SECTION 29.

FINAL PROOF SURVEY
 PRE 1909 WATER RIGHT MAP
 DOMESTIC USE
 FOR
 LORILYNN IMBLER
 88875 NELSON MOUNTAIN ROAD
 WALTON, OR 97490
 PH (503)935-4074
 BY
 STEPHEN H. FORD INC.
 1120 BAILEY HILL RD #5
 EUGENE OR, 97403
 PH (503)344-1852

NOTE:
 THIS MAP WAS PREPARED FOR THE
 PURPOSE OF IDENTIFYING THE LOCATION
 OF THE WATER RIGHT ONLY. IT IS NOT
 INTENDED TO PROVIDE DIMENSIONS
 OR LOCATION OF PROPERTY OWNERSHIP LINES.

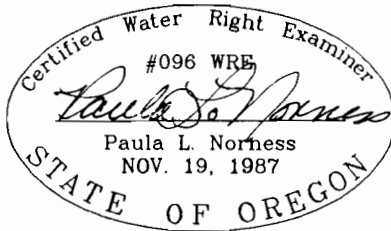

JOB NO. 2826 & 2828.1
 ACAD NO. W2626