

T. 17 S., R. 1 & 2 W., W.M.

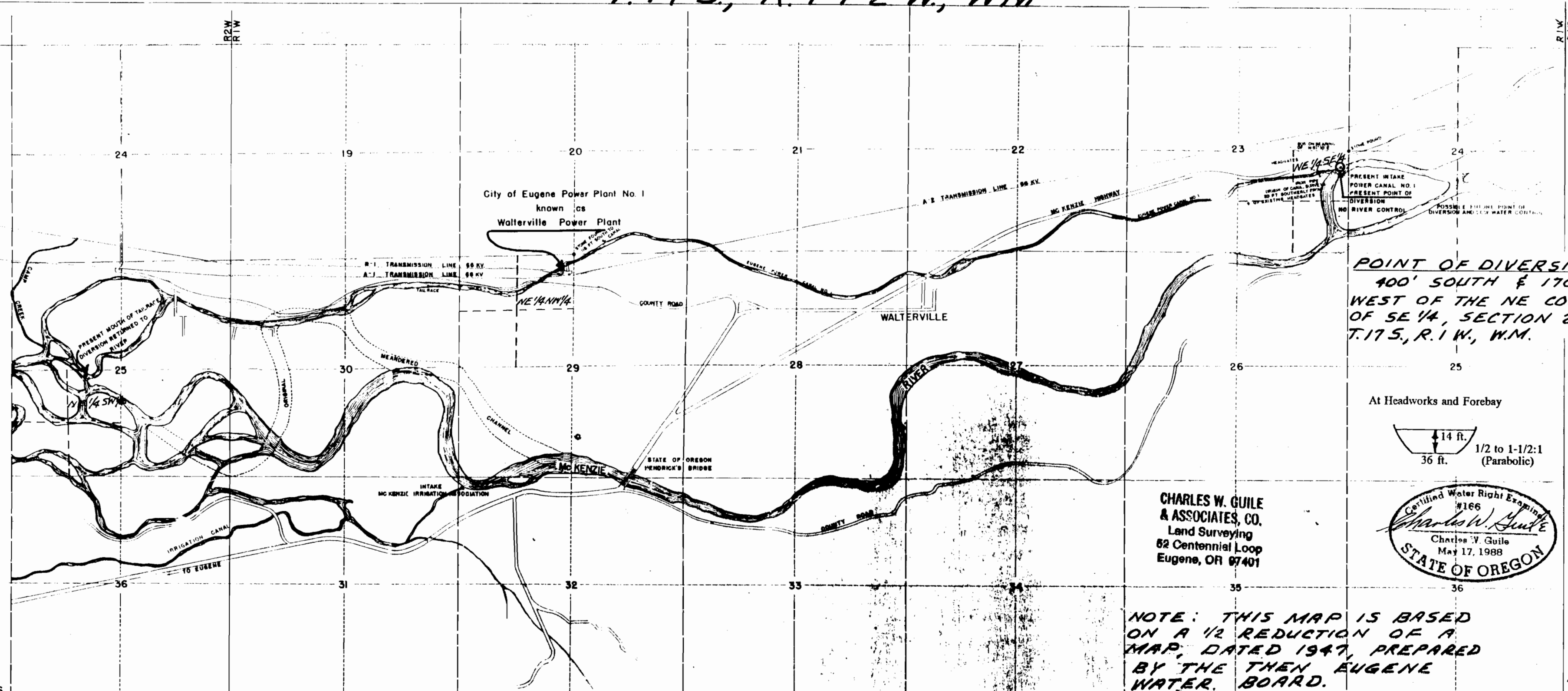

**POINT OF DIVERSION:**  
 400' SOUTH & 170'  
 WEST OF THE NE COR.  
 OF SE 1/4, SECTION 23,  
 T. 17 S., R. 1 W., W.M.

At Headworks and Forebay  
 14 ft.  
 36 ft.  
 1/2 to 1-1/2:1  
 (Parabolic)

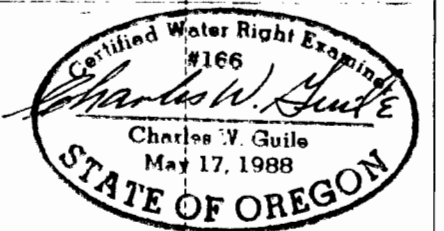

CHARLES W. GUILLE  
 & ASSOCIATES, CO.  
 Land Surveying  
 62 Centennial Loop  
 Eugene, OR 97401

NOTE: THIS MAP IS BASED  
 ON A 1/2 REDUCTION OF A  
 MAP, DATED 1947, PREPARED  
 BY THE THEN EUGENE  
 WATER BOARD.

SCALE  
 1" = 2000'

THIS MAP IS FOR WATER  
 RIGHT PURPOSES ONLY AND  
 DOES NOT PROVIDE DATA TO  
 LOCATE PROPERTY BOUNDARIES.

PREPARED FROM RECORDS.

WATER RIGHT APPLICATION  
 MAP FOR  
**EUGENE WATER & ELECTRIC BOARD**  
 LANE COUNTY, OREGON  
 DECEMBER 29, 1992

I, THE BOARDS OF EUGENE, OREGON, DO HEREBY CERTIFY  
 THAT THIS MAP WAS MADE UNDER MY SUPERVISION FROM NOTES,  
 SURVEY AND AERIAL PHOTOGRAPHS DATED FROM 1987 TO THE  
 PRESENT AND ON FILE IN THE OFFICE OF THE EUGENE WATER  
 BOARD AND THAT IT CORRECTLY REPRESENTS THE WORKS  
 DESCRIBED IN THE ACCOMPANYING APPLICATION, TOGETHER WITH  
 THE LOCATION OF STREAMS AND OTHER DIVIDES IN THE  
 IMMEDIATE VICINITY.

*[Signature]*  
 REGISTERED PROFESSIONAL ENGINEER  
 SUPERINTENDENT EUGENE WATER BOARD  
 OREGON NO. 1895  
 DATE OF REGISTRATION 8-8-1988

EUGENE WATER BOARD EUGENE OREGON	
MAP OF WALTERVILLE PROJECT APPLICATION FOR ADDITIONAL WATER RIGHTS	
SCALE DRAWN BY MSM APPROVED	DATE - 5-9-92 DATE

-1140  
 D-1140  
 92-89 B