

T29S R5W WM

27

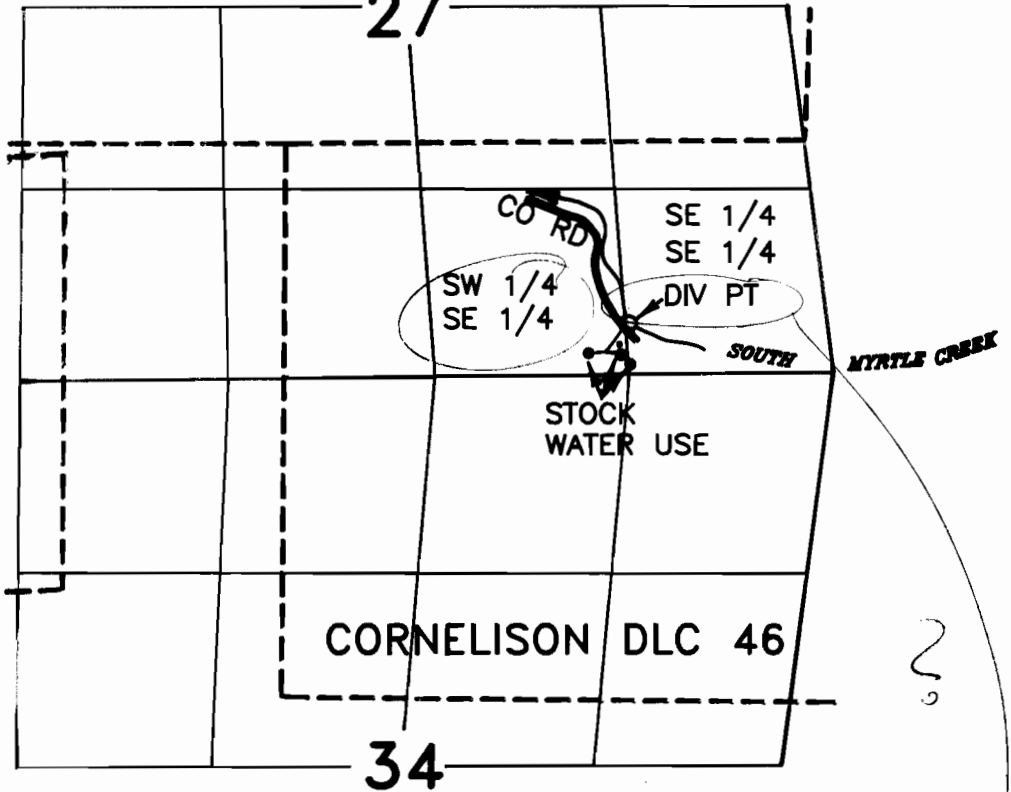

MAP BASED ON FINAL PROOF SURVEY FOR PERMIT No. 38433

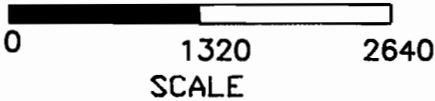

PRESENT DIVERSION POINT
PER PERMIT 38433
480 FT. N. & 1500 FT. W. FROM
THE SE CORNER OF SECTION 27

SURVEY FOR VESTED RIGHT IN NAME OF *Elmira A. Robinson*

DATE NOVEMBER 25, 1990

BY: WILLIAM J. RUPPERT
P.O. BOX 1564
MYRTLE CREEK, OR 97457

SWR-36