

CLAIM OF BENEFICIAL USE MAP  
 IN THE NAME OF J.A. DAVENPORT  
 FILE # SWR- 383  
 SECTIONS 19, 20 T29S, R12W, W.M.

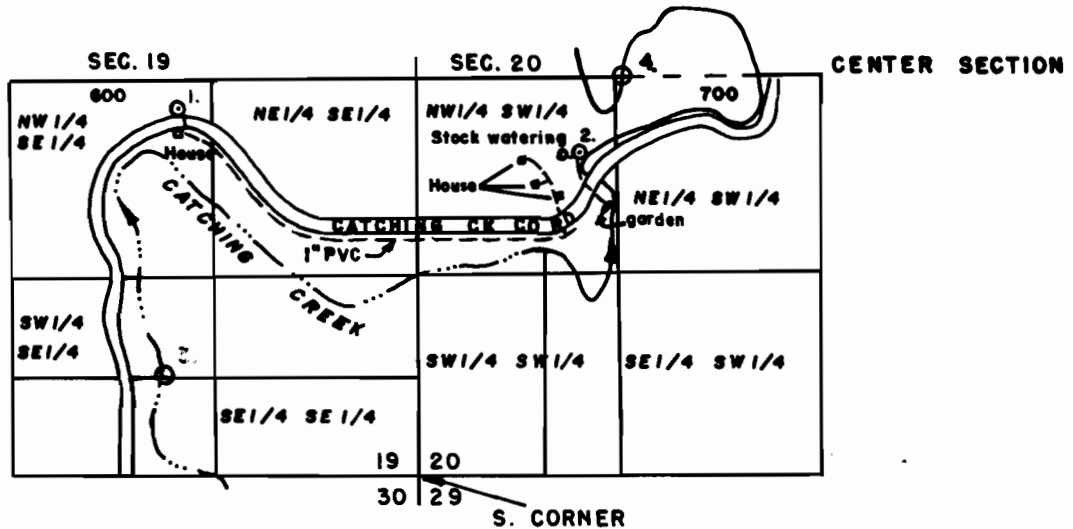

Scale: 1" = 1320'

Point of diversion 1 is located N 85° 35' E a distance of 4133' from the center section.

Point of diversion 2 is located N 68° 59' E a distance of 1687' from the center section.

Point of Stream Entry Onto Property

3. N 69° 08' W 1863' from the S corner between sections 19 & 20.

Point of Stream Exit From Property

4. S 89° 58' W 1360' from the Center section, sec. 20

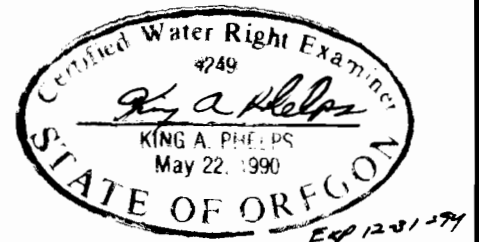

THE PURPOSE OF THIS MAP IS TO IDENTIFY THE LOCATION OF THE WATER RIGHT. IT IS NOT INTENDED TO PROVIDE INFORMATION RELATIVE TO THE LOCATION OF PROPERTY OWNERSHIP BOUNDARY LINES.