

**REGISTRATION STATEMENT MAP
PRE-1909 VESTED WATER RIGHT CLAIM
IN THE NAME OF JACK L. OR EVELYN M. SMITH**

SECTIONS 25 & 26, TOWNSHIP 30 SOUTH, RANGE 15 WEST, W.M.

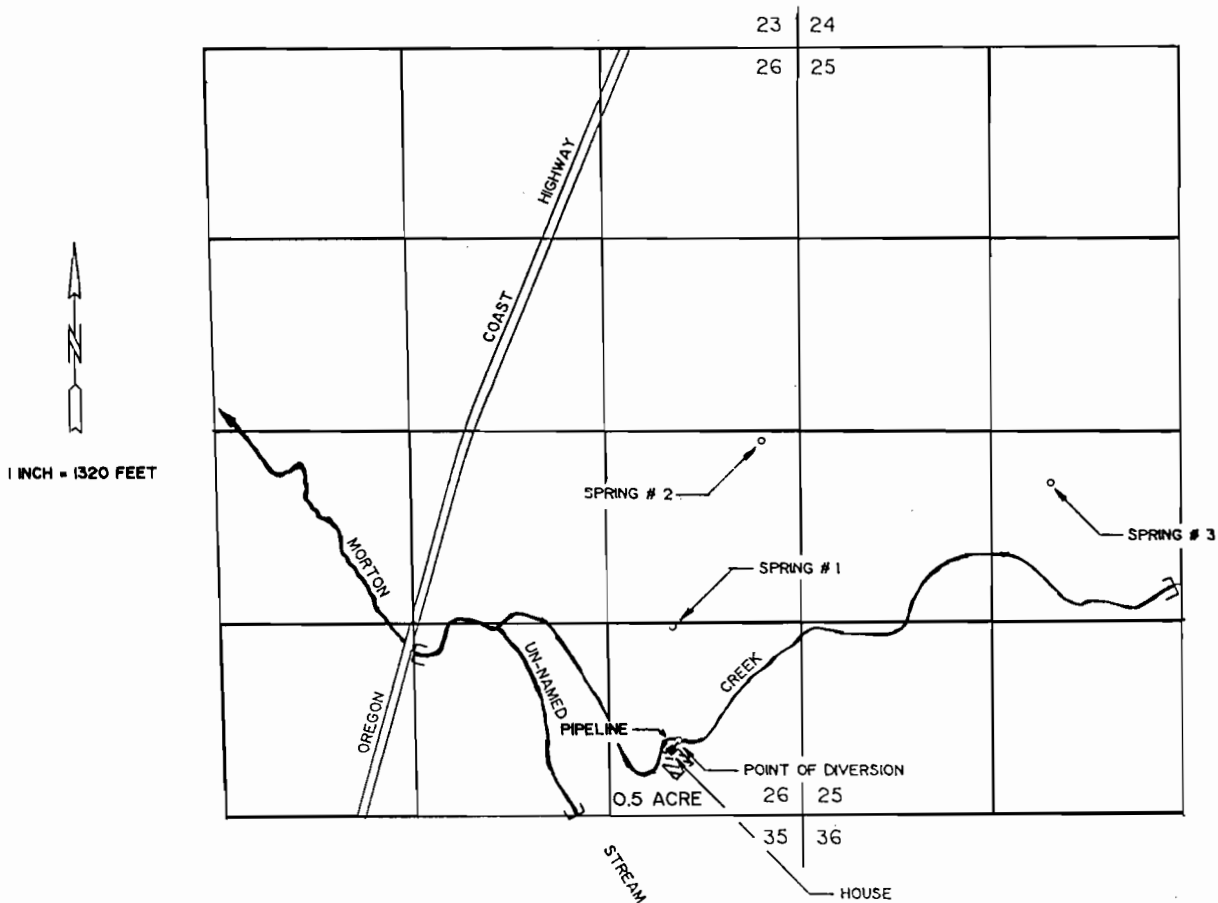

STOCKWATERING LIMITS

THE POINT OF DIVERSION IS LOCATED 520 FEET NORTH AND 850 FEET WEST FROM THE SOUTHEAST CORNER OF SECTION 26, BEING WITHIN THE SE 1/4 OF THE SE 1/4 OF SECTION 26, TOWNSHIP 30 SOUTH, RANGE 15 WEST, W.M., CURRY COUNTY.

THE PURPOSE OF THIS MAP IS TO IDENTIFY THE LOCATION OF THE WATER RIGHT. IT IS NOT INTENDED TO PROVIDE INFORMATION RELATIVE TO THE LOCATION OF PROPERTY OWNERSHIP BOUNDARY LINES.

