

REGISTRATION STATEMENT MAP  
 PRE-1909 VESTED WATER RIGHT CLAIM  
 IN THE NAME OF DORIS L. WADSWORTH  
 SECTIONS 26 & 27, T 27 S, R 5 W, W.M.

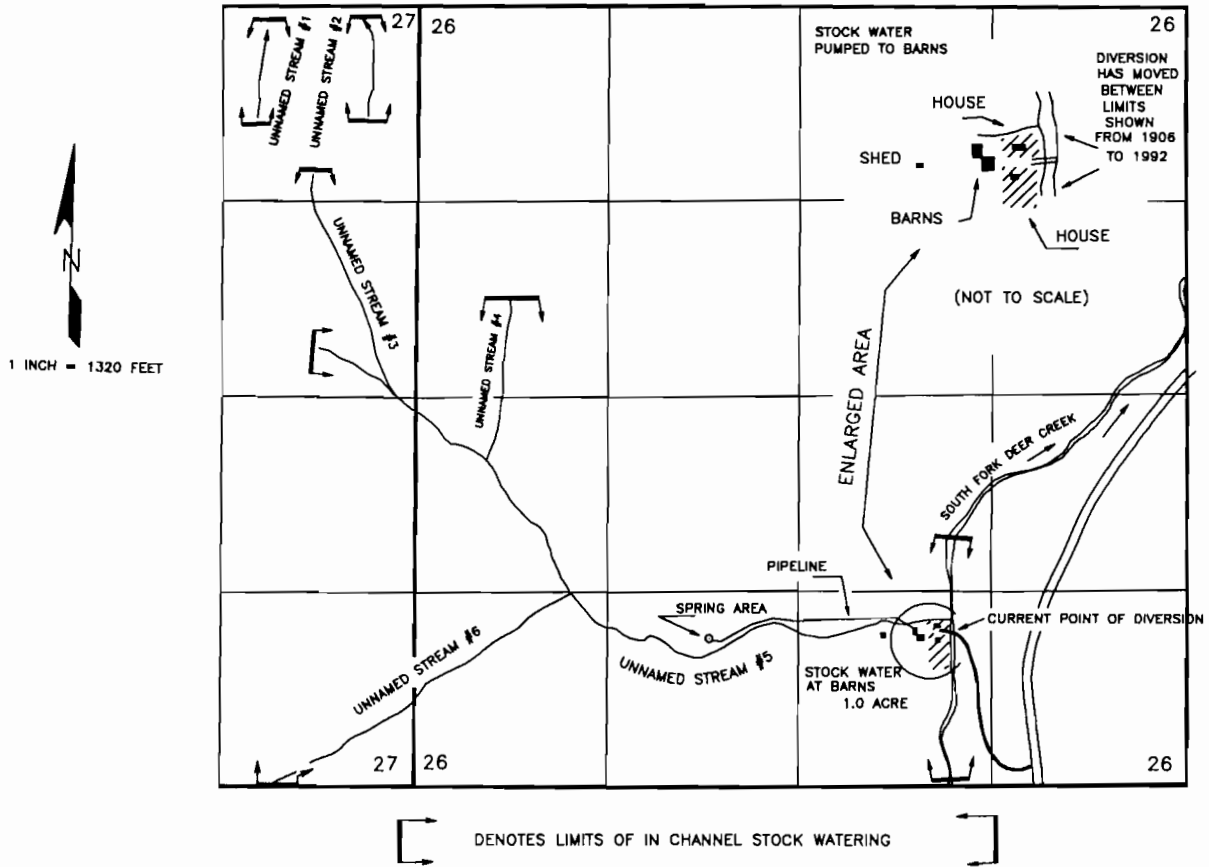

THE POINT OF DIVERSION FROM SOUTH FORK DEER CREEK IS LOCATED 1070 FEET NORTH AND 1620 FEET WEST FROM THE SOUTHEAST CORNER OF SECTION 26, BEING WITHIN THE SW $\frac{1}{4}$ SE $\frac{1}{4}$  OF SECTION 26, TOWNSHIP 27 SOUTH, RANGE 5 WEST, W.M., BEING WITHIN DOUGLAS COUNTY.

THE POINT OF DIVERSION FROM THE SPRING AREA IS LOCATED 1000 FEET NORTH AND 3280 FEET WEST FROM THE SOUTHEAST CORNER OF SECTION 26, BEING WITHIN THE SE $\frac{1}{4}$ SW $\frac{1}{4}$  OF SECTION 26, TOWNSHIP 27 SOUTH, RANGE 5 WEST, W.M., BEING WITHIN DOUGLAS COUNTY.

THE PURPOSE OF THIS MAP IS TO IDENTIFY THE LOCATION OF THE WATER RIGHT. IT IS NOT INTENDED TO PROVIDE INFORMATION RELATIVE TO THE LOCATION OF PROPERTY OWNERSHIP BOUNDARY LINES.

*James H. ...*