

HISTORICAL RECORDS OF DEVELOPMENT:

SECTION	FORTY	1882 GLO SURVEY	HOMESTEAD PATENT	WATER CLAIMED	1992 IRRIGATED ACRES	SUCCOR CR.	CARTER CR.
28	NWSW	FIELD	1890	1890	0.7		
28	SWSW		1890	1890	13.0		
29	SESE		1890	1890	28.1	10.0	
29	SWSE		1916		2.3	1.4	
29	NESE	FIELD	1890	1890	35.0		
29	NWSE		1890	1890	26.2		

123.7 ACRES TOTAL

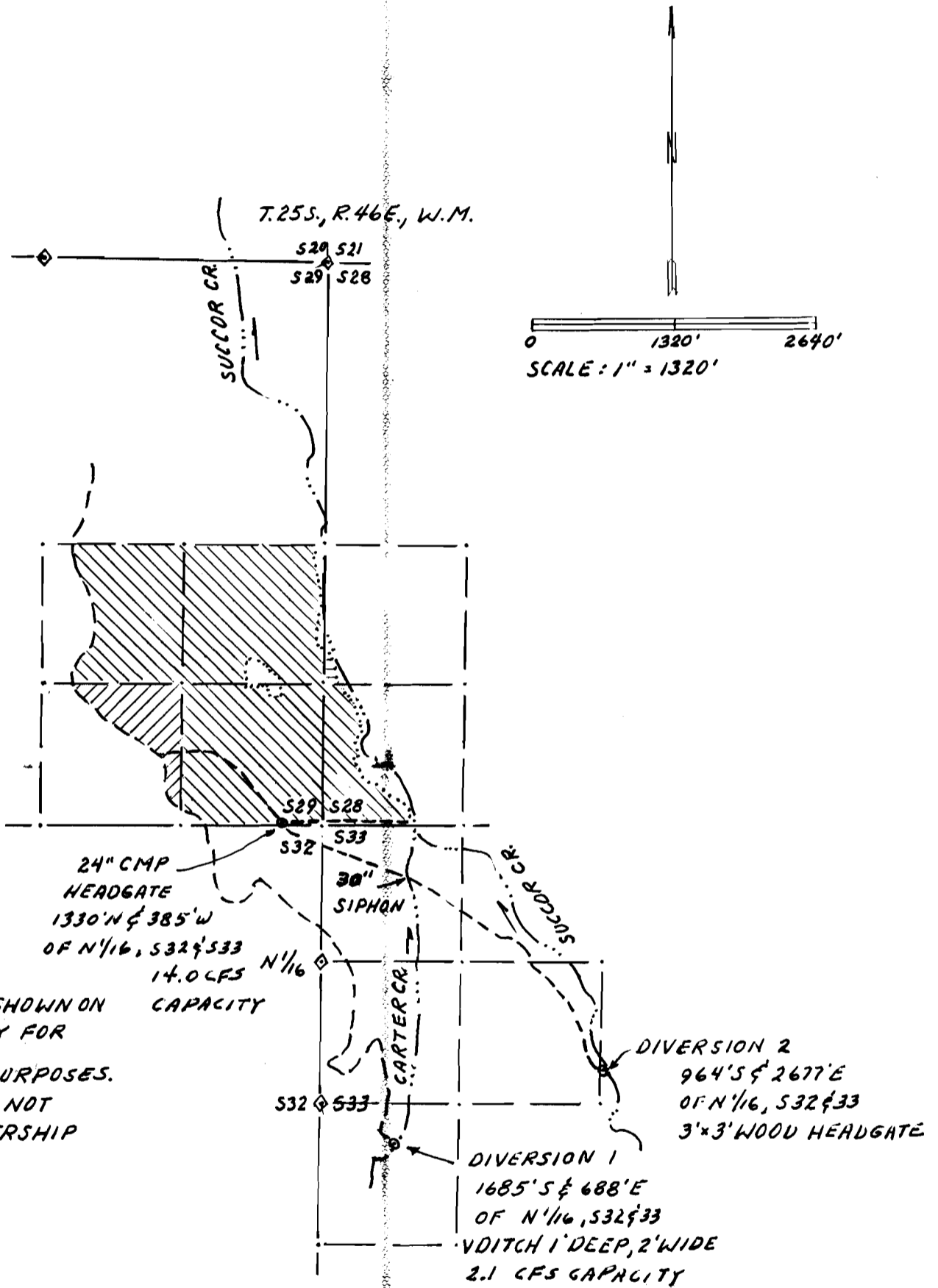

NOTE:
THE INFORMATION SHOWN ON
THIS MAP IS SOLELY FOR
WATER RIGHTS PURPOSES.
DATA SHOWN DOES NOT
REPRESENT OWNERSHIP
INFORMATION.

OWNER:

JOANNE STITZEL
3241 STITZEL ROAD
JORDAN VALLEY, OR 97910
(503) 586-2428

SURVEY BY: DAVID L. HADDOCK
DATE: OCT. TO DEC. 1992
56 NE MT. HEBRON
PENDLETON, OR 97801

