

SECTIONS 4,8,9,17 & 18
 TWSP. 26 SOUTH, RANGE 46 EAST, W.M.
 TAX LOT No. 26-46-900,1000,1100 & 1600.

SECTIONS 32 & 33
 TWSP. 25 SOUTH, RANGE 46 EAST, W.M.
 TAX LOT No. 25-46-101,600 & 800.

DIVERSION POINT TABLE

DIVERSION POINT	SEC., Twp., Range	40 LOCATION	FROM GOV'T. CORNER	DISTANCE
No. 1	SEC.18-T26S-R46E	NW1/4SE1/4	E1/4 COR. SEC.18	1073'S. & 1800'W.
No. 2	SEC.18-T26S-R46E	SE1/4NE1/4	E1/4 COR. SEC.18	166'N. & 371'W.
No. 3	SEC.8-T26S-R46E	NW1/4SE1/4	SE COR. SEC. 8	1766'N. & 2434'W.
No. 4	SEC.9-T26S-R46E	SW1/4SW1/4	SW COR. SEC. 9	1170'N. & 198'E.
No. 5	SEC.9-T26S-R46E	SW1/4SW1/4	SW COR. SEC. 9	1231'N. & 145'E.
No. 6	SEC.9-T26S-R46E	SW1/4SW1/4	SW COR. SEC. 9	1038'N. & 100'E.
No. 7	SEC.9-T26S-R46E	NW1/4NW1/4	NW COR. SEC. 9	676'S. & 0'E.
No. 8	SEC.9-T26S-R46E	NW1/4NW1/4	NW COR. SEC. 9	693'S. & 30'E.
No. 9	SEC.33-T25S-R46E	SW1/4SW1/4	W1/4 COR. SEC. 33	1816'S. & 211'E.
No. 10	SEC.33-T25S-R46E	NW1/4SW1/4	W1/4 COR. SEC. 33	980'S. & 419'E.
No. 11	SEC.3-T26S-R46E	NE1/4SW1/4	W1/4 COR. SEC. 3	215'S. & 1957'E.
No. 12	SEC.3-T26S-R46E	NW1/4SE1/4	W1/4 COR. SEC. 3	1065'S & 3115'E.

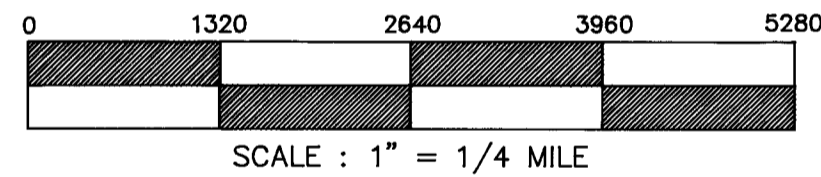
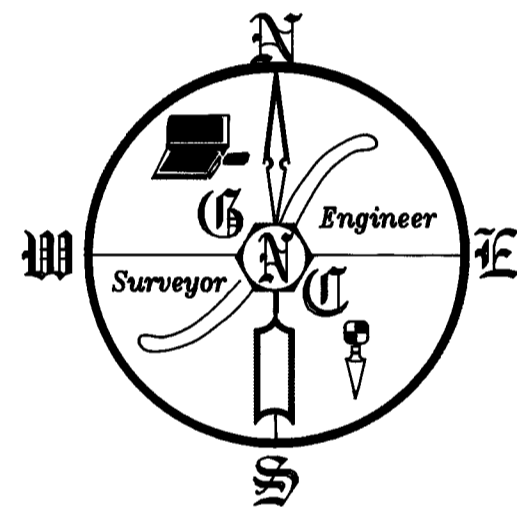

DISCLAIMER
 I, ALBERT GASCHLER, HEREBY CERTIFY: THAT THIS MAP WAS MADE TO BE A PART OF REGISTRATION STATEMENT CLAIMING A RIGHT TO APPROPRIATE SURFACE WATER. SECTIONAL LINES SHOWN ARE APPROXIMATE AND THIS MAP IS NOT INTENDED FOR ANY OTHER USE AND DOES NOT GUARANTEE LAND OWNERSHIP.

APPLICATION No.:

PERMIT No.:

EXISTING PERMITS :

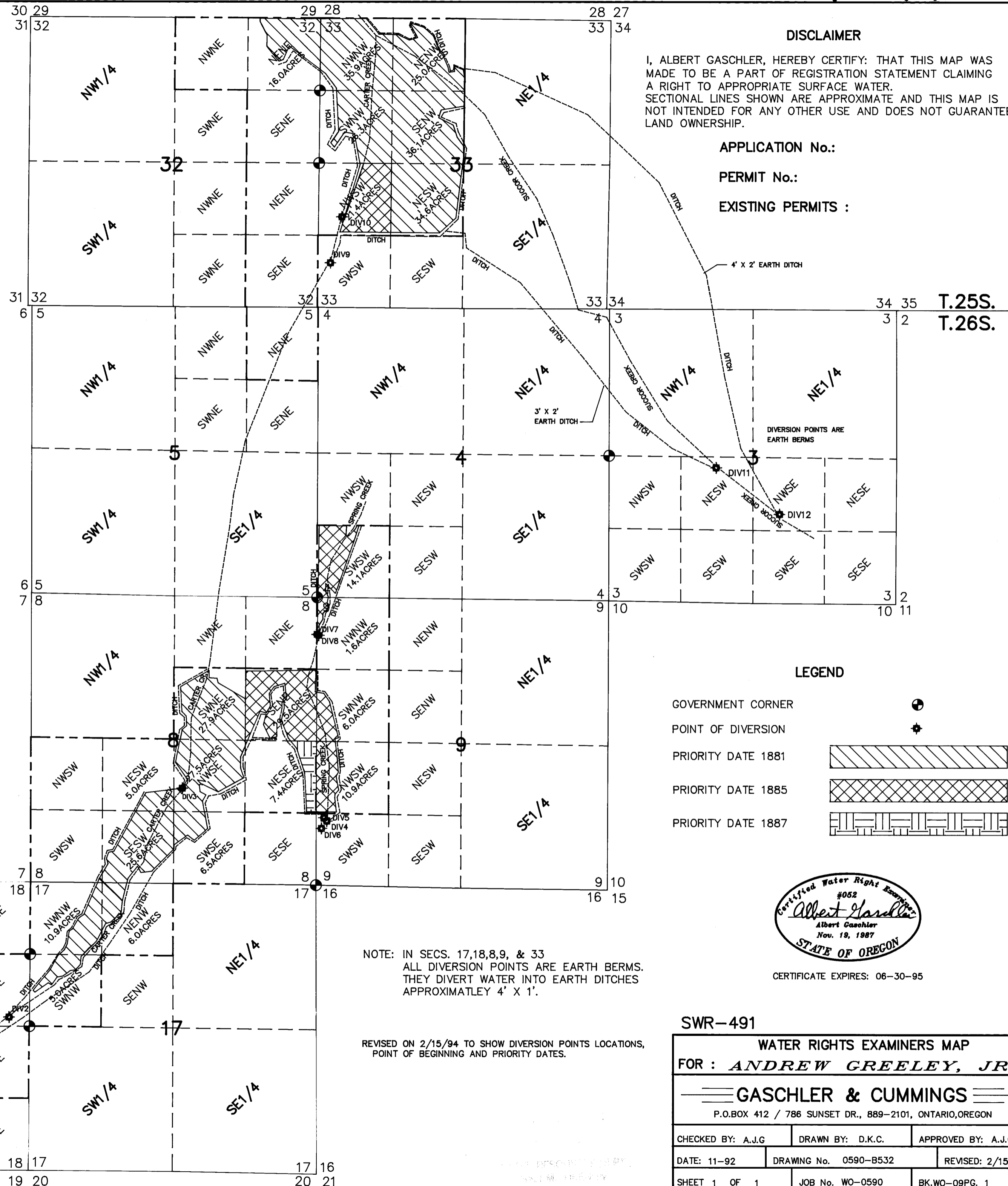

T.25S.
 T.26S.

LEGEND

- GOVERNMENT CORNER
- POINT OF DIVERSION
- PRIORITY DATE 1881
- PRIORITY DATE 1885
- PRIORITY DATE 1887

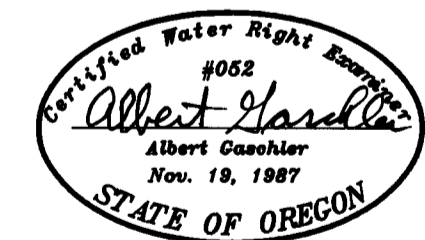

CERTIFICATE EXPIRES: 06-30-95

NOTE: IN SECS. 17,18,8,9, & 33
 ALL DIVERSION POINTS ARE EARTH BERMS.
 THEY DIVERT WATER INTO EARTH DITCHES
 APPROXIMATELY 4' X 1'.

REVISED ON 2/15/94 TO SHOW DIVERSION POINTS LOCATIONS,
 POINT OF BEGINNING AND PRIORITY DATES.

SWR-491

WATER RIGHTS EXAMINERS MAP
 FOR : **ANDREW GREELEY, JR.**

GASCHLER & CUMMINGS
 P.O. BOX 412 / 786 SUNSET DR., 889-2101, ONTARIO, OREGON

CHECKED BY: A.J.G.	DRAWN BY: D.K.C.	APPROVED BY: A.J.G.
DATE: 11-92	DRAWING No. 0590-B532	REVISED: 2/15/94
SHEET 1 OF 1	JOB No. WO-0590	BK.WO-09PG. 1