

HISTORICAL RECORDS OF DEVELOPMENT:
SECTION FORTY 1882 GLO HOMESTEAD WATER CLAIMED 1889
SURVEY PATENT 1890
1992 IRRIGATED ACRES SUCCOR CREEK

16	SWNW	1890	1889	SPRING
	NWSW		1889	SPRING
17	SWSE	15.9		
20	NWNE	20.3		
	SWNE	9.4		
	NWSE	22.7		
	NESE	10.4		
	SWSE	29.3		
	SESE	27.5		
21	SWSW	0.4		
28	NWNW	4.0		
	SWNW	3.5		
29	NWNE	29.1	1891	
	NENE	30.5	1891	
	SWNE	25.8	1891	
	SENE	33.4	1891	
		262.2 ACRES		TOTAL

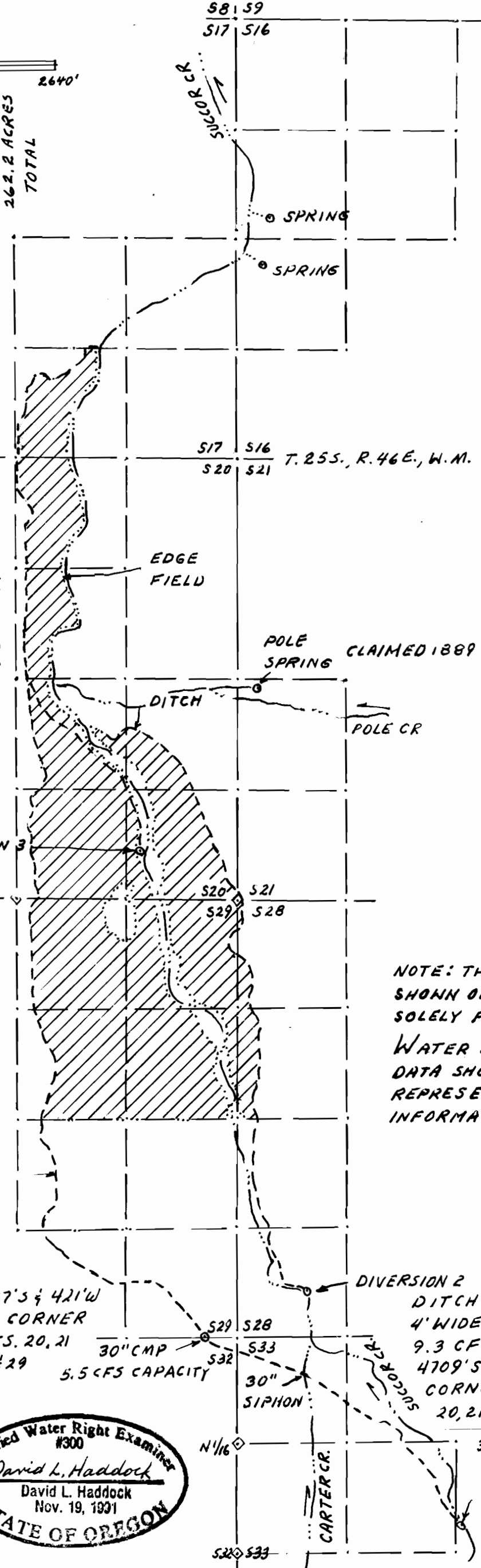
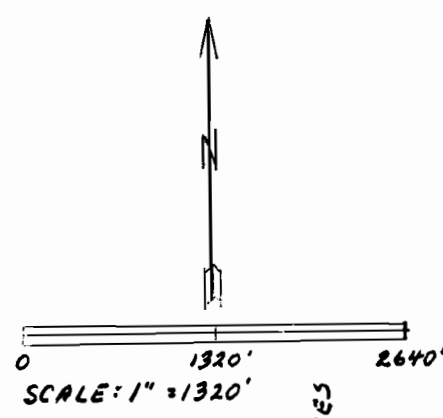

DIVERSION 3
DITCH - 1' BOTTOM, 3' TOP, 1' DEEP
563' N & 1131' W
OF CORNER
SECTIONS 20,
21, 28 & 29.
5.5 CFS
CAPACITY

5227'S & 421'W
OF CORNER
SECS. 20, 21
28 & 29
30" CMP
5.5 CFS CAPACITY

DIVERSION 2
DITCH - 2' BOTTOM,
4' WIDE, 1' DEEP
9.3 CFS CAPACITY
4709'S & 829'E OF
CORNER OF SECTIONS
20, 21, 28 & 29.

3'x3' WOOD
HEADGATE
DIVERSION 1
7521'S & 2641'E
OF CORNER TO
SECS. 10, 21, 28 & 29

NOTE: THE INFORMATION
SHOWN ON THIS MAP IS
SOLELY FOR
WATER RIGHTS PURPOSES.
DATA SHOWN DOES NOT
REPRESENT OWNERSHIP
INFORMATION.

OWNER:
MACKENZIE RANCHES
410 SUCCOR CR. ROAD
JORDAN VALLEY, OR 97910
(503) 339-3229

SURVEY BY: DAVID HADDOCK
DATE: OCT. TO DEC. 1992
56 NE MT. HEBRON
PENDLETON, OR 97801

