

RECEIVED

APR 14 1994

WATER RESOURCES DEPT.
SALEM, OREGON

SURFACE WATER REGISTRATION #528

**PHIL STRADER ESTATE
DYRMA STRADER ESTATE**

SECTIONS 8 & 9, TOWNSHIP 26 SOUTH, RANGE 3 WEST, W.M.



1 INCH = 1320 FEET

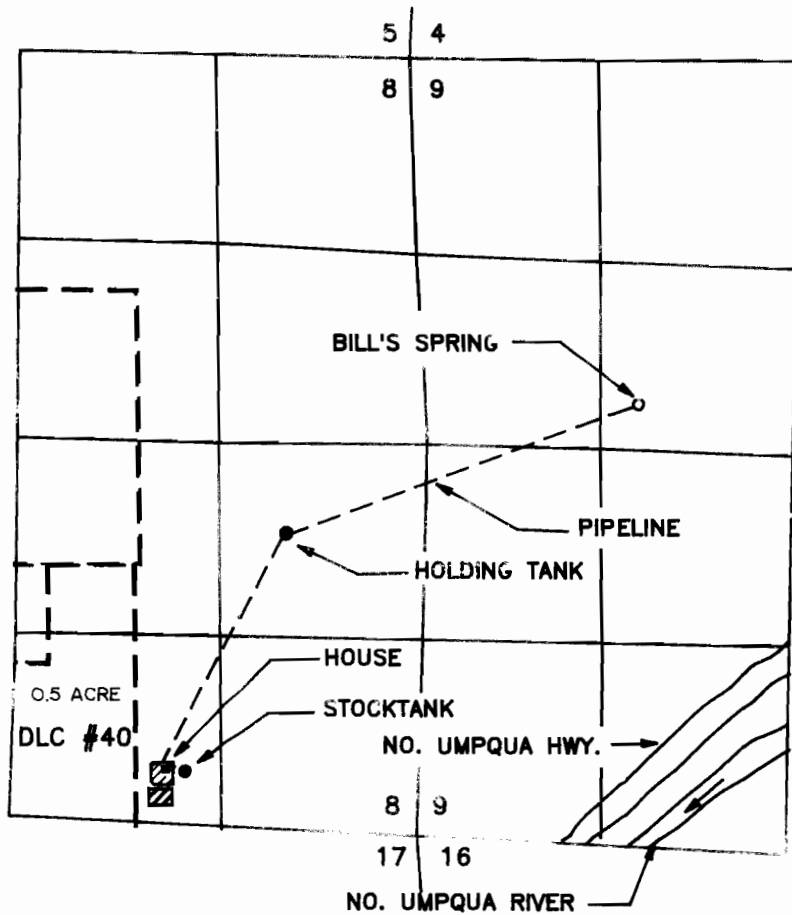

BILL'S SPRING IS LOCATED 2400 FEET SOUTH AND 1530 FEET EAST FROM THE NORTHWEST CORNER OF SECTION 9, BEING WITHIN THE SE 1/4 NW 1/4 OF SECTION 9, TOWNSHIP 26 SOUTH, RANGE 3 WEST, W.M., DOUGLAS COUNTY.

THE PURPOSE OF THIS MAP IS TO IDENTIFY THE LOCATION OF THE WATER RIGHT. IT IS NOT INTENDED TO PROVIDE INFORMATION RELATIVE TO THE LOCATION OF PROPERTY OWNERSHIP BOUNDARY LINES.

SWR-528