

PRE-190 VESTED WATER RIGHT

Section 27,28,33&34 Township 23S Range 12W W.M.
Coos County

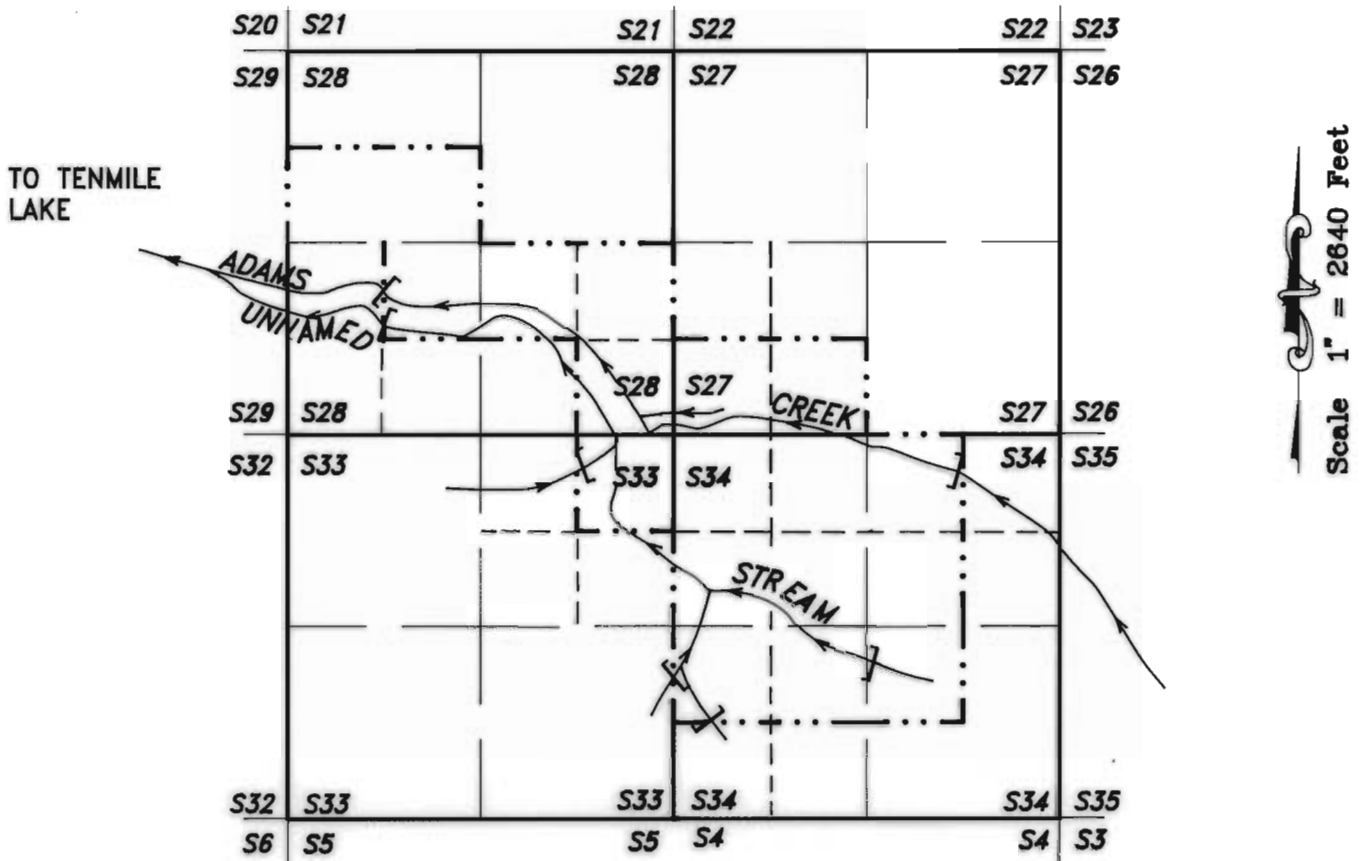

Legend

- - - - Property Line
- >>> Creek
- [] Stock Watering

RECEIVED

JUN 22 1993

WATER RESOURCES DEPT.
SALEM, OREGON

RECEIVED

JAN 14 1994

WATER RESOURCES DEPT.
SALEM, OREGON

NOTE:

The instream water use is entirely located on property owned by the applicant.

IN THE NAME OF
Jane Muffett

Surveyed on May 25, 1993 by H.A. Wilcox

EXAMINERS DISCLAIMER STATEMENT

The preparation of this map was for the purpose of identifying the location of the Water Right only and has no intent to provide dimensions or location of property ownership lines.



EXPIRES 12/31/94

SWR-540