

PRE-1900 VESTED WATER RIGHT

Section 2 Township 26S Range 12W W.M.

Section 35 Township 25S Range 12W W.M.

RECEIVED

AUG 10 1993

WATER RESOURCES DEPT.
SALEM OREGON

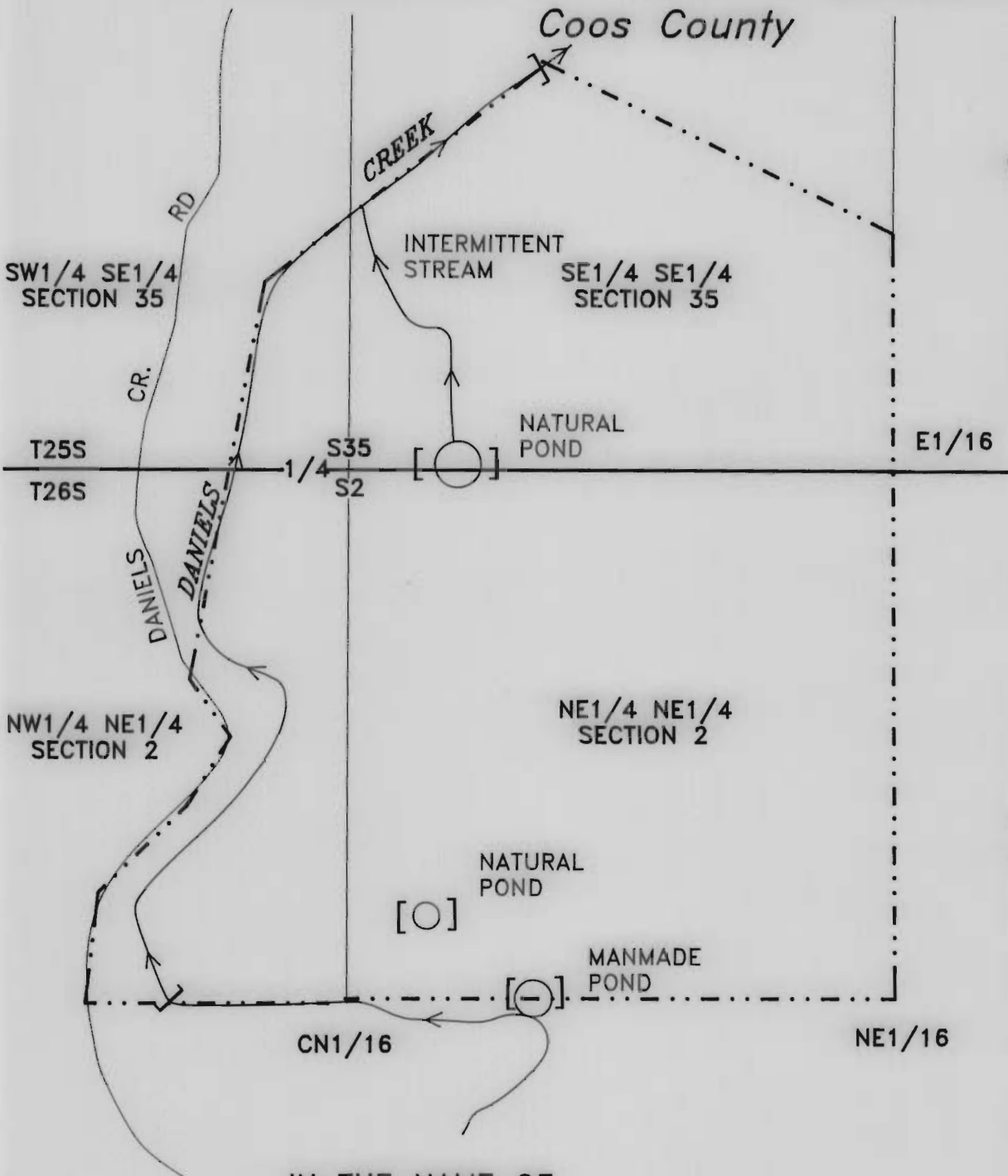
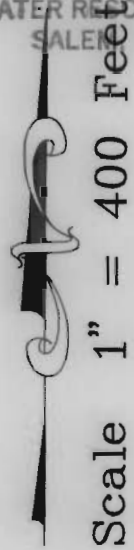

Legend

- - - - Property Line
- → Creek
- [] Stock Watering
- Pond

IN THE NAME OF

William and Doreen Wright

Surveyed on June 25, 1993 by H.A. Wilcox

EXAMINERS DISCLAIMER STATEMENT

The preparation of this map was for the purpose of identifying the location of the Water Right only and has no intent to provide dimensions or location of property ownership lines.

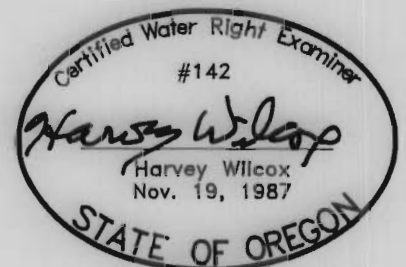

EXPIRES 12/31/94