

# PRE-190 VESTED WATER RIGHT

Section 4,5,8&9 Township 26S Range 12W W.M.  
Coos County

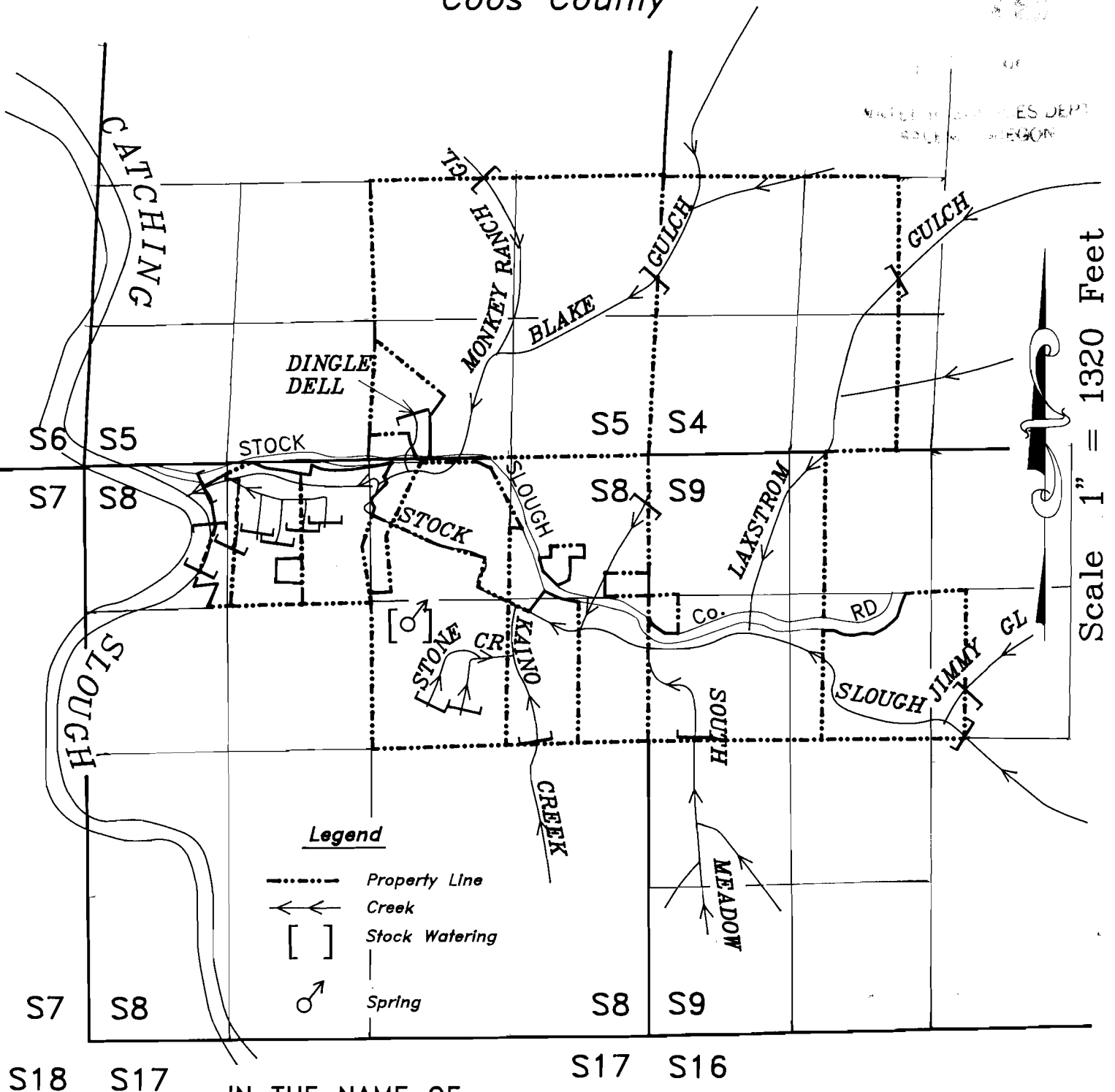

IN THE NAME OF

Stock Slough Livestock Producers Assoc.

Surveyed on May 28, 1993 by H.A. Wilcox

## EXAMINERS DISCLAIMER STATEMENT

The preparation of this map was for the purpose of identifying the location of the Water Right only and has no intent to provide dimensions or location of property ownership lines.

