

MAY 24 1993

WATER RESOURCES DEPT.  
SALEM, OREGON

17

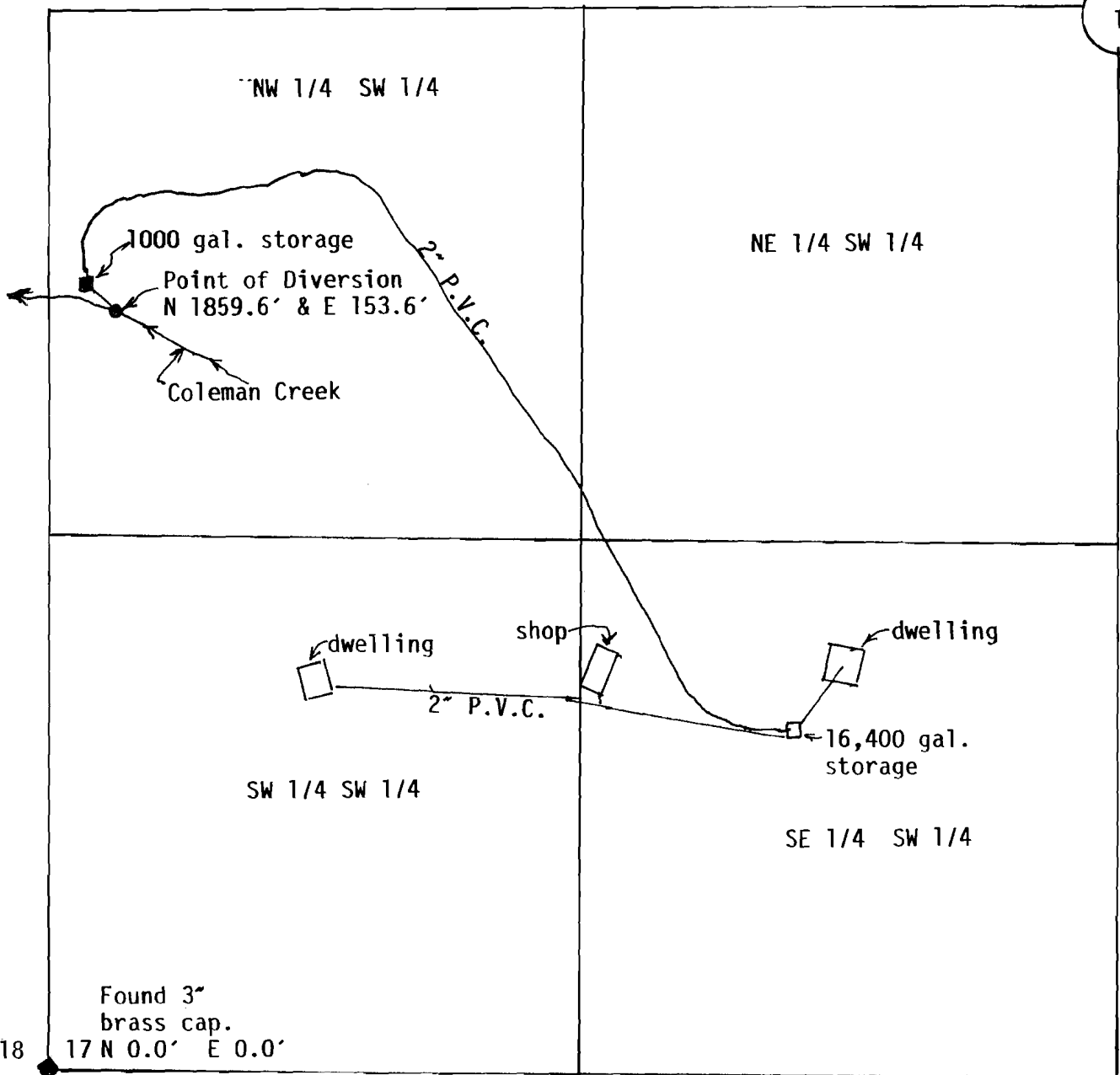

18  
19

Found 3"  
brass cap.  
17 N 0.0' E 0.0'

SCALE 1" = 400'

APPLICATION MAP  
for  
OCEANSIDE WATER DISTRICT  
MAY 19, 1993

APPLICATION No. \_\_\_\_\_

PERMIT No. \_\_\_\_\_

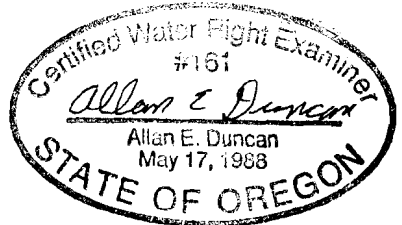

Expires 12-31-93

This map was prepared to locate the point of diversion and improvements, and not as a boundary survey.