

SWR-61

RECEIVED

MAR 02 1992
WATER RESOURCES DEPT
SALEM, OREGON

T. 38 & 39 S., R. 40 & 41 E.

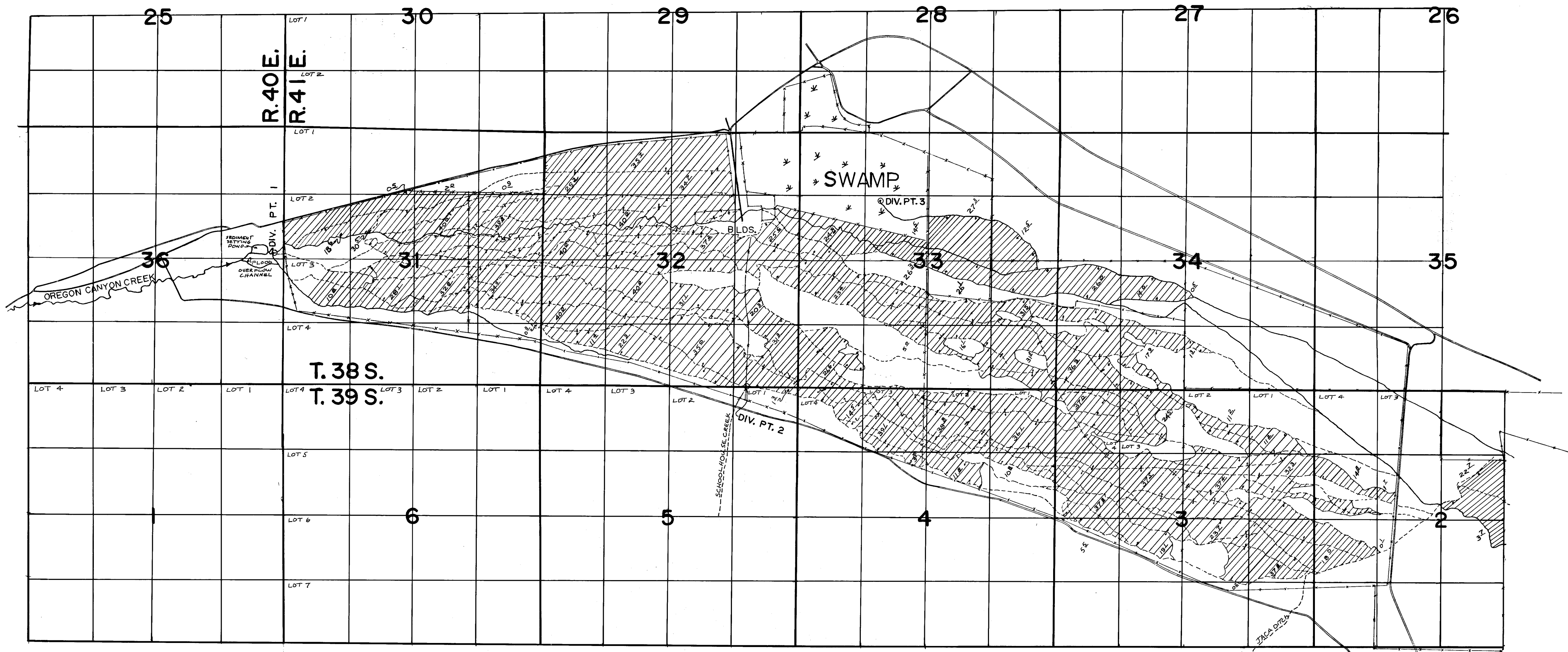

DIVERSION POINT LOCATIONS

PO.D. 1 - 2700' N & 200' W, FROM THE S.E. COR. SEC. 36, T. 38 S., R. 40 E.
 P.O.D. 2 - 25' N & 4260' E, FROM THE S.W. COR. SEC. 32, T. 38 S., R. 41 E.
 P.O.D. 3 - 1400' S & 1650' E, FROM THE N.W. COR. SEC. 33, T. 38 S., R. 41 E.

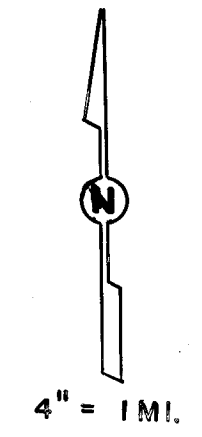

WATER RIGHT MAP FOR
 JOHN ECHAVE
 OREGON CANYON RANCH
 SURVEYED ON MAY 8-9, 1991
 BY: *Janey G. Selwick*

THIS MAP WAS PREPARED FOR THE PURPOSE OF IDENTIFYING THE LOCATION OF A WATER RIGHT ONLY AND IS NOT INTENDED TO PROVIDE LEGAL DIMENSIONS OR LOCATION OF PROPERTY OWNERSHIP LINES.

SWR-61