

T. 30 S., R. 14 W. W.M.

Map for a pre-1909 Surface Water Registration

Scale: 1" = 1320ft. Date of Survey Jan. 30, 1993.

This map is not the result of a property Survey and is not to be used as such.

For: Ray Waterman

Map 1 of 2.

All coordinates for this survey were measured from Soil and Water Conservation Dist. Aerial Photo Map dated Jan. 1989.

Four Mile Cr. is a tributary of Pacific Ocean.

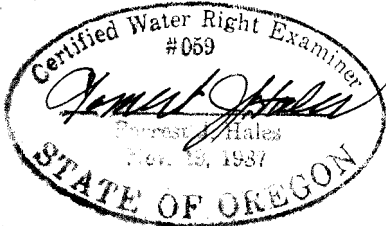
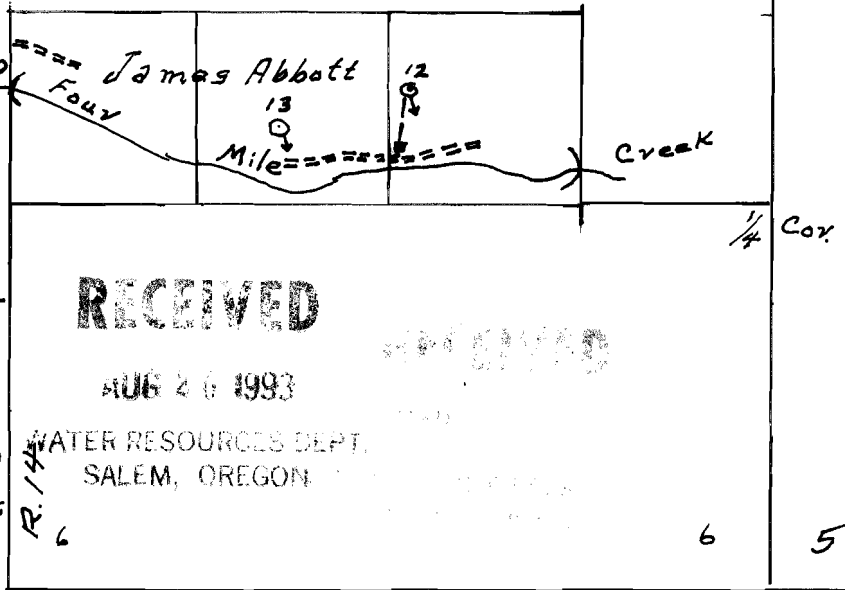

P.O.D.	In	Sec.	N-S Coords.	E-W Coords.	From
1	1/4 NESE	5	2508 N.	1214 W.	From Sec. 8 NE Cor. 8
2	SE SE	8	132 N.	264 W.	SE " 8
3	SE NE	17	1623 S	1056 W.	SE " 8
4	NE NW	17	818 S	3194 W.	SE " 8
5	NW NE	8	660 S.	1584 W.	NE " 8
6	SW SE	5	396 N	1438 W	NE " 8
7	SW SW	4	396 N	106 E	NE " 8
8	Stream bank stock watering from all streams flowing over Ray Waterman lands in Sections 9, 4, 5, 6, 7, 8 and 17 as shown on maps 1 and 2.				
9	NWNE	9	1056 S	287 E	NE Cor. 8
10	SW NE	9	1848 S	3854 E	NE " 8
11	NWNW	8	594 S	389 E	NW " 8
12	SW NE	6	3445 N	2508 W	NW " 8
13	SE NW	6	3049 N	3419 W	NW " 8

T. 30 S., R. 14 W. W. M.

Map 2 of 2.

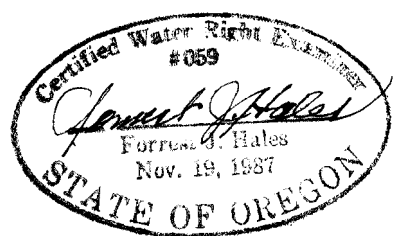
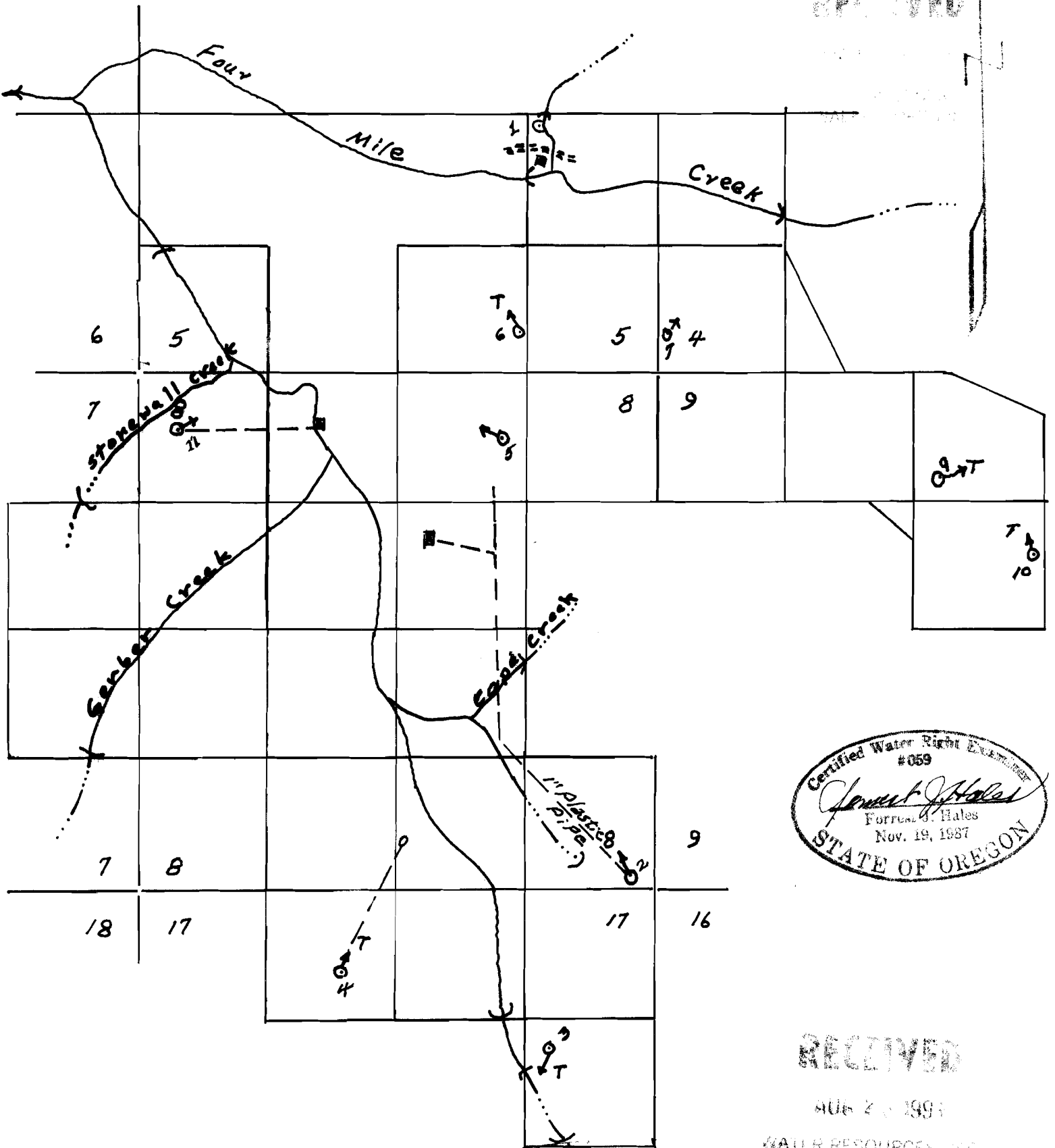

RECEIVED

AUG 20 1997
WATER RESOURCES DEPT
SALEM, OREGON