

REGISTRATION STATEMENT MAP
PRE-1909 VESTED WATER RIGHT CLAIM

IN THE NAME OF REGINA PIERSON

SECTIONS 28 & 29, T 26 S, R 12 W, W.M.

RECEIVED

MAR - 6 1999

WATER RESOURCES DEPT.
SALEM, OREGON

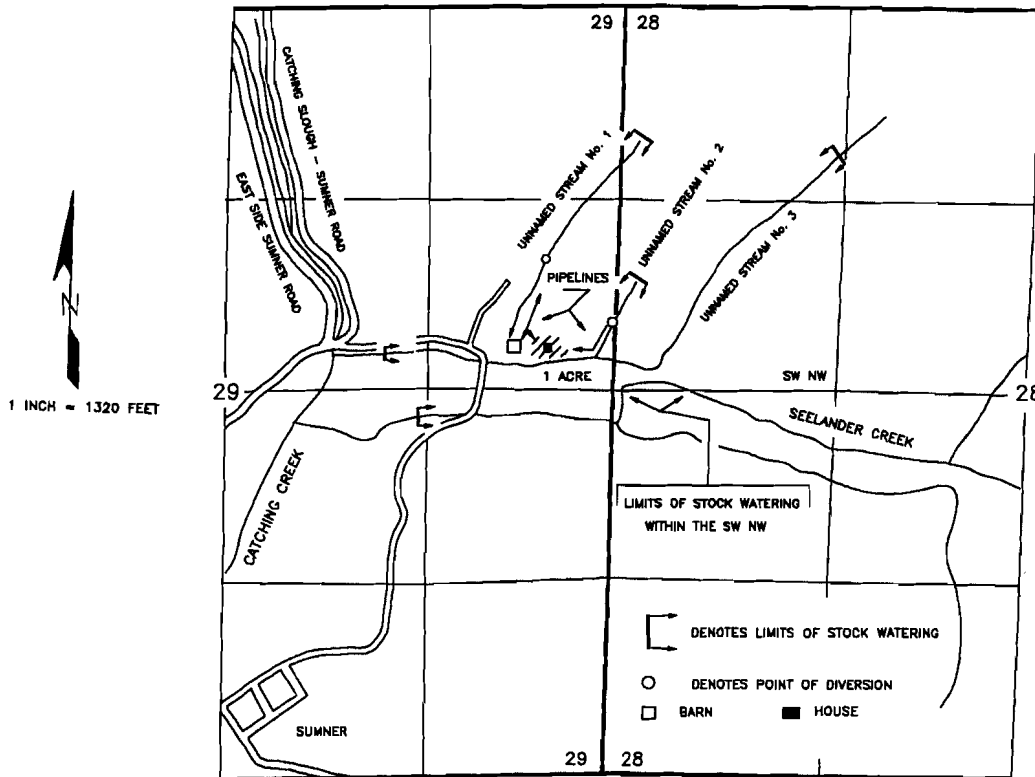

THE POINTS OF DIVERSION ARE LOCATED AS FOLLOWS:

SOURCE	SOUTH	WEST	SECTION	¼ ¼
SPRING AT UNNAMED STREAM No. 1	1730 FEET	550 FEET	29	SE¼ NE¼
SPRING AT UNNAMED STREAM No. 2	2160 FEET	81 FEET	29	SE¼ NE¼

ALL DISTANCES FROM THE NORTHEAST CORNER OF SECTION 29 AND WITHIN SECTION 29, TOWNSHIP 26 SOUTH, RANGE 12 WEST, W.M.; COOS COUNTY.

THE PURPOSE OF THIS MAP IS TO IDENTIFY THE LOCATION OF THE WATER RIGHT.
IT IS NOT INTENDED TO PROVIDE INFORMATION RELATIVE TO THE LOCATION OF
PROPERTY OWNERSHIP BOUNDARY LINES.

