

**PRE - 1909 VESTED WATER RIGHTS MAP**  
**Haynes Slough Ranch SWR-637**  
**Fred Messerle & Sons Inc.**  
 Located in portions of Section 19, T. 24 S., R. 12 W., and  
 Portions of Section 24, T. 24 S., R. 13 W., W. M.  
 Coos County, Oregon

PREPARED FOR: FRED MESSERLE & SONS INC.  
 PREPARED BY: DENNIS GOUDE  
 SURVEY DATE: 2/23/94

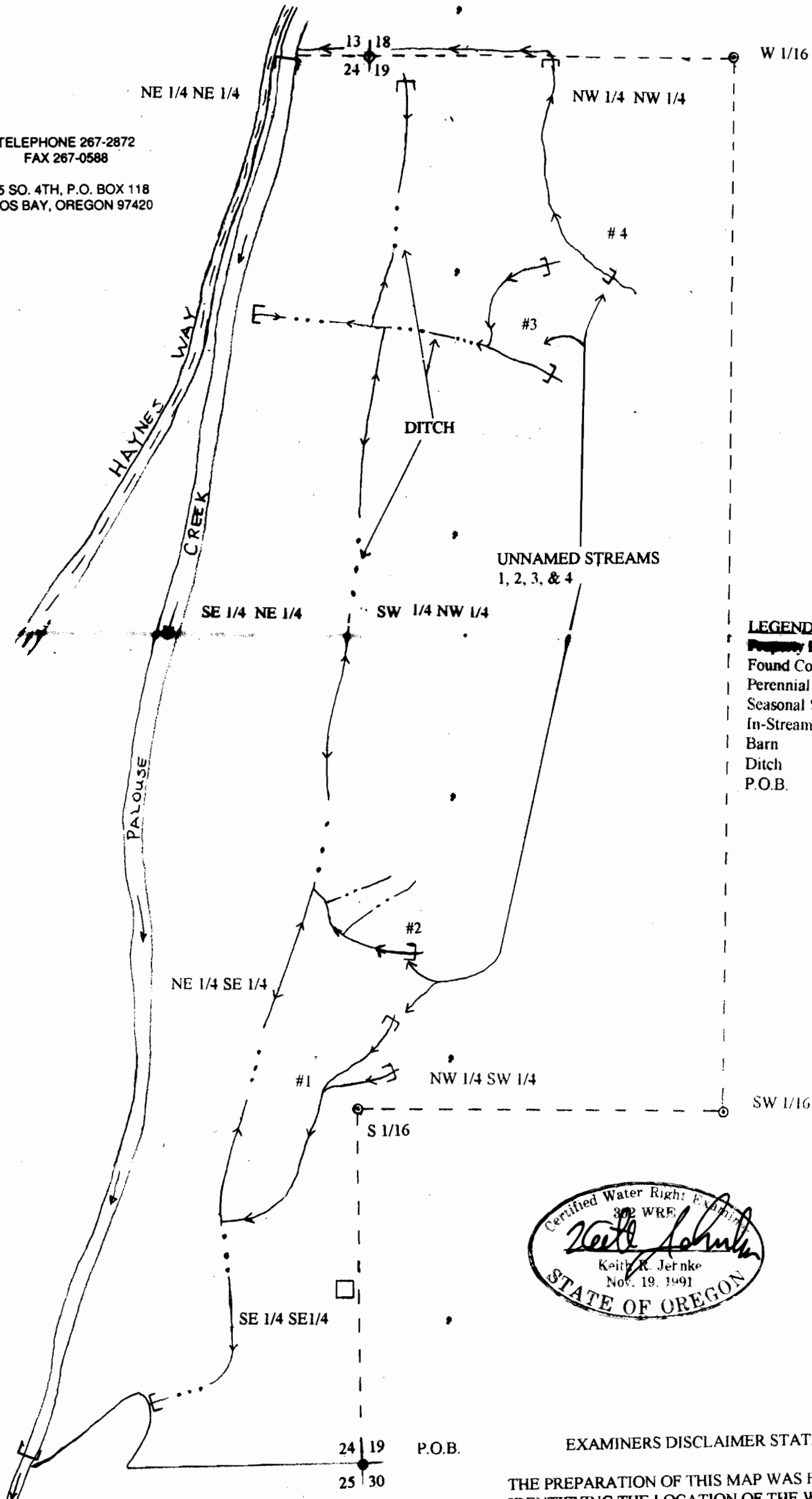

TELEPHONE 267-2872  
 FAX 267-0588  
 705 SO. 4TH, P.O. BOX 118  
 COOS BAY, OREGON 97420



**EXAMINERS DISCLAIMER STATEMENT**

THE PREPARATION OF THIS MAP WAS FOR THE PURPOSE OF IDENTIFYING THE LOCATION OF THE WATER RIGHT ONLY AND HAS NO INTENT TO PROVIDE DIMENSIONS OR LOCATION OF PROPERTY OWNERSHIP LINES.