

PRE-1' VESTED WATER RIGHTS MAP 'R-640

Located in portions of Sections 4 & 9

T. 26 S, R. 12 W., W.M.

Coos County, Oregon

PREPARED FOR: FRED MESSERLE & SONS INC.

PREPARED BY: DENNIS GOUDE

DATE SURVEYED: FEBRUARY 26, 1994



NOTE: P.O.D. IS LOCATED 1116 FEET SOUTH AND 482 EAST OF THE NORTHWEST CORNER OF SECTION 9, T. 26 S, R. 12 W., W.M.

NOTE: P.O.D. IS AN IN-STREAM DEVICE.

NOTE: PIPE IS 5/8 INCH DIAMETER PVC, A TOTAL LENGTH OF 350 FEET.

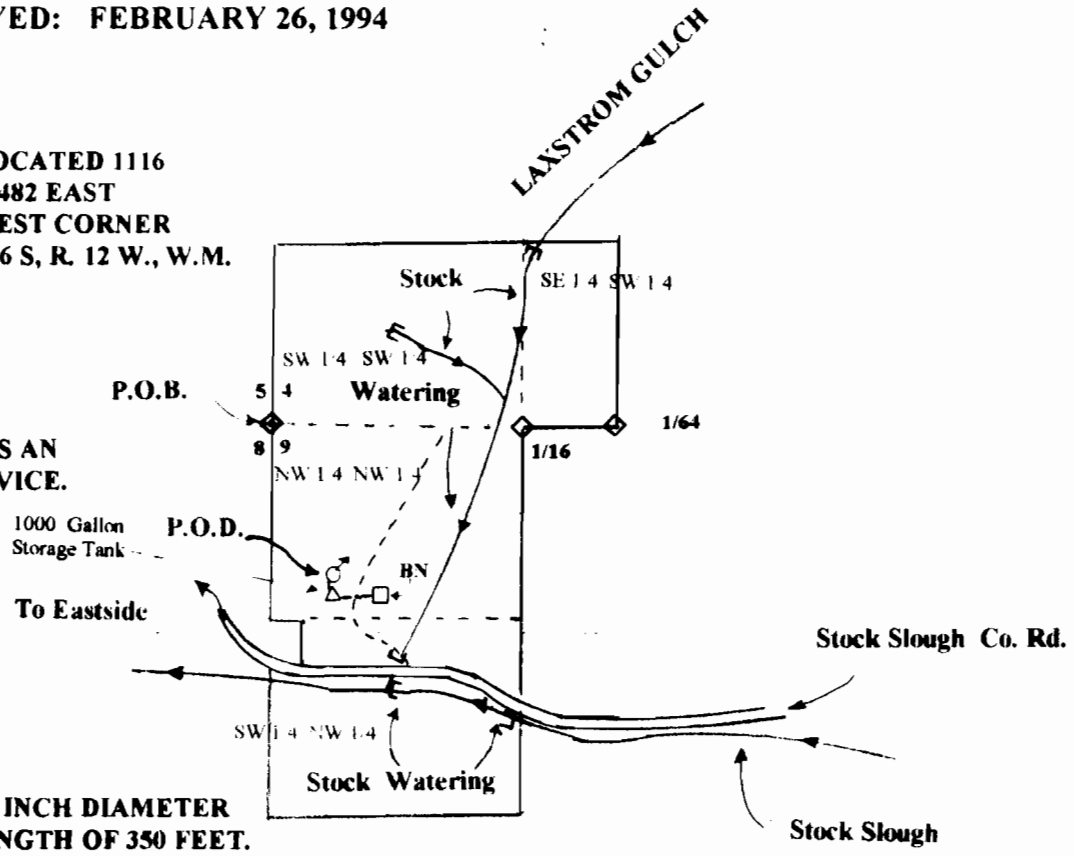

LEGEND

- P.O.B.
- P.O.D.
- Gravel Road
- In-stream Stock Use
- Storage Tank 1000 gal
- Pipe
- County Rd.
- Barn



EXAMINERS DISCLAIMER STATEMENT

THE PREPARATION OF THIS MAP WAS FOR THE PURPOSE OF IDENTIFYING THE LOCATION OF THE WATER RIGHT ONLY AND HAS NO INTENT TO PROVIDE DIMENSIONS OR LOCATION OF PROPERTY OWNERSHIP LINES.



TELEPHONE 267-2872  
FAX 267-0588  
705 SO. 4TH, P.O. BOX 118  
COOS BAY, OREGON 97420