

RECEIVED

SEP 10 1992

WATER RESOURCES  
SALEM, OREGON

T.7S., R.2W., W.M.

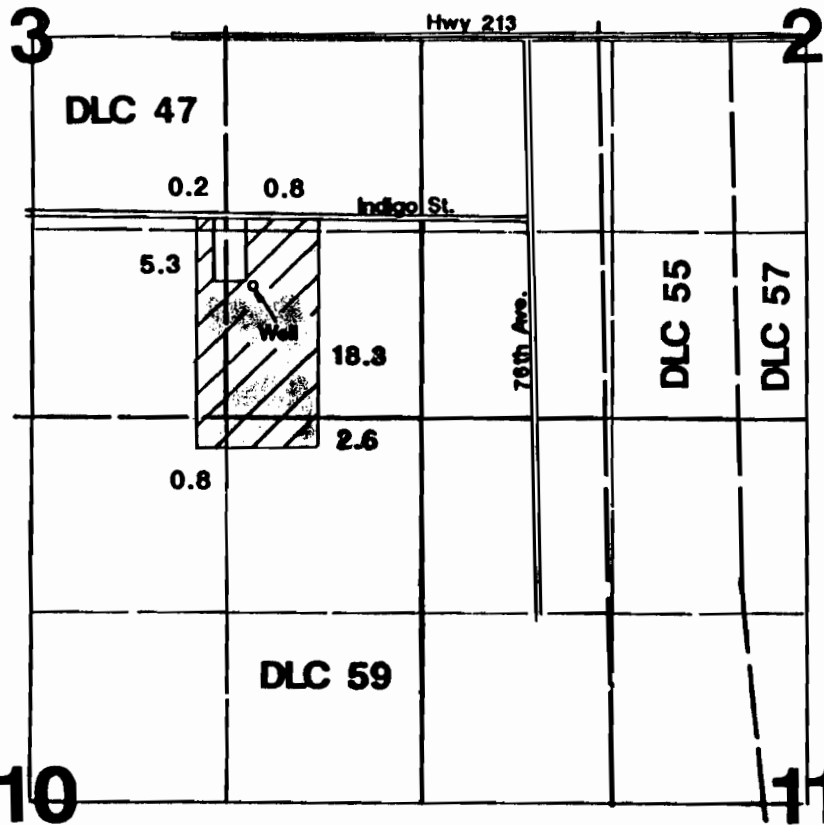

Hansberry  
yellow  
3.0 Acres  
0.04 cfs

Roth-green  
25.0 Acres  
0.31 cfs

1" = 1320'



Well located 900'N & 1120'W from SE corner of Section 3.

## Final Proof Survey

STATE OF OREGON, } ss  
County of Marion.

Application # G-12027

Permit # G-10984

I certify that the within was Application # G-12027  
on the 15th day of November, 1993, at 8  
o'clock A.m., and was recorded in Miscellaneous  
Records, Vol. 7 Page 2827.

In Name Of

Water Resources Director

Glen Hansberry

Surveyed on July 1, 1992 by J. Grimm

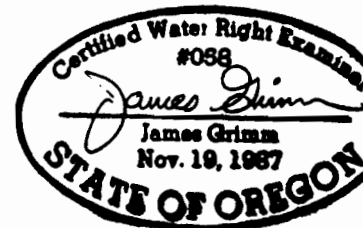

THIS MAP WAS PREPARED FOR THE PURPOSE OF  
IDENTIFYING THE LOCATION OF A WATER RIGHT  
ONLY AND IS NOT INTENDED TO PROVIDE LEGAL  
DIMENSIONS OR LOCATION OF PROPERTY  
OWNERSHIP LINES.

G12027