

STATE OF OREGON

COUNTY OF LAKE

PERMIT TO APPROPRIATE THE PUBLIC WATERS

THIS PERMIT IS HEREBY ISSUED TO

ELDER RANCH INC
ROBIN J ELDER
28800 HWY 31
PAISLEY, OREGON 97636

(541) 943-3350

The specific limits and conditions of the use are listed below.

APPLICATION FILE NUMBER: G-15544

SOURCE OF WATER: THREE WELLS IN CROOKED CREEK BASIN

PURPOSE OR USE: IRRIGATION OF 244.0 ACRES

MAXIMUM RATE: NOT TO EXCEED 3.00 CUBIC FEET PER SECOND (CFS), BEING 2.87 CFS FROM WELL #1 OR ALTERNATE WELL #1A, 0.128 CFS FROM WELL #2, AND 2.87 CFS FROM WELL #3 OR ALTERNATE WELL #3A

PERIOD OF USE: MARCH 1 THROUGH OCTOBER 31

DATE OF PRIORITY: JUNE 21, 2001

WELL LOCATIONS:

WELL #1 - SW $\frac{1}{4}$ NE $\frac{1}{4}$, SECTION 5. 2400 FEET SOUTH & 3840 FEET EAST FROM THE NW CORNER OF SECTION 5, T36S, R21E, W.M.

ALTERNATE WELL #1A - SE $\frac{1}{4}$ NW $\frac{1}{4}$, SECTION 5. 1940 FEET SOUTH & 2640 FEET EAST FROM THE NW CORNER OF SECTION 5, T36S, R21E, W.M.

WELL #2 - LOT 2 (NW $\frac{1}{4}$ NE $\frac{1}{4}$), SECTION 5. 950 FEET SOUTH & 3840 FEET EAST FROM THE NW CORNER OF SECTION 5, T36S, R21E, W.M.

WELL #3 - SW $\frac{1}{4}$ SE $\frac{1}{4}$, SECTION 5. 750 FEET NORTH & 3840 FEET EAST FROM THE SW CORNER OF SECTION 5, T36S, R21E, W.M.

ALTERNATE WELL #3A - NW $\frac{1}{4}$ SE $\frac{1}{4}$, SECTION 5. 2000 FEET NORTH & 2640 FEET EAST FROM THE SW CORNER OF SECTION 5, T36S, R21E, W.M.

The amount of water used for irrigation under this right, together with the amount secured under any other right existing for the same lands, is

limited to a diversion of ONE-EIGHTIETH of one cubic foot per second (or its equivalent) and 3.0 acre-feet for each acre irrigated during the irrigation season of each year.

THE PLACE OF USE IS LOCATED AS FOLLOWS:

LOT 2	NW ¼ NE ¼	24.0 ACRES
	SW ¼ NE ¼	40.0 ACRES
LOT 3	NE ¼ NW ¼	20.0 ACRES
	SE ¼ NW ¼	40.0 ACRES
	NE ¼ SW ¼	40.0 ACRES
	SE ¼ SW ¼	20.0 ACRES
	NW ¼ SE ¼	40.0 ACRES
	SW ¼ SE ¼	20.0 ACRES

SECTION 5

TOWNSHIP 36 SOUTH, RANGE 21 EAST, W.M.

Measurement, recording and reporting conditions:

- A. Before water use may begin under this permit, the permittee shall install a meter or other suitable measuring device as approved by the Director. The permittee shall maintain the meter or measuring device in good working order, shall keep a complete record of the amount of water used each month and shall submit a report which includes the recorded water use measurements to the Department annually or more frequently as may be required by the Director. Further, the Director may require the permittee to report general water use information, including the place and nature of use of water under the permit.
- B. The permittee shall allow the watermaster access to the meter or measuring device; provided however, where the meter or measuring device is located within a private structure, the watermaster shall request access upon reasonable notice.

If the number, location, or construction of any well deviates from that proposed in the permit application or permit conditions, the conclusions of the Proposed Final Order and Final Order under which this permit was granted may be revised, conditions may be appropriately revised, or this permit may not be valid.

STANDARD CONDITIONS

If substantial interference with a senior water right occurs due to withdrawal of water from any well listed on this permit, then use of

water from the well(s) shall be discontinued or reduced and/or the schedule of withdrawal shall be regulated until or unless the Department approves or implements an alternative administrative action to mitigate the interference. The Department encourages junior and senior appropriators to jointly develop plans to mitigate interferences.

The wells shall be constructed in accordance with the General Standards for the Construction and Maintenance of Water Wells in Oregon. The works shall be equipped with a usable access port, and may also include an air line and pressure gauge adequate to determine water level elevation in the well at all times.

The use shall conform to such reasonable rotation system as may be ordered by the proper state officer.

Prior to receiving a certificate of water right, the permit holder shall submit the results of a pump test meeting the department's standards, to the Water Resources Department. The Director may require water level or pump test results every ten years thereafter.

Failure to comply with any of the provisions of this permit may result in action including, but not limited to, restrictions on the use, civil penalties, or cancellation of the permit.

This permit is for the beneficial use of water without waste. The water user is advised that new regulations may require the use of best practical technologies or conservation practices to achieve this end.

By law, the land use associated with this water use must be in compliance with statewide land-use goals and any local acknowledged land-use plan.

The use of water shall be limited when it interferes with any prior surface or ground water rights.

The Director finds that the proposed use(s) of water described by this permit, as conditioned, will not impair or be detrimental to the public interest.

Complete application of the water to the use shall be made on or before October 1, 2006. If the water is not completely applied before this date, and the permittee wishes to continue development under the permit, the permittee must submit an application for extension of time, which may be approved based upon the merit of the application.

Within one year after complete application of water to the proposed use, the permittee shall submit a claim of beneficial use, which includes a map and report, prepared by a Certified Water Rights Examiner (CWRE).

Issued April 30, 2002

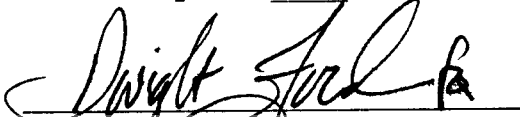
Paul R. Cleary, Director
Water Resources Department

NOTE: Pursuant to ORS 537.330, in any transaction for the conveyance of real estate that includes any portion of the lands described in this permit, the seller of the real estate shall, upon accepting an offer to purchase that real estate, also inform the purchaser in writing whether any permit, transfer approval order, or certificate evidencing the water right is available and that the seller will deliver any permit, transfer approval order or certificate to the purchaser at closing, if the permit, transfer approval order or certificate is available.

Application G-15544
Basin 13
JWG - WEEK 332

Water Resources Department
Volume 2 CROOKED CR & MISC

PERMIT G-15058
District 12

T 36 S, R 21 E, W.M.
SECTION 5

REVISED MAP
January 8, 2002
Feb 20, 2002 DLB

WELLS WILL BE LOCATED AS FOLLOWS:

WELL 1 - 2400 FEET SOUTH AND 3840 FEET EAST FROM THE
NW CORNER, SECTION 5.

WELL 2 - 950 FEET SOUTH AND 3840 FEET EAST FROM THE
NW CORNER, SECTION 5.

WELL 3 - IF NEEDED, 750 FEET NORTH AND 3840 FEET EAST
FROM THE SW CORNER, SECTION 5.

WELL 1A - ALTERNATE LOCATION FOR WELL 1
1940 FEET SOUTH AND 2640 FEET EAST
FROM THE NW CORNER, SECTION 5.

WELL 3A - ALTERNATE LOCATION FOR WELL 3
2000 FEET NORTH AND 2640 FEET EAST
FROM THE SW CORNER, SECTION 5.

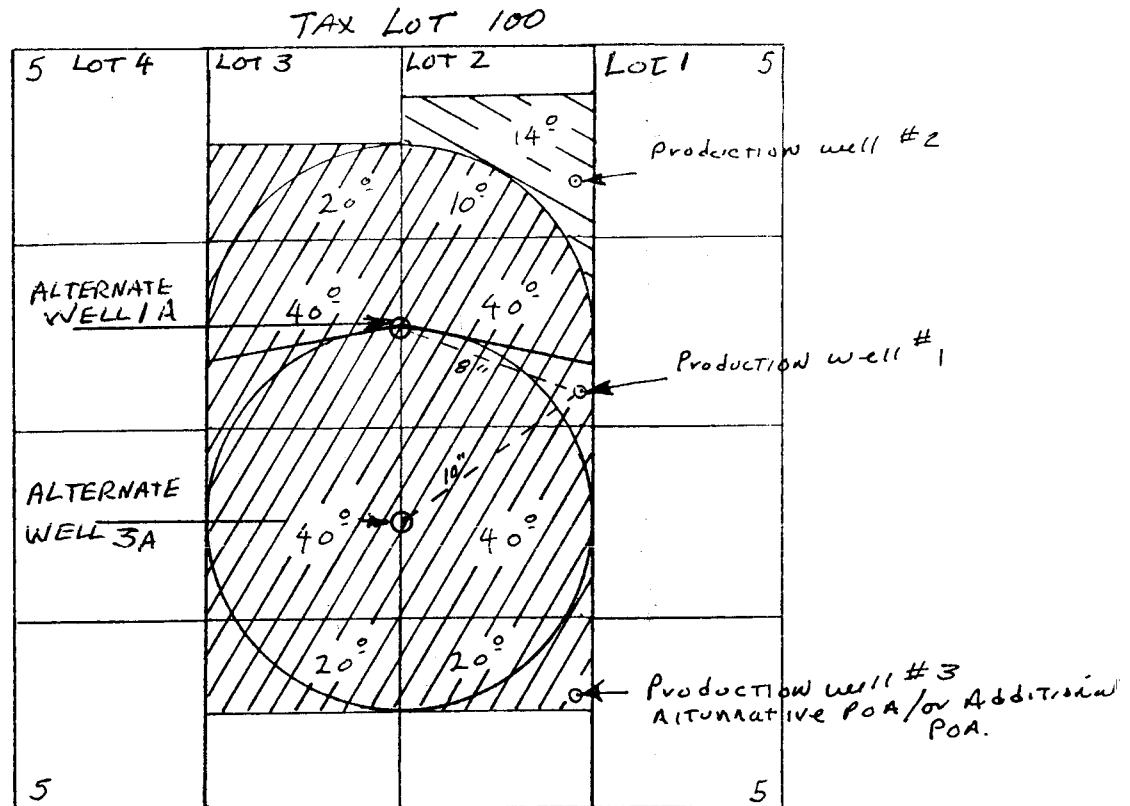

Scale - 1" = 1320'

RECEIVED

FEB 21 2002

WATER RESOURCES DEPT.
SALEM, OREGON

RECEIVED

JAN 09 2002

WATER RESOURCES DEPT.
SALEM, OREGON