

Permit No. G-4895

APPLICATION FOR A PERMIT

To appropriate the Ground Waters of the State of Oregon

I, Albert H. Miller
(Name of applicant)
of Junction City, Oregon, county of Lane
(Postoffice Address)
state of Oregon, do hereby make application for a permit to appropriate the following described ground waters of the state of Oregon, SUBJECT TO EXISTING RIGHTS:

If the applicant is a corporation, give date and place of incorporation

1. Give name of nearest stream to which the well, tunnel or other source of water development is situated Willamette River
(Name of stream)

tributary of Columbia River

2. The amount of water which the applicant intends to apply to beneficial use is .0375 cubic feet per second or 16.83 gallons per minute.

3. The use to which the water is to be applied is Crop irrigation

4. The well or other source is located 535 ft. South and 960 ft. East from the N.W. corner of Section 10, T. 16 S., R. 4 W.W.M.
(N. or S.) (E. or W.)
(Section or subdivision)

North end of property as per photo copy
(If preferable, give distance and bearing to section corner)

(If there is more than one well, each must be described. Use separate sheet if necessary)

being within the N.W. 1/4 of N.W. 1/4 of Sec. 10, Twp. 16 S., R. 4 W. W. M., in the county of Lane

5. The _____ to be _____ miles in length, terminating in the _____ of Sec. _____, Twp. _____, R. _____, W. M., the proposed location being shown throughout on the accompanying map.
(Canal or pipe line) (Smallest legal subdivision)

6. The name of the well or other works is _____

DESCRIPTION OF WORKS

7. If the flow to be utilized is artesian, the works to be used for the control and conservation of the supply when not in use must be described.

8. The development will consist of _____ having a diameter of 5 inches and an estimated depth of 30 feet. It is estimated that 30 feet of the well will require steel casing. Depth to water table is estimated 26 ft.
(Give number of wells, tunnels, etc.) (Kind) (Feet)

13. To supply the city of
in county, having a present population of
and an estimated population of in 19.....

ANSWER QUESTIONS 14, 15, 16, 17 AND 18 IN ALL CASES

- 14. Estimated cost of proposed works, \$..... 350.00
- 15. Construction work will begin on or before May 1 - 1970
- 16. Construction work will be completed on or before May 5 - 1970
- 17. The water will be completely applied to the proposed use on or before May 15 - 1970
- 18. If the ground water supply is supplemental to an existing water supply, identify any application for permit, permit, certificate or adjudicated right to appropriate water, made or held by the applicant. None

Albert C. Miller
(Signature of applicant)

Remarks: Location map (attached)

Map of Property
Adjacent to Brown's Landing on Willamette River

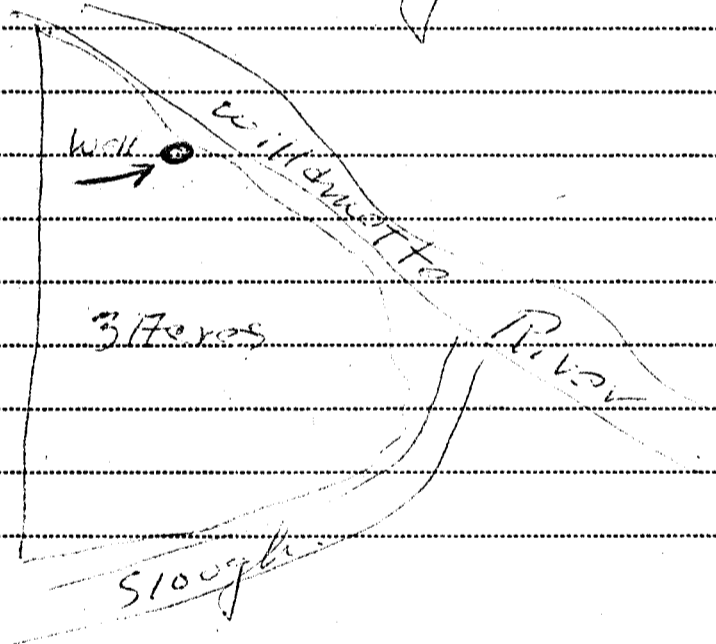

STATE OF OREGON, }
County of Marion, } ss.

This is to certify that I have examined the foregoing application, together with the accompanying maps and data, and return the same for ..correction.....

In order to retain its priority, this application must be returned to the State Engineer, with corrections on or before July 13th, 1970...

WITNESS my hand this 11th day of May, 19.. 70

RECEIVED
JUL 2 1970
STATE ENGINEER
SALEM OREGON

By
Wayne J. Overcash
Wayne J. Overcash ASSISTANT

CHRIS L. WHEELER
STATE ENGINEER

STATE OF OREGON,
County of Marion, } ss.

PERMIT

This is to certify that I have examined the foregoing application and do hereby grant the same, SUBJECT TO EXISTING RIGHTS and the following limitations and conditions:

The right herein granted is limited to the amount of water which can be applied to beneficial use and shall not exceed 0.038 cubic feet per second measured at the point of diversion from the well or source of appropriation, or its equivalent in case of rotation with other water users, from a well

The use to which this water is to be applied is irrigation

If for irrigation, this appropriation shall be limited to 1/80 of one cubic foot per second or its equivalent for each acre irrigated and shall be further limited to a diversion of not to exceed 2 1/2 acre feet per acre for each acre irrigated during the irrigation season of each year;

and shall be subject to such reasonable rotation system as may be ordered by the proper state officer.

The well shall be cased as necessary in accordance with good practice and if the flow is artesian the works shall include proper capping and control valve to prevent the waste of ground water.

The works constructed shall include an air line and pressure gauge or an access port for measuring line, adequate to determine water level elevation in the well at all times.

The permittee shall install and maintain a weir, meter, or other suitable measuring device, and shall keep a complete record of the amount of ground water withdrawn.

The priority date of this permit is April 21, 1970

Actual construction work shall begin on or before July 2, 1972 and shall

thereafter be prosecuted with reasonable diligence and be completed on or before October 1, 1972

Complete application of the water to the proposed use shall be made on or before October 1, 1973

WITNESS my hand this 2nd day of July, 1971

Chris L. Wheeler

STATE ENGINEER

Application No. G- 5163
Permit No. G- 4895

PERMIT

TO APPROPRIATE THE GROUND
WATERS OF THE STATE
OF OREGON

This instrument was first received in the
office of the State Engineer at Salem, Oregon,
on the 2/5 day of April
1970, at 8:00 o'clock P. M.

Returned to applicant:

Approved:

July 2, 1971

Recorded in book No. of

Ground Water Permits on page G-4895

CHRIS L. WHEELER
STATE ENGINEER

Drainage Basin No. 2 page 116

fee 20.00