

Reservoir Permit No. 4518

### Application for a Permit to Construct a Reservoir and to Store for Beneficial Use the Unappropriated Waters of the State of Oregon

I, JOHN MICHAEL, JR.  
(Name of Applicant)

of R. 1, BOX 220 DAYTON  
(Mailing Address)

State of OREGON, do hereby make application for a permit to construct the following described reservoir and to store the unappropriated waters of the State of Oregon, subject to existing rights.

If the applicant is a corporation, give date and place of incorporation

1. The name of the proposed reservoir is "MICHAEL RESERVOIR"

2. The name of the stream from which the reservoir is to be filled and the appropriation made is UNNAMED SOURCE OF WATER IS RUNOFF DURING RAINY SEASON  
tributary of AND SPRINGS DURING SUMMER MONTHS

3. The amount of water to be stored is ~~5~~ FIVE (ESTIMATE) acre feet.

4. The use to be made of the impounded water is IRRIGATION  
SEC AIR PHOTO-ACCOMP. irrigation power, forest, etc.

5. The location of the proposed reservoir will be in Sec. 34 (See APPX 200 X 50 X 7)  
(Give sections or township to be stumped)

Tp. 4S, R. 3W, W.M., in the county of YAMHILL

(a) State whether situated in channel of running stream and give character of material at outlet  
RESERVOIR IS A NATURAL CRESCENT RESERVOIR - WITH A CLAY  
EARTH DAM AT THE LOWER END, SPRINGS IN THE RESERVOIR PROVIDE A SMALL RUNNING  
STREAM THE YEAR AROUND.

(b) If not in channel of running stream, state how it is to be filled. If through a feed canal, give name and dimensions  
THE RESERVOIR IS TO BE FILLED BY  
WINTER RUN-OFF OF SPRINGS LOCATED IN THE RESERVOIR  
WHICH IS CLOSED BY A DAM CREATING THE RESERVOIR  
STORAGE.

6. The dam will be located in SEE AIR PHOTO Sec. 34  
(Smallest legal subdivision)

Tp. 4S, R. 3W, W.M. The maximum height will be 10 feet above stream bed or ground surface on center line of dam. The length on top will be 58 feet; length on bottom 43 feet; width on top 8 feet; slope on front or water side 3 TO 1; slope on back 2 TO 1; height of dam above water line when full 2 1/2 feet.

\* A different form of application should be used for the appropriation of stored water to beneficial use. Such forms can be obtained without charge together with instructions by addressing the State Engineer, Salem, Oregon.

7. The construction of dam, the material of which it is to be built, and method of protection from waves are as follows: CHAY EARTH - DAM CONSTRUCTED WITH DOSEB PUSHING DIRT FROM ONE END FROM CUT IN BANK OF RENEVE - TOP & DOWN STREAM SIDE TO BE PLANTED TO GRASS AFTER IT HAS SETTLED. UNTIL IT SETTLES THE TOP & SIDES WILL BE TOPPED WITH STRAW.

8. The location of wasteway with dimensions are as follows: AT NORTH END OF DAM - (State whether over or around the dam.)

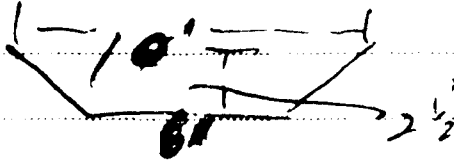

9. The location of outlet from the proposed reservoir, with character of construction and dimensions, are as follows: A 6" STEEL PIPE WITH VALVE IS LOCATED AT BASE OF DAM TO DRAIN (on W. side) RESERVOIR IF DESIRED, VALVE ON UP STREAM SIDE. (All dams across natural stream channels must be provided with an outlet conduit of such capacity and location to pass the normal flow of the stream at any time)

10. The area submerged by the proposed reservoir, when full, will be ~~1.0~~ <sup>1.0</sup> acres, with a maximum depth of water of 7.5 feet; and approximate mean depth of water 5 feet.

11. The estimated cost of the proposed work is \$ 100.00

12. Construction work will begin on or before

PRESENT

13. Construction work will be completed on or before

~~10/1~~ 65

John Nicholas, Jr.

STATE OF OREGON.

County of Marion.

This is to certify that I have examined the foregoing application, together with the accompanying maps and data, and return the same for...

In order to retain its priority, this application must be returned to the State Engineer, on or before January 25, 1945.

WITNESS my hand this 25th day of January, 1945.

RECEIVED  
MAR 2 1945  
By  
STATE ENGINEER  
SALEM, OREGON

Walter [Signature]

Remarks:

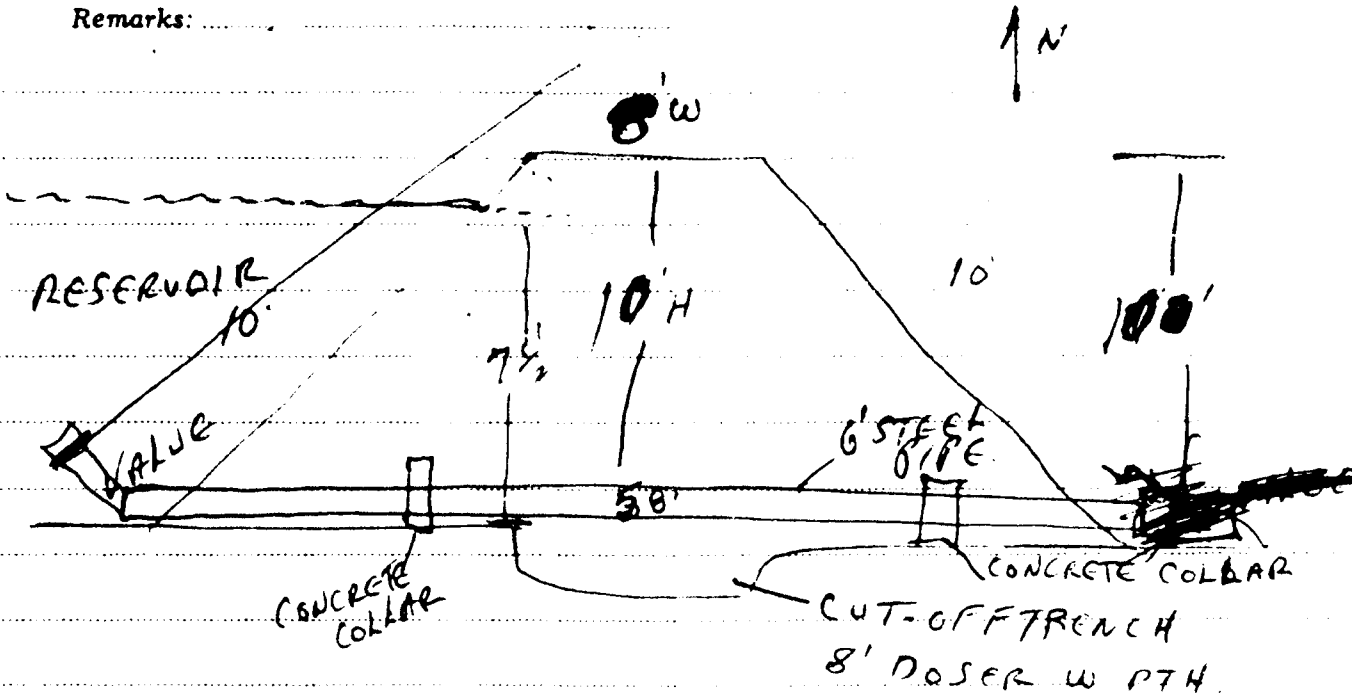

SPILL-WAY AROUND NORTH END OF DAM.

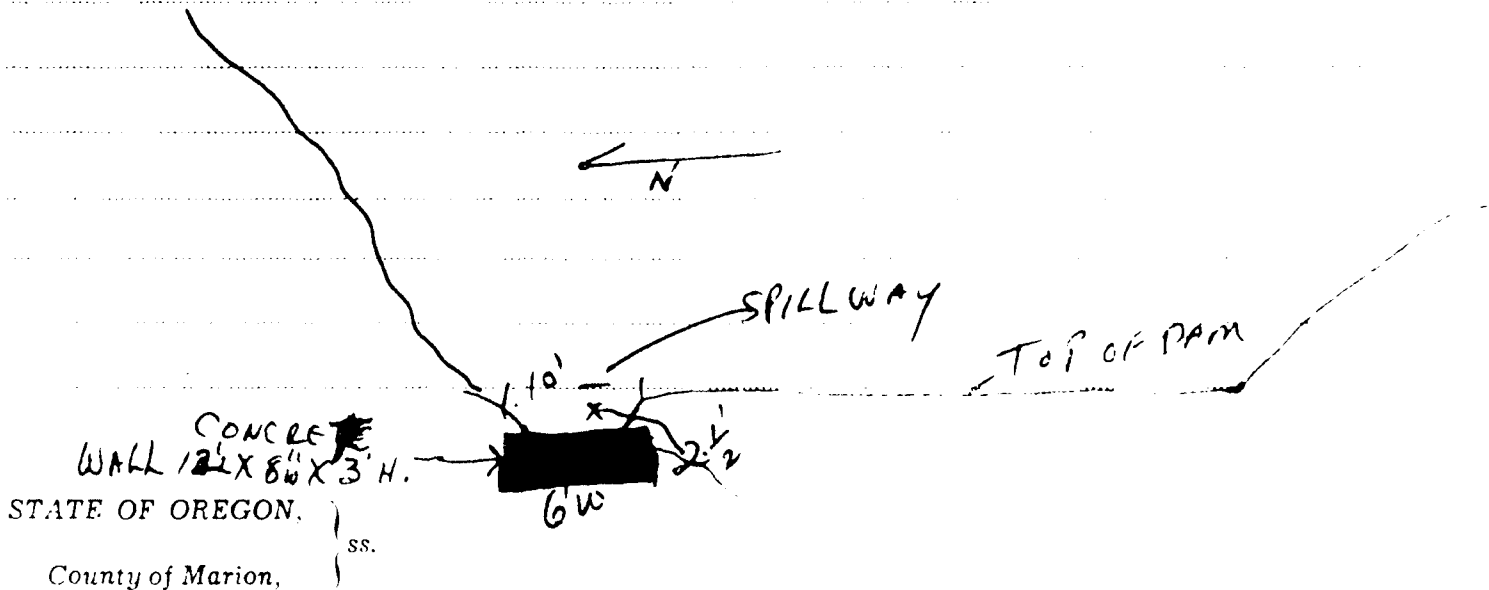

STATE OF OREGON, )  
County of Marion, ) ss.

This is to certify that I have examined the foregoing application and do hereby grant the same, subject to the following limitations and conditions: The right herein granted is limited to the construction of Michael Reservoir and storage of water from an unnamed stream to be appropriated under application No. 40382, permit No. 30262 for irrigation.

The right hereunder shall be limited to the storage of 5.0 acre feet

The priority date of this permit is March 24, 1965

Actual construction work shall begin on or before May 20, 1966 and

shall thereafter be prosecuted with reasonable diligence and be completed on or before October 1, 1967.

WITNESS my hand this 20<sup>th</sup> day of May, 1965.

*John T. White*  
STATE ENGINEER

Application No. *R-40381*

Reservoir Permit No. *A548*

**PERMIT**

To construct a reservoir and store for beneficial use the unappropriated waters of the State of Oregon.

This instrument was first received in the office of the State Engineer at Salem, Oregon, on the *26<sup>th</sup>* day of *October*, 19*64*, at *8:00* o'clock *A*. M.

Returned to applicant:

Approved:

May 20, 1965

Recorded in Book No. *4518* of Reservoirs, on Page

*C. R. L. L. L.* State Engineer

Drainage Basin No. *2* page *76 A31*

Fees