

STATE OF OREGON

COUNTY OF BAKER

PERMIT TO APPROPRIATE THE PUBLIC WATERS

THIS PERMIT IS HEREBY ISSUED TO

BAKER VALLEY IRRIGATION DISTRICT  
3895 10TH. STREET  
BAKER, OREGON 97814

PHONE 523-5451

to use the waters of POWDER RIVER AND MASON RESERVOIR CONSTRUCTED UNDER APPLICATION R-31037 , PERMIT R-5083, a tributary of SNAKE RIVER, for the purpose of IRRIGATION AND SUPPLEMENTAL IRRIGATION OF 12611.6 ACRES.

This Permit is issued approving Application 62167. The date of priority is APRIL 26, 1982. The use is limited to not more than 150.0 CUBIC FEET PER SECOND or its equivalent in case of rotation, measured at the point of diversion from the source.

The points of diversion are located as follows:

- MASON DAM - NW 1/4 NE 1/4, SECTION 25, 50 FEET SOUTH AND 1500 FEET WEST FROM NE CORNER SECTION 25, T 10 S, R 38 E, W.M.
- SMITH DITCH - NW 1/4 NE 1/4, SECTION 19, 945 FEET SOUTH AND 1865 FEET WEST FROM NE CORNER SECTION 19, T 10 S, R 40 E, W.M.
- SHAW-STEWART DITCH - NW 1/4 NE 1/4, SECTION 19, 570 FEET SOUTH AND 1900 FEET WEST FROM NE CORNER SECTION 19, T 10 S, R 40 E, W.M.
- CURRY DITCH - NW 1/4 NW 1/4, SECTION 17, 1270 FEET SOUTH AND 1170 FEET EAST FROM NW CORNER SECTION 17, T 10 S, R 40 E, W.M.
- MARSH-DICKINSON DITCH - NE 1/4 SW 1/4, SECTION 5, 1600 FEET NORTH AND 2350 FEET EAST FROM SW CORNER SECTION 5, T 10 S, R 40 E, W.M.
- BAMBERGER DITCH - SE 1/4 NE 1/4, SECTION 32, 2650 FEET SOUTH AND 690 FEET WEST FROM NE CORNER SECTION 32, T 9 S, R 40 E, W.M.
- SETTLERS SLOUGH DITCH - NW 1/4 SW 1/4, SECTION 21, 2160 FEET NORTH AND 30 FEET EAST FROM SW CORNER SECTION 21, T 9 S, R 40 E, W.M.
- BALDOCK-NEW-HOME DITCH - SW 1/4 NW 1/4, SECTION 16, 1700 FEET SOUTH AND 400 FEET EAST FROM NW CORNER SECTION 16, T 9 S, R, 40 E, W.M.
- CORRAL DITCH - SW 1/4 NW 1/4, SECTION 9, 50 FEET NORTH AND 2720 FEET EAST FROM C 1/4 CORNER SECTION 8, T 9 S, R 40 E, W.M.
- ESTES WEST DITCH - NE 1/4 NE 1/4, SECTION 8, 110 FEET SOUTH AND 600 FEET WEST FROM NE CORNER SECTION 8, T 9 S, R 40 E, W.M.

SEE NEXT PAGE

MCENROE EAST DITCH - NE 1/4 SE 1/4, SECTION 5, 2250 FEET NORTH AND 320 FEET WEST FROM SE CORNER SECTION 5, T 9 S, R 40 E, W.M.

COMPANY EAST DITCH - SE 1/4 NE 1/4, SECTION 5, 1600 FEET SOUTH AND 280 FEET WEST FROM NE CORNER SECTION 5, T 9 S, R 40 E, W.M.

COMPANY WEST DITCH - SE 1/4 NE 1/4, SECTION 5, 1600 FEET SOUTH AND 320 FEET WEST FROM NE CORNER SECTION 5, T 9 S, R 40 E, W.M.

WENDT EAST DITCH - SW 1/4 SW 1/4, SECTION 33, 1000 FEET NORTH AND 600 FEET EAST FROM SW CORNER SECTION 33, T 8 S, R 40 E, W.M.

POWERS EAST 2 DITCH - NW 1/4 SW 1/4, SECTION 33, 2640 FEET NORTH AND 850 FEET EAST FROM SW CORNER SECTION 33, T 8 S, R 40 E, W.M.

POWERS EAST 1 DITCH - NW 1/4 SW 1/4, SECTION 33, 2650 FEET NORTH AND 850 FEET EAST FROM SW CORNER SECTION 33, T 8 S, R 40 E, W.M.

POWERS WEST 1 DITCH - NW 1/4 SW 1/4, SECTION 33, 2650 FEET NORTH AND 800 FEET EAST FROM SW CORNER SECTION 33, T 8 S, R 40 E, W.M.

POWERS WEST 2 DITCH - SW 1/4 NW 1/4, SECTION 33, 2650 FEET NORTH AND 800 FEET EAST FROM SW CORNER SECTION 33, T 8 S, R 40 E, W.M.

TAGGETT WEST DITCH - SE 1/4 NW 1/4, SECTION 28, 2650 FEET NORTH AND 1650 FEET EAST FROM SW CORNER SECTION 28, T 8 S, R 40 E, W.M.

TAGGETT EAST DITCH - SE 1/4 NW 1/4, SECTION 28, 2650 FEET NORTH AND 1690 FEET EAST FROM SW CORNER SECTION 28, T 8 S, R 40 E, W.M.

HARRISON DITCH - NE 1/4 NE 1/4, SECTION 20, 20 FEET SOUTH AND 1130 FEET WEST FROM NE CORNER SECTION 20, T 8 S, R 40 E, W.M.

GREIR WEST DITCH - NE 1/4 NE 1/4, SECTION 17, 4460 FEET NORTH AND 920 FEET WEST FROM SE CORNER SECTION 17, T 8 S, R 40 W, W.M.

GREIR EAST 2 DITCH - NE 1/4 NE 1/4, SECTION 17, 4470 FEET NORTH AND 880 FEET WEST FROM SE CORNER SECTION 17, T 8 S, R 40 E, W.M.

GREIR EAST 3 DITCH - NE 1/4 NE 1/4, SECTION 17, 4470 FEET NORTH AND 880 FEET WEST FROM SE CORNER SECTION 17, T 8 S, R 40 E, W.M.

BECK-COLTON WEST 2 DITCH - NE 1/4 SW 1/4, SECTION 8, 1700 FEET NORTH AND 2050 FEET EAST FROM SW CORNER SECTION 8, T 8 S, R 40 E, W.M.

COLTON-BECK EAST 2 DITCH - NE 1/4 SW 1/4, SECTION 8, 1740 FEET NORTH AND 2070 FEET EAST FROM SW CORNER SECTION 8, T 8 S, R 40 E, W.M.

- COLTON-BECK WEST 1 - SE 1/4 NW 1/4, SECTION 8, 2660 FEET NORTH AND  
DITCH 1390 FEET EAST FROM SW CORNER SECTION 8, T 8  
S, R 40 E, W.M.
- COLTON-BECK EAST 1 - SE 1/4 NW 1/4, SECTION 8, 2670 FEET NORTH AND  
DITCH 1430 FEET EAST FROM SW CORNER SECTION 8, T 8  
S, R 40 E, W.M.
- COLTON-LAZY J.W.2 - SE 1/4 NE 1/4, SECTION 7, 1470 FEET SOUTH AND  
DITCH 40 FEET WEST FROM NE CORNER SECTION 7, T 8 S,  
R 40 E, W.M.
- COLTON-LAZY J.W.1 - NE 1/4 NE 1/4, SECTION 7, 420 FEET SOUTH AND  
DITCH 1240 FEET WEST FROM NE CORNER SECTION 7, T 8  
S, R 40 E, W.M.
- COLTON-LAZY J.E.2 - NE 1/4 NE 1/4, SECTION 7, 390 FEET SOUTH AND  
DITCH 1200 FEET WEST FROM NE CORNER SECTION 7, T 8  
S, R 40 E, W.M.
- COLTON-LAZY J.E.1 - NE 1/4 NE 1/4, SECTION 7, 390 FEET SOUTH AND  
DITCH 1200 FEET WEST FROM NE CORNER SECTION 7, T 8  
S, R 40 E, W.M.
- LILLEY DITCH - NE 1/4 NE 1/4, SECTION 11, 270 FEET SOUTH AND  
340 FEET WEST FROM NE CORNER SECTION 11, T 8  
S, R 39 E, W.M.
- MCKITRICK PUMP - NE 1/4 NW 1/4, SECTION 17, 10 FEET SOUTH AND  
1570 FEET EAST FROM NW CORNER SECTION 17, T  
10 S, R 40 E, W.M.

The amount of water used for irrigation, together with the amount secured under any other right existing for the same lands, shall be limited to ONE-FORTIETH of one cubic foot per second per acre, or its equivalent for each acre irrigated and shall be further limited to a diversion of not to exceed 3.5 acre-feet per acre for each acre irrigated during the irrigation season of each year from direct flow and storage from Mason Reservoir constructed under permit R-5083. The use of natural flow is limited to the period of March 1 through July 30 of each year.

The use shall conform to such reasonable rotation system as may be ordered by the proper state officer.

This development was reviewed and approved by the Water Resources Commission on April 1, 1988.

A description of the proposed place of use under the Permit is as follows:

<u>USER</u>	<u>PRIMARY - POWDER RIVER AND STORAGE</u>	<u>SUPPLEMENTAL STORAGE ONLY</u>	<u>SUPPLEMENTAL POWDER RIVER AND STORAGE</u>
-------------	---	--------------------------------------	--

ABRAMS

SW 1/4 SE 1/4  
SECTION 2  
T 9 S, R 40 E, W.M.

35.5 ACRES

BIGELOW

NW 1/4 SW 1/4	15.2 ACRES
SW 1/4 SW 1/4	38.2 ACRES
SE 1/4 SW 1/4	6.9 ACRES
SECTION 28	

NW 1/4 NW 1/4	40.0 ACRES
NE 1/4 NW 1/4	19.2 ACRES
SE 1/4 NW 1/4	8.7 ACRES
SECTION 33	

T 7 S, R 40 E, W.M.

BLACK

NW 1/4 SE 1/4	4.4 ACRES
SW 1/4 SE 1/4	2.6 ACRES
NE 1/4 SW 1/4	6.6 ACRES
SE 1/4 SW 1/4	14.4 ACRES
SECTION 28	25.0 ACRES
	9.7 ACRES

T 8 S, R 40 E, W.M.

BOGART

SW 1/4 NE 1/4	12.0 ACRES
NW 1/4 NE 1/4	6.0 ACRES
SECTION 4	

T 9 S, R 40 E, W.M.

BOOTSMA

NE 1/4 NW 1/4	10.1 ACRES
NW 1/4 NE 1/4	1.7 ACRES
SW 1/4 NE 1/4	18.5 ACRES
SE 1/4 NW 1/4	8.8 ACRES
SECTION 14	0.5 ACRE
	7.6 ACRES

T 9 S, R 40 E, W.M.

BOYER

NW 1/4 NE 1/4	15.0 ACRES
SW 1/4 NE 1/4	2.0 ACRES
SECTION 32	

T 9 S, R 40 E, W.M.

CARTER

NE 1/4 NE 1/4	8.7 ACRES
SECTION 33	
NW 1/4 NW 1/4	8.7 ACRES
NE 1/4 NW 1/4	9.1 ACRES
SECTION 34	

T 8 S, R 40 E, W.M.

CHANDLER, HERF.

SE 1/4 SE 1/4	40.0 ACRES
SECTION 3	
NE 1/4 NE 1/4	40.0 ACRES
SECTION 10	

CHANDLER, HERF. con't

NW 1/4 NE 1/4		0.9 ACRE	
SE 1/4 NE 1/4		15.3 ACRES	
SW 1/4 NE 1/4		10.9 ACRES	
SE 1/4 NW 1/4	12.5 ACRES		
SW 1/4 NW 1/4	27.5 ACRES		
NW 1/4 NW 1/4	39.2 ACRES		
NE 1/4 NW 1/4	12.0 ACRES		
SECTION 11			
NW 1/4 NW 1/4		18.6 ACRES	
SECTION 12			
NE 1/4 SE 1/4			27.0 ACRES
SE 1/4 SE 1/4			32.2 ACRES
SECTION 14			
NE 1/4 NE 1/4	7.0 ACRES		31.0 ACRES
SE 1/4 NE 1/4	7.6 ACRES		16.0 ACRES
SECTION 23			
NW 1/4 NW 1/4			8.0 ACRES
SW 1/4 NW 1/4			34.4 ACRES
NE 1/4 SW 1/4			40.0 ACRES
SE 1/4 SW 1/4			33.0 ACRES
SW 1/4 SW 1/4	8.0 ACRES		16.0 ACRES
NW 1/4 SW 1/4			38.0 ACRES
SE 1/4 SE 1/4	17.4 ACRES		
SW 1/4 SE 1/4	26.4 ACRES		
NE 1/4 SE 1/4	22.0 ACRES		
NW 1/4 SE 1/4	29.8 ACRES		
NE 1/4 NW 1/4	8.0 ACRES		32.8 ACRES
SE 1/4 NW 1/4	1.5 ACRES		38.7 ACRES
SECTION 24			
NW 1/4 NE 1/4	24.0 ACRES		
SW 1/4 NE 1/4	35.4 ACRES		
NW 1/4 SE 1/4	26.5 ACRES		
SW 1/4 SE 1/4	3.8 ACRES		
SECTION 25			
T 8 S, R 39 E, W.M.			
SE 1/4 NE 1/4		16.0 ACRES	
SW 1/4 NE 1/4		32.0 ACRES	
NE 1/4 SE 1/4		14.5 ACRES	
SE 1/4 SE 1/4		40.0 ACRES	
SW 1/4 SE 1/4		40.0 ACRES	
NW 1/4 SE 1/4		40.0 ACRES	
NE 1/4 SW 1/4	33.0 ACRES	7.0 ACRES	
NW 1/4 SW 1/4		40.0 ACRES	
NW 1/4 NE 1/4		9.0 ACRES	
NW 1/4 NW 1/4	40.0 ACRES		
SW 1/4 NW 1/4	22.0 ACRES	18.0 ACRES	
NE 1/4 NW 1/4	29.0 ACRES	11.0 ACRES	
SE 1/4 NW 1/4		20.0 ACRES	
SECTION 19			
SW 1/4 SW 1/4		10.5 ACRES	
SECTION 20			
NW 1/4 NE 1/4		7.0 ACRES	
SW 1/4 NE 1/4		13.0 ACRES	
SECTION 29			
T 8 S, R 40 E, W.M.			

CHESTER

SE 1/4 SE 1/4                    40.0 ACRES  
 SECTION 29  
 NE 1/4 NE 1/4                    9.8 ACRES  
 SECTION 32  
 T 7 S, R 40 E, W.M.

CLONTS

SE 1/4 NE 1/4                    2.9 ACRES  
 SE 1/4 SE 1/4                    40.0 ACRES  
 NE 1/4 SE 1/4                    37.6 ACRES  
 SECTION 23  
 T 8 S, R 40 E, W.M.

COLTON LAND

NE 1/4 SW 1/4                    4.3 ACRES  
 SW 1/4 SW 1/4                    7.6 ACRES  
 SECTION 4  
 NW 1/4 SW 1/4                    5.7 ACRES  
 SW 1/4 NW 1/4                    31.0 ACRES  
 NE 1/4 SE 1/4                    3.9 ACRES  
 NW 1/4 SE 1/4                    8.5 ACRES  
 NE 1/4 SW 1/4                    12.0 ACRES  
 SE 1/4 NW 1/4                    11.2 ACRES  
 SE 1/4 SE 1/4                    0.8 ACRES  
 SECTION 5  
 SW 1/4 NE 1/4                    24.0 ACRES  
 SE 1/4 NE 1/4                    29.0 ACRES  
 SECTION 6  
 T 8 S, R 40 E, W.M.

CONKLIN, AFT

SE 1/4 SE 1/4                    2.0 ACRES  
 SECTION 4  
 T 9 S, R 40 E, W.M.

CONKLIN, CLYDE

NE 1/4 NW 1/4                    2.4 ACRES  
 SECTION 3  
 T 9 S, R 40 E, W.M.

CONRO

NW 1/4 SE 1/4                    40.0 ACRES  
 SECTION 29  
 T 7 S, R 40 E, W.M.

COUGHLIN

SW 1/4 SE 1/4                    3.0 ACRES  
 SE 1/4 SE 1/4                    7.1 ACRES  
 SECTION 2  
 NW 1/4 NE 1/4                    9.2 ACRES  
 NE 1/4 NE 1/4                    8.2 ACRES  
 SECTION 11  
 T 9 S, R 40 E, W.M.

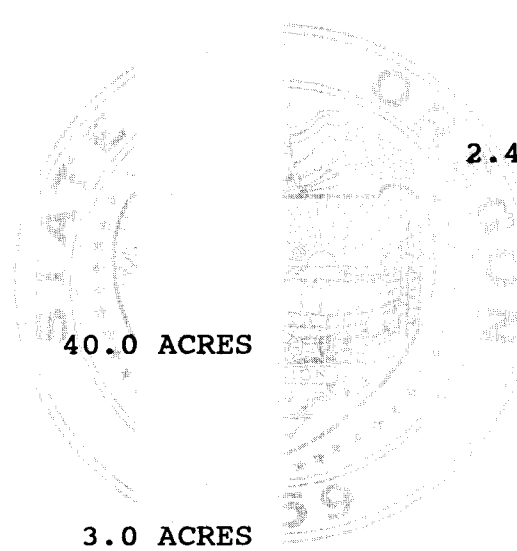

CRUTCHER

NE 1/4 SE 1/4                    5.0 ACRES  
 SECTION 29  
 T 9 S, R 40 E, W.M.

DAILEY

SE 1/4 SW 1/4                    14.0 ACRES  
 NE 1/4 SW 1/4                    10.0 ACRES                    25.0 ACRES  
 SW 1/4 SE 1/4                    14.2 ACRES  
 NW 1/4 SE 1/4                    8.0 ACRES                    5.0 ACRES  
 SECTION 25  
 T 8 S, R 39 E, W.M.

DAVIS

SW 1/4 SW 1/4                    40.0 ACRES  
 SECTION 26  
 SE 1/4 SE 1/4                    8.6 ACRES  
 SECTION 27  
 NE 1/4 NW 1/4                    40.0 ACRES  
 SE 1/4 NW 1/4                    40.0 ACRES  
 SECTION 35  
 T 8 S, R 40 E, W.M.

DIEUDOME

NW 1/4 NE 1/4                    37.6 ACRES  
 NE 1/4 NW 1/4                    40.0 ACRES  
 SE 1/4 NW 1/4                    36.8 ACRES  
 SW 1/4 SE 1/4                    18.4 ACRES  
 NW 1/4 SE 1/4                    6.8 ACRES  
 SECTION 18  
 T 8 S, R 40 E, W.M.

DRIGGERS

SE 1/4 SE 1/4                    40.0 ACRES  
 SECTION 34  
 T 8 S, R 40 E, W.M.

DOYLE

SW 1/4 NE 1/4                    0.4 ACRE  
 NW 1/4 SE 1/4                    17.5 ACRES                    3.3 ACRES  
 NE 1/4 SW 1/4                    14.1 ACRES  
 SECTION 17  
 NE 1/4 NE 1/4                    2.6 ACRES  
 NW 1/4 NE 1/4                    0.6 ACRE  
 SECTION 19  
 T 10 S, R 40 E, W.M.

DYKE

SW 1/4 SW 1/4                    8.0 ACRES  
 NW 1/4 SW 1/4                    12.4 ACRES  
 SECTION 34  
 T 8 S, R 40 E, W.M.

ENTERMILLE

NW 1/4 SW 1/4                    26.0 ACRES  
 SECTION 7  
 T 9 S, R 40 E, W.M.

ERRANDS

NW 1/4 SE 1/4		39.2 ACRES	
NE 1/4 NE 1/4		38.4 ACRES	
SE 1/4 NE 1/4		38.6 ACRES	
SECTION 22			
T 8 S, R 40 E,	W.M.		

FARMER'S NAT.

NE 1/4 NE 1/4	1.3 ACRES		
SE 1/4 NE 1/4		1.3 ACRES	
SE 1/4 SE 1/4	18.8 ACRES		
SW 1/4 SE 1/4	0.5 ACRE		
SECTION 25			
NE 1/4 NE 1/4		26.8 ACRES	
NW 1/4 NE 1/4	1.1 ACRES		
SE 1/4 NE 1/4	9.2 ACRES		
SECTION 36			
T 7 S, R 39 E,	W.M.		

SE 1/4 SE 1/4	23.5 ACRES		
SECTION 31			
SW 1/4 SW 1/4	37.8 ACRES		
SECTION 32			
T 7 S, R 40 E,	W.M.		

FENNIMORE

NW 1/4 SW 1/4	1.0 ACRE	40.0 ACRES	
NE 1/4 SW 1/4		38.2 ACRES	
SW 1/4 SW 1/4	0.4 ACRE	40.0 ACRES	
SE 1/4 SW 1/4		37.1 ACRES	
SECTION 22			
T 8 S, R 40 E,	W.M.		

FLINT

SW 1/4 NE 1/4		5.0 ACRES	
SECTION 2			
T 9 S, R 40 E,	W.M.		

FOSTER

SE 1/4 NE 1/4		1.3 ACRES	
SW 1/4 NE 1/4		4.5 ACRES	
NE 1/4 SE 1/4		1.1 ACRES	
NW 1/4 SE 1/4		2.5 ACRES	
SW 1/4 SE 1/4		8.4 ACRES	
SW 1/4 NW 1/4		24.4 ACRES	
SE 1/4 NW 1/4			13.2 ACRES
NW 1/4 SW 1/4		11.6 ACRES	
NE 1/4 SW 1/4			2.2 ACRES
SE 1/4 SW 1/4		28.0 ACRES	
SW 1/4 SW 1/4		10.4 ACRES	
SECTION 5			
SE 1/4 SE 1/4	4.0 ACRES		
SECTION 6			
NW 1/4 NE 1/4		17.3 ACRES	
SW 1/4 NE 1/4		0.1 ACRE	
SECTION 8			
T 10 S, R 40 E,	W.M.		



GRADNER

NE 1/4 SW 1/4 20.0 ACRES  
 SE 1/4 SW 1/4 20.0 ACRES  
 SECTION 13  
 T 8 S, R 39 E, W.M.

GOVER

NE 1/4 SW 1/4 9.0 ACRES  
 SECTION 3  
 T 9 S, R 40 E, W.M.

GRABNER

NE 1/4 NW 1/4 37.5 ACRES  
 SE 1/4 SE 1/4 39.0 ACRES  
 NE 1/4 SE 1/4 40.0 ACRES  
 SE 1/4 NW 1/4 12.0 ACRES  
 SECTION 25  
 T 8 S, R 39 E, W.M.

NW 1/4 SW 1/4 40.0 ACRES  
 NE 1/4 SW 1/4 40.0 ACRES  
 SW 1/4 SW 1/4 40.0 ACRES  
 SE 1/4 SW 1/4 40.0 ACRES  
 SECTION 30  
 T 8 S, R 40 E, W.M.

GYLLENBERG

SE 1/4 NE 1/4 3.0 ACRES  
 SW 1/4 NE 1/4 0.6 ACRE  
 NE 1/4 SE 1/4 13.2 ACRES  
 SE 1/4 SE 1/4 2.3 ACRES  
 SW 1/4 SE 1/4 1.0 ACRE  
 NW 1/4 SE 1/4 4.1 ACRES  
 SECTION 18  
 T 10 S, R 40 E, W.M.

HARRELL

SW 1/4 SE 1/4 14.6 ACRES  
 SECTION 12  
 T 9 S, R 39 E, W.M.

HARRISON

NW 1/4 NW 1/4 40.0 ACRES  
 NE 1/4 NW 1/4 40.0 ACRES  
 SW 1/4 NW 1/4 40.0 ACRES  
 SE 1/4 NW 1/4 3.6 ACRES  
 SECTION 17  
 T 8 S, R 40 E, W.M.

HEATON

SE 1/4 NE 1/4 39.2 ACRES  
 SW 1/4 NE 1/4 32.8 ACRES  
 SECTION 34  
 T 8 S, R 40 E, W.M.

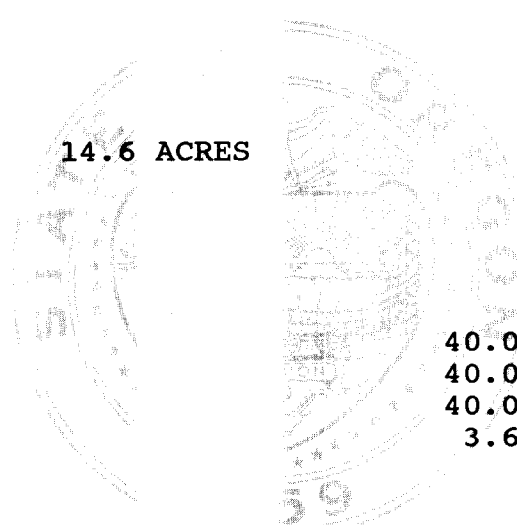

INNES

SE 1/4 SW 1/4	40.0 ACRES	
SW 1/4 SW 1/4	40.0 ACRES	
SECTION 3		
SE 1/4 NE 1/4	5.3 ACRES	
NE 1/4 SE 1/4		10.0 ACRES
SECTION 10		
SE 1/4 NW 1/4	17.6 ACRES	
SW 1/4 NW 1/4	17.6 ACRES	
NE 1/4 SW 1/4	40.0 ACRES	
NW 1/4 SW 1/4	40.0 ACRES	
SECTION 11		
SE 1/4 NW 1/4		35.0 ACRES
SW 1/4 NW 1/4		35.0 ACRES
NW 1/4 NW 1/4		30.0 ACRES
SECTION 14		
SW 1/4 SE 1/4		40.0 ACRES
NE 1/4 SE 1/4		20.0 ACRES
NW 1/4 SE 1/4		40.0 ACRES
SE 1/4 SE 1/4		20.0 ACRES
SECTION 15		
T 8 S, R 40 E, W.M.		

JACOBS

SW 1/4 SW 1/4	40.0 ACRES	
SE 1/4 SW 1/4	40.0 ACRES	
SECTION 19		
NW 1/4 NW 1/4	40.0 ACRES	
NE 1/4 NW 1/4	40.0 ACRES	
SW 1/4 NW 1/4	40.0 ACRES	
SE 1/4 NW 1/4	40.0 ACRES	
SECTION 30		
T 8 S, R 40 E, W.M.		

JENSEN

NW 1/4 NW 1/4		0.2 ACRE
SECTION 17		
NE 1/4 NE 1/4		20.9 ACRES
SECTION 18		
T 10 S, R 40 E, W.M.		

JUSTUS

NW 1/4 NE 1/4	7.1 ACRES	
SW 1/4 NE 1/4	36.5 ACRES	
NW 1/4 SE 1/4		40.0 ACRES
SW 1/4 SE 1/4		39.4 ACRES
NW 1/4 NW 1/4		19.9 ACRES
NE 1/4 NW 1/4		18.4 ACRES
SW 1/4 NW 1/4		38.8 ACRES
SE 1/4 NW 1/4		34.0 ACRES
SECTION 23		
T 8 S, R 40 E, W.M.		

KLECK

NW 1/4 NW 1/4	20.0 ACRES	10.0 ACRES
SECTION 3		
NE 1/4 NE 1/4		30.0 ACRES
SE 1/4 NE 1/4		27.0 ACRES
SECTION 4		
T 9 S, R 40 E, W.M.		

LAEGER

SE 1/4 NE 1/4 40.0 ACRES  
 SW 1/4 NE 1/4 8.4 ACRES  
 SECTION 33  
 T 8 S, R 40 E, W.M.

LANGLITZ

NW 1/4 NE 1/4 3.0 ACRES  
 NW 1/4 NW 1/4 5.0 ACRES 9.2 ACRES  
 SW 1/4 NW 1/4 5.0 ACRES 6.3 ACRES  
 SECTION 28  
 T 8 S, R 40 E, W.M.

LAZY J

NE 1/4 SE 1/4 0.5 ACRE  
 SECTION 36  
 T 7 S, R 39 E, W.M.  
  
 SW 1/4 SE 1/4 18.0 ACRES  
 SE 1/4 SW 1/4 12.0 ACRES  
 SECTION 31  
 T 7 S, R 40 E, W.M.

SE 1/4 NE 1/4 3.4 ACRES  
 NE 1/4 SE 1/4 25.6 ACRES  
 SW 1/4 SE 1/4 39.8 ACRES  
 SE 1/4 SE 1/4 40.0 ACRES  
 SECTION 1  
 SW 1/4 SW 1/4 25.0 ACRES  
 SECTION 2  
 NE 1/4 NE 1/4 25.7 ACRES  
 NW 1/4 NE 1/4 37.2 ACRES  
 NE 1/4 NW 1/4 38.6 ACRES  
 NW 1/4 NW 1/4 15.0 ACRES  
 SECTION 12  
 SE 1/4 SW 1/4 20.0 ACRES  
 NE 1/4 SW 1/4 20.0 ACRES  
 SE 1/4 NW 1/4 40.0 ACRES  
 NE 1/4 NE 1/4 38.8 ACRES  
 SE 1/4 NE 1/4 40.0 ACRES  
 SW 1/4 NE 1/4 40.0 ACRES  
 SE 1/4 SE 1/4 40.0 ACRES  
 NE 1/4 SE 1/4 40.0 ACRES  
 SW 1/4 SE 1/4 40.0 ACRES  
 NW 1/4 SE 1/4 40.0 ACRES  
 SECTION 13  
 T 8 S, R 39 E, W.M.

NW 1/4 NE 1/4 18.9 ACRES  
 NE 1/4 NW 1/4 1.0 ACRE  
 SECTION 5  
 SW 1/4 NW 1/4 23.2 ACRES  
 NW 1/4 SW 1/4 30.8 ACRES  
 SECTION 6  
 NW 1/4 NW 1/4 8.0 ACRES  
 NE 1/4 NW 1/4 11.3 ACRES  
 SE 1/4 NW 1/4 7.6 ACRES  
 NW 1/4 NE 1/4 21.2 ACRES  
 NE 1/4 NE 1/4 11.6 ACRES  
 SE 1/4 NE 1/4 3.6 ACRES  
 SW 1/4 NE 1/4 1.8 ACRES  
 SECTION 7  
 T 8 S, R 40 E, W.M.

LAZY J TANGO REAL ESTATE

NW 1/4 NE 1/4 6.0 ACRES 30.0 ACRES 4.0 ACRES  
 SW 1/4 NE 1/4 2.0 ACRES 36.6 ACRES  
 SECTION 24  
 T 8 S, R 39 E, W.M.

NW 1/4 NW 1/4 40.0 ACRES  
 NE 1/4 NW 1/4 39.0 ACRES  
 SW 1/4 NE 1/4 30.0 ACRES  
 SE 1/4 NE 1/4 16.0 ACRES  
 NW 1/4 NE 1/4 5.1 ACRES  
 SE 1/4 NW 1/4 28.0 ACRES  
 SW 1/4 NW 1/4 9.0 ACRES  
 SECTION 5  
 NW 1/4 NW 1/4 10.0 ACRES 8.0 ACRES  
 NE 1/4 NW 1/4 40.0 ACRES  
 SW 1/4 NW 1/4 12.8 ACRES  
 SE 1/4 NW 1/4 15.0 ACRES 3.0 ACRES  
 NW 1/4 NE 1/4 40.0 ACRES  
 NE 1/4 NE 1/4 40.0 ACRES  
 SECTION 6  
 T 8 S, R 40 E, W.M.

LEMMON

SE 1/4 NE 1/4 22.0 ACRES  
 SECTION 32  
 T 8 S, R 40 E, W.M.

LEONARD

SW 1/4 SW 1/4 7.7 ACRES  
 SECTION 3  
 T 9 S, R 40 E, W.M.

LINDSAY

NE 1/4 NW 1/4 37.0 ACRES  
 SE 1/4 NW 1/4 17.8 ACRES  
 NW 1/4 NE 1/4 24.4 ACRES  
 SW 1/4 NE 1/4 40.0 ACRES  
 SE 1/4 NE 1/4 18.8 ACRES  
 NE 1/4 SE 1/4 39.2 ACRES  
 SECTION 29  
 T 7 S, R 40 E, W.M.

MCCORD

SW 1/4 SW 1/4 30.4 ACRES  
 SECTION 35  
 T 8 S, R 40 E, W.M.  
 NW 1/4 NW 1/4 20.6 ACRES  
 SECTION 2  
 NE 1/4 NE 1/4 7.0 ACRES  
 SE 1/4 NE 1/4 29.2 ACRES  
 SECTION 3  
 T 9 S, R 40 E, W.M.

MCENROE

SW 1/4 NE 1/4 9.5 ACRES 9.3 ACRES  
 SECTION 4  
 T 9 S, R 40 E, W.M.

McKITTRICK

NE 1/4 NE 1/4	4.8 ACRES	3.6 ACRES
SE 1/4 SE 1/4		9.0 ACRES
SECTION 7		
NE 1/4 NW 1/4		34.0 ACRES
SE 1/4 NW 1/4	13.3 ACRES	26.3 ACRES
SW 1/4 NW 1/4		5.6 ACRES
NE 1/4 SW 1/4	12.0 ACRES	22.4 ACRES
NW 1/4 SW 1/4		35.0 ACRES
SE 1/4 SW 1/4	2.0 ACRES	10.5 ACRES
SW 1/4 SW 1/4		35.0 ACRES
SECTION 8		
T 10 S, R 40 E, W.M.		

MARLOW

SE 1/4 NE 1/4		16.4 ACRES
SECTION 10		
T 9 S, R 40 E, W.M.		

MARSH

SE 1/4 NE 1/4	1.2 ACRES	
SW 1/4 NE 1/4	1.0 ACRES	
NW 1/4 SE 1/4		11.6 ACRES
SECTION 32		
T 9 S, R 40 E, W.M.		

MILES

SE 1/4 NE 1/4	8.8 ACRES
SW 1/4 NE 1/4	7.4 ACRES
NE 1/4 SE 1/4	36.9 ACRES
NW 1/4 SE 1/4	22.3 ACRES
SECTION 4	
T 8 S, R 40 E, W.M.	

MILLER & COSBY

SW 1/4 NE 1/4	2.0 ACRES
SECTION 17	
T 10 S, R 40 E, W.M.	

MORRIS

SW 1/4 NW 1/4	2.5 ACRES	
SW 1/4 SW 1/4		18.3 ACRES
SECTION 2		
T 9 S, R 40 E, W.M.		

NASH

SE 1/4 SW 1/4		20.0 ACRES
NE 1/4 SW 1/4		40.0 ACRES
SECTION 23		
T 8 S, R 40 E, W.M.		

NESKE

NE 1/4 SE 1/4	8.8 ACRES
SECTION 33	
T 7 S, R 40 E, W.M.	

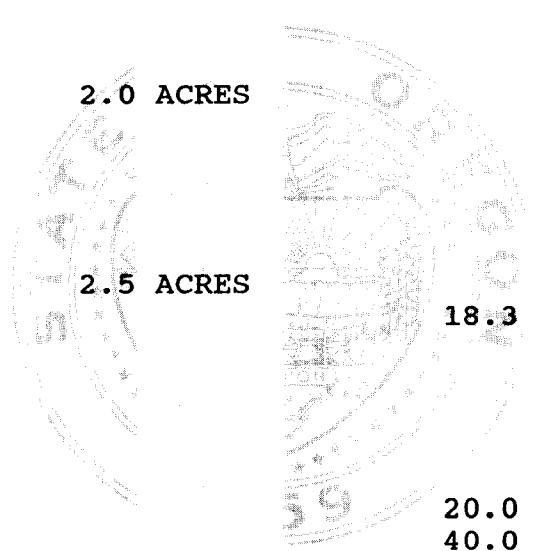

OLIVER

NE 1/4 NE 1/4 1.8 ACRES  
 SECTION 21  
 T 9 S, R 40 E, W.M.

OSBORN

NE 1/4 NE 1/4 40.0 ACRES  
 SE 1/4 NE 1/4 5.2 ACRES  
 SECTION 18  
 NE 1/4 SE 1/4 23.2 ACRES  
 SE 1/4 SE 1/4 34.0 ACRES  
 NW 1/4 SE 1/4 8.5 ACRES  
 SE 1/4 SW 1/4 10.5 ACRES  
 SW 1/4 SW 1/4 21.0 ACRES  
 NE 1/4 SW 1/4 25.2 ACRES  
 NW 1/4 SW 1/4 35.0 ACRES  
 SECTION 29  
 NE 1/4 NE 1/4 20.0 ACRES 20.0 ACRES  
 NW 1/4 NE 1/4 15.0 ACRES 25.0 ACRES  
 SE 1/4 NE 1/4 20.0 ACRES 20.0 ACRES  
 SW 1/4 NE 1/4 10.0 ACRES 30.0 ACRES  
 NE 1/4 SE 1/4 40.0 ACRES  
 SW 1/4 SE 1/4 39.6 ACRES  
 SE 1/4 SE 1/4 40.0 ACRES  
 NW 1/4 SE 1/4 40.0 ACRES  
 SECTION 30  
 T 8 S, R 40 E, W.M.

HODNEFIELD

NW 1/4 NW 1/4 40.0 ACRES  
 NE 1/4 NW 1/4 40.0 ACRES  
 SE 1/4 NW 1/4 5.0 ACRES 35.0 ACRES  
 SW 1/4 NW 1/4 5.0 ACRES 35.0 ACRES  
 SECTION 29  
 T 8 S, R 40 E, W.M.

PAYTON, JOHN

SE 1/4 SW 1/4 7.0 ACRES  
 SW 1/4 SE 1/4 20.0 ACRES  
 SECTION 3  
 NE 1/4 NW 1/4 2.0 ACRES  
 NW 1/4 NE 1/4 37.0 ACRES  
 SW 1/4 NE 1/4 18.0 ACRES  
 SE 1/4 NE 1/4 40.0 ACRES  
 SECTION 10  
 SW 1/4 NE 1/4 9.5 ACRES  
 SE 1/4 NW 1/4 5.0 ACRES  
 SECTION 14  
 T 8 S, R 39 E, W.M.

SPURLOCK

SE 1/4 SE 1/4 4.0 ACRES 14.0 ACRES  
 NE 1/4 SE 1/4 37.0 ACRES  
 NW 1/4 SE 1/4 2.0 ACRES  
 SECTION 10

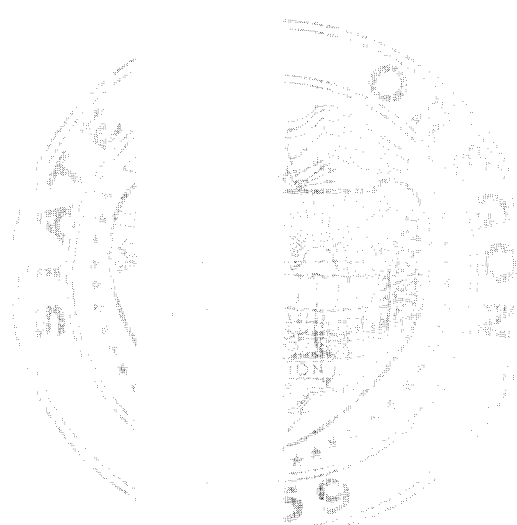

SPURLOCK con't

SW 1/4 SE 1/4		25.6 ACRES
SW 1/4 SW 1/4		24.0 ACRES
NW 1/4 SW 1/4		27.3 ACRES
NE 1/4 SW 1/4		30.3 ACRES
SE 1/4 SW 1/4		10.8 ACRES
NE 1/4 SE 1/4	1.3 ACRES	
NW 1/4 SE 1/4		30.6 ACRES
SECTION 11		
NW 1/4 NW 1/4		9.5 ACRES
NW 1/4 NE 1/4		17.5 ACRES
SW 1/4 NE 1/4		12.5 ACRES
NE 1/4 NW 1/4		31.7 ACRES
SE 1/4 NW 1/4		9.0 ACRES
NE 1/4 SE 1/4		3.9 ACRES
SECTION 14		
T 8 S, R 39 E, W.M.		

PERKINS

NE 1/4 SW 1/4	23.8 ACRES	15.0 ACRES
NW 1/4 SW 1/4	0.7 ACRE	40.0 ACRES
SW 1/4 SW 1/4	36.0 ACRES	5.0 ACRES
SE 1/4 SW 1/4	0.6 ACRE	35.0 ACRES
SECTION 9		
NW 1/4 NW 1/4	2.0 ACRES	40.0 ACRES
NE 1/4 NW 1/4	2.0 ACRES	29.3 ACRES
SECTION 16		
T 8 S, R 40 E, W.M.		

PEYRON

SE 1/4 SE 1/4	6.0 ACRES	
SW 1/4 SE 1/4	10.0 ACRES	
SW 1/4 SW 1/4		21.0 ACRES
SE 1/4 SW 1/4		40.0 ACRES
SW 1/4 SW 1/4		18.0 ACRES
NE 1/4 SW 1/4		40.0 ACRES
NW 1/4 SW 1/4		39.0 ACRES
SECTION 25		
NW 1/4 NE 1/4		10.0 ACRES
SW 1/4 NE 1/4		15.0 ACRES
SECTION 35		
NE 1/4 NE 1/4	5.2 ACRES	
NW 1/4 NE 1/4	1.2 ACRES	38.8 ACRES
SW 1/4 NE 1/4		26.5 ACRES
SE 1/4 NE 1/4		24.9 ACRES
NE 1/4 NW 1/4		40.0 ACRES
NW 1/4 NW 1/4		39.0 ACRES
SW 1/4 NW 1/4		38.6 ACRES
SE 1/4 NW 1/4		39.8 ACRES
NE 1/4 SW 1/4		33.4 ACRES
SE 1/4 SW 1/4		1.3 ACRES
SW 1/4 SW 1/4		19.3 ACRES
NW 1/4 SW 1/4		38.8 ACRES
SECTION 36		
T 8 S, R 40 E, W.M.		
SW 1/4 SW 1/4	0.3 ACRE	
SECTION 30		
NW 1/4 NW 1/4	2.8 ACRES	
SW 1/4 NW 1/4	5.0 ACRES	4.4 ACRES
SECTION 31		
T 8 S, R 41 E, W.M.		

PHILLIPS

SE 1/4 SW 1/4	20.0 ACRES	
NW 1/4 NW 1/4	28.0 ACRES	9.0 ACRES
SE 1/4 NW 1/4		8.5 ACRES
SW 1/4 NW 1/4	23.0 ACRES	3.4 ACRES
NW 1/4 SW 1/4	24.0 ACRES	
SW 1/4 SW 1/4	39.0 ACRES	

SECTION 25

NE 1/4 NE 1/4	38.0 ACRES
NW 1/4 NE 1/4	39.4 ACRES
SE 1/4 NE 1/4	39.4 ACRES
SW 1/4 NE 1/4	37.4 ACRES
NW 1/4 NW 1/4	40.0 ACRES
NE 1/4 NW 1/4	38.8 ACRES

SECTION 36

T 8 S, R 39 E, W.M.

NW 1/4 NW 1/4	40.0 ACRES
NE 1/4 NW 1/4	25.0 ACRES
SW 1/4 NW 1/4	37.4 ACRES
SE 1/4 NW 1/4	21.2 ACRES

SECTION 31

T 8 S, R 40 E, W.M.

PITTS

NW 1/4 SW 1/4	2.0 ACRES	
SW 1/4 NW 1/4		20.0 ACRES
NW 1/4 NW 1/4		5.2 ACRES

SECTION 28

T 9 S, R 40 E, W.M.

PRIEST

NW 1/4 NW 1/4	4.0 ACRES
---------------	-----------

SECTION 8

T 9 S, R 40 E, W.M.

PROWELL

NW 1/4 NE 1/4	28.5 ACRES	
SW 1/4 NE 1/4	17.2 ACRES	
SE 1/4 NE 1/4	4.8 ACRES	
NE 1/4 SE 1/4	1.4 ACRES	2.8 ACRES
NW 1/4 SE 1/4		32.9 ACRES
SW 1/4 SE 1/4		22.2 ACRES
SE 1/4 SW 1/4		29.8 ACRES
NE 1/4 SW 1/4		13.0 ACRES

SECTION 24

NW 1/4 SE 1/4		8.8 ACRES
NW 1/4 NE 1/4	6.0 ACRES	
SW 1/4 SE 1/4	9.2 ACRES	

SECTION 25

T 8 S, R 40 E, W.M.

RASMUSSEN

SW 1/4 NW 1/4	6.0 ACRES	5.6 ACRES
SE 1/4 NW 1/4		14.0 ACRES

SECTION 25

T 8 S, R 39 E, W.M.



SACKOS

NW 1/4 SE 1/4 SECTION 14	31.5 ACRES	
NE 1/4 NE 1/4 SECTION 24		40.0 ACRES
T 8 S, R 39 E, W.M.		
NW 1/4 SW 1/4		40.0 ACRES
SW 1/4 SW 1/4		40.0 ACRES
NW 1/4 NW 1/4		40.0 ACRES
SW 1/4 NW 1/4		40.0 ACRES
SECTION 18		
T 8 S, R 40 E, W.M.		

SCHAAN

NW 1/4 NE 1/4		14.0 ACRES
SE 1/4 NE 1/4		4.0 ACRES
SECTION 18		
T 9 S, R 40 E, W.M.		

SHERMAN

NW 1/4 SE 1/4 SECTION 3	7.0 ACRES	
T 8 S, R 40 E, W.M.		

SHUMWAY

SE 1/4 NW 1/4 SECTION 2		26.7 ACRES
T 9 S, R 40 E, W.M.		

SPENCE

SE 1/4 SE 1/4		29.7 ACRES
NE 1/4 SE 1/4		29.0 ACRES
SECTION 7		
SE 1/4 NW 1/4 SECTION 28	16.4 ACRES	2.1 ACRES
T 8 S, R 40 E, W.M.		

STEELE

SW 1/4 SW 1/4		40.0 ACRES
NW 1/4 SW 1/4		40.0 ACRES
SECTION 36		
T 8 S, R 39 E, W.M.		
NW 1/4 NW 1/4	1.4 ACRES	40.0 ACRES
SW 1/4 NW 1/4	10.0 ACRES	8.3 ACRES
SECTION 1		
T 9 S, R 39 E, W.M.		

STILTNER

SE 1/4 SE 1/4 SECTION 22		2.9 ACRES
SE 1/4 SW 1/4 SECTION 23		20.0 ACRES
T 8 S, R 40 E, W.M.		

TACHENKO

SE 1/4 SE 1/4                    23.6 ACRES  
SECTION 2  
T 9 S, R 40 E, W.M.

TETRAULT

SW 1/4 SE 1/4                    25.6 ACRES  
SECTION 2  
NE 1/4 NE 1/4                    14.4 ACRES  
SE 1/4 NE 1/4                    27.1 ACRES  
NE 1/4 SE 1/4                    30.2 ACRES  
SE 1/4 SE 1/4                    38.9 ACRES  
SW 1/4 SE 1/4                    37.2 ACRES  
SECTION 11  
T 8 S, R 40 E, W.M.

THOMAS

NW 1/4 SW 1/4                    12.8 ACRES  
NE 1/4 SW 1/4                    40.0 ACRES  
SE 1/4 SW 1/4                    11.2 ACRES  
NW 1/4 SE 1/4                    24.5 ACRES  
SW 1/4 SE 1/4                    27.8 ACRES  
SW 1/4 SW 1/4                    3.0 ACRES  
SECTION 33  
T 8 S, R 40 E, W.M.

WALTER

SW 1/4 SE 1/4                    5.2 ACRES  
SE 1/4 SE 1/4                    19.6 ACRES  
SECTION 27  
T 8 S, R 40 E, W.M.

WARD, CHARLES

NW 1/4 NW 1/4                    9.0 ACRES  
NE 1/4 NW 1/4                    1.7 ACRES  
SECTION 3  
T 9 S, R 40 E, W.M.

WARDS

SE 1/4 SE 1/4                    24.5 ACRES  
NE 1/4 SE 1/4                    30.2 ACRES  
SECTION 22  
SW 1/4 SW 1/4                    40.0 ACRES  
NW 1/4 SW 1/4                    40.0 ACRES  
SECTION 23  
SW 1/4 NE 1/4                    38.8 ACRES  
SE 1/4 NW 1/4                    39.4 ACRES  
NE 1/4 NW 1/4                    39.6 ACRES  
SW 1/4 SE 1/4                    39.3 ACRES  
NW 1/4 SE 1/4                    39.8 ACRES  
SE 1/4 SW 1/4                    38.6 ACRES  
NE 1/4 SW 1/4                    39.6 ACRES  
NW 1/4 SW 1/4                    40.0 ACRES  
NW 1/4 NW 1/4                    40.0 ACRES  
NW 1/4 NE 1/4                    39.2 ACRES  
SW 1/4 NW 1/4                    40.0 ACRES  
SECTION 26

WARDS con't

NE 1/4 NE 1/4		29.0 ACRES
NE 1/4 SE 1/4		40.0 ACRES
SE 1/4 NE 1/4		29.0 ACRES
SECTION 27		
NE 1/4 NE 1/4	18.0 ACRES	22.0 ACRES
NW 1/4 NE 1/4	13.0 ACRES	27.0 ACRES
SE 1/4 NE 1/4	27.0 ACRES	13.0 ACRES
SW 1/4 NE 1/4	20.0 ACRES	20.0 ACRES
SECTION 31		
NW 1/4 NW 1/4		35.0 ACRES
SW 1/4 NW 1/4		35.0 ACRES
NE 1/4 NW 1/4		40.0 ACRES
SE 1/4 NW 1/4		40.0 ACRES
SECTION 32		
NW 1/4 SW 1/4	20.0 ACRES	
NE 1/4 SW 1/4		20.0 ACRES
SW 1/4 NW 1/4		40.0 ACRES
SE 1/4 NW 1/4		40.0 ACRES
SECTION 34		

T 8 S, R 40 E, W.M.

SE 1/4 SE 1/4		11.5 ACRES
NE 1/4 SE 1/4		20.0 ACRES

T 9 S, R 39 E, W.M.

NW 1/4 NW 1/4		7.8 ACRES
SW 1/4 NW 1/4		27.8 ACRES
NW 1/4 NE 1/4		5.7 ACRES
NW 1/4 SW 1/4		40.0 ACRES
NE 1/4 SW 1/4		7.2 ACRES
NE 1/4 NW 1/4		40.0 ACRES
SECTION 6		
SW 1/4 SW 1/4		10.0 ACRES

T 9 S, R 40 E, W.M.

WARNER

SE 1/4 NE 1/4		10.5 ACRES
NE 1/4 SE 1/4		4.1 ACRES
SECTION 12		
T 8 S, R 39 E, W.M.		
SE 1/4 SW 1/4		15.4 ACRES
SW 1/4 SE 1/4		16.1 ACRES
SW 1/4 NW 1/4		14.8 ACRES
NW 1/4 SW 1/4		32.8 ACRES
SW 1/4 SW 1/4		36.6 ACRES
SECTION 7		
NE 1/4 NW 1/4	39.5 ACRES	
NW 1/4 NE 1/4	6.1 ACRES	
SW 1/4 NE 1/4	22.8 ACRES	
SECTION 8		

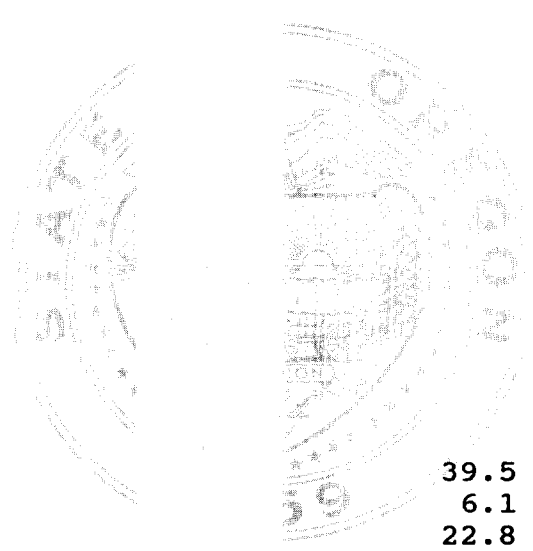

WARNER con't

NW 1/4 NW 1/4		35.8 ACRES
NE 1/4 NW 1/4		39.4 ACRES
NW 1/4 NE 1/4	17.2 ACRES	
SW 1/4 NW 1/4		7.7 ACRES
SE 1/4 NW 1/4		10.3 ACRES
NE 1/4 NE 1/4		17.9 ACRES
SW 1/4 NE 1/4		28.8 ACRES
SE 1/4 NE 1/4		35.0 ACRES
NE 1/4 SE 1/4	10.0 ACRES	28.1 ACRES
SE 1/4 SE 1/4		38.6 ACRES
SW 1/4 SE 1/4		29.8 ACRES
SE 1/4 SW 1/4	1.3 ACRES	
SECTION 9		
NW 1/4 SW 1/4		31.2 ACRES
SW 1/4 NW 1/4		13.3 ACRES
SW 1/4 SW 1/4		38.0 ACRES
SECTION 10		
NW 1/4 NE 1/4		15.9 ACRES
NE 1/4 NE 1/4		38.0 ACRES
SE 1/4 NE 1/4		38.0 ACRES
SW 1/4 NE 1/4		3.6 ACRES
SECTION 16		
NE 1/4 SW 1/4		40.0 ACRES
SE 1/4 SW 1/4		40.0 ACRES
SECTION 18		
NW 1/4 NE 1/4		8.7 ACRES
SW 1/4 NE 1/4		16.8 ACRES
NE 1/4 NW 1/4		10.3 ACRES
SE 1/4 NW 1/4		10.3 ACRES
SECTION 21		
NE 1/4 NW 1/4	0.4 ACRE	14.6 ACRES
SECTION 28		
T 8 S, R 40 E, W.M.		

WATSON

SE 1/4 SE 1/4		37.5 ACRES
SW 1/4 SE 1/4		40.0 ACRES
SECTION 36		
T 8 S, R 39 E, W.M.		
NW 1/4 NE 1/4		20.0 ACRES
SECTION 1		
T 9 S, R 39 E, W.M.		

WELLMAN

SE 1/4 SW 1/4		23.8 ACRES
SW 1/4 SE 1/4		13.5 ACRES
SE 1/4 SE 1/4		25.8 ACRES
SECTION 8		
T 8 S, R 40 E, W.M.		

WHITSETT

SE 1/4 SW 1/4		3.0 ACRES
SE 1/4 SE 1/4		1.0 ACRE
SW 1/4 SE 1/4		22.0 ACRES
SECTION 25		
T 8 S, R 39 E, W.M.		

WIDMAN, J.

NW 1/4 NW 1/4		11.0 ACRES
NE 1/4 NW 1/4	2.0 ACRES	
NW 1/4 SE 1/4		16.0 ACRES
NE 1/4 SE 1/4		2.0 ACRES
SECTION 4		
T 9 S, R 40 E, W.M.		

WIDMAN M.

NW 1/4 SW 1/4		0.1 ACRE
SW 1/4 SW 1/4		13.6 ACRES
SECTION 28		
NE 1/4 NE 1/4		19.3 ACRES
SECTION 32		
NW 1/4 NW 1/4		9.2 ACRES
NE 1/4 NW 1/4		24.4 ACRES
NW 1/4 NE 1/4		20.0 ACRES
SECTION 33		
T 8 S, R 40 E, W.M.		

WILLIAMS

SW 1/4 SW 1/4		40.0 ACRES
SE 1/4 SW 1/4		15.5 ACRES
NE 1/4 SW 1/4		32.6 ACRES
NW 1/4 SW 1/4		39.1 ACRES
SECTION 31		
T 8 S, R 40 E, W.M.		

WILSON

SW 1/4 NW 1/4		12.9 ACRES
SECTION 11		
T 9 S, R 40 E, W.M.		

WIRTH

NE 1/4 NE 1/4		21.1 ACRES
SW 1/4 NE 1/4		8.7 ACRES
SE 1/4 NE 1/4		27.0 ACRES
NW 1/4 NE 1/4		0.9 ACRE
SECTION 21		
T 8 S, R 40 E, W.M.		

WRIGHT

NE 1/4 SW 1/4		15.6 ACRES
SECTION 21		
T 8 S, R 40 E, W.M.		

CASTNER DITCH

SW 1/4 NW 1/4		3.0 ACRES
NW 1/4 SW 1/4		2.0 ACRES
SECTION 17		
T 9 S, R 40 E, W.M.		

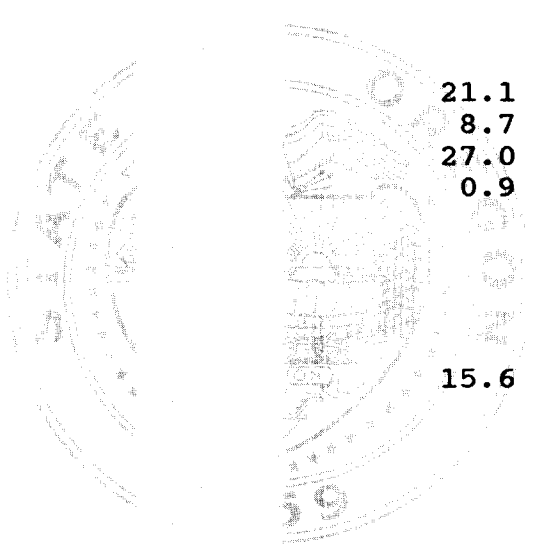

Actual construction work shall begin on or before August 21, 1990, and shall be completed on or before October 1, 1991. Complete application of the water to the use shall be made on or before October 1, 1992.

This permit is for the beneficial use of water without waste. By law, the land use associated with this water use must be in compliance with statewide land-use goals and any local acknowledged land-use plan.

The use granted herein may be made only at times when sufficient water is available to satisfy all prior rights, including rights for maintaining instream flows.

Issued this date, August 21, 1989.

/s/ WILLIAM H. YOUNG

---

Water Resources Department  
William H. Young  
Director

APPLICATION 62167.SB

