

CERTIFICATE NO. 896*Permit No. 538

ABSTRACT MADE

APPLICATION FOR A PERMIT TO APPROPRIATE THE PUBLIC WATERS OF THE STATE OF OREGON

I, F. W. Neasly.....
(Name of Applicant)

of Freewater....., County of Umatilla.....
(Postoffice)

State of Oregon....., do hereby make application for a permit to appropriate
the following described public waters of the State of Oregon, subject to existing rights.

If the applicant is a corporation, give date and place of incorporation.....

1. The source of the proposed appropriation is Little Walla Walla River.....
(Name of stream)

2. The amount of water which the applicant intends to apply to beneficial use is.....
one ^{foot} ~~cubic feet~~ per second.

3. The use to which the water is to be applied is Irrigation (Winter irrigation only.....
(Irrigation, power, mining, manufacturing,
using surplus flood water through existing ditches).....
domestic supplies, etc.)

4. The point of diversion is located 13 rods East of the S. E. corner of the N. W. 1/4.....
(Give distance and bearing to section corner)
of the N. W. 1/4 of section 35, Twp. 6, N. Range 35 E. W. M.

being within the N. E. 1/4 of the N. W. 1/4 of Sec. 35....., Tp. 6 N.....
(Give smallest legal subdivision) (No. N. or S.)

R. 35..... E., W. M., in the County of Umatilla.....
(No. E. or W.)

5. The Main ditch is to be 1/2.....
(Main ditch, canal or pipe line)

miles in length, terminating in the S. E. 1/4 of the S. E. 1/4 of Sec. 27....., Tp. 6 N......
(Smallest legal subdivision) (No. N. or S.)

R. 35 E......, W. M., the proposed location being shown throughout on the accompanying map.
(No. E. or W.)

6. The name of the ditch, canal or other works is Private ditch not named.....

Description of Works

Diversion Works—

7. (a) Height of dam.....feet, length on top.....feet, length at bottom
.....feet; material to be used and character of construction.....
(Loose rock, concrete,

No dam, water is diverted by means of a flume or frog
masonry, rock and brush, timber crib, etc., wasteway over or around dam)

(b) Description of headgate.....
(Timber, concrete, etc., number and size of openings)

*A different form of application is provided where an appropriation is to be made by the enlargement of existing works, or where storage works are contemplated. These forms can be secured without charge, together with instructions, by addressing the State Engineer, Salem, Oregon.

Canal System—

8. (a) Give dimensions at each point of canal where materially changed in size, stating miles from headgate. At headgate: Width on top (at water line).....feet; width on bottom.....feet; depth of water.....feet; grade.....feet fall per 1000 feet.

(b) At.....miles from headgate: Width on top (at water line).....feet; width on bottom.....feet; depth of water.....feet; grade.....feet fall per 1000 feet.

Fill in the Following Information Where the Water is Used for:

Irrigation—

9. The land to be irrigated has a total area of 33 1/2 acres, located in each smallest legal subdivision, as follows: In the SE 1/4 of the SE 1/4 of Section 27, Twp. 6, North of Range 35 E. W. M.---My present ditch is sufficient to carry the necessary water and I am entitled to and use water for 6 3/4 acres of this 40 acre tract, all the year.--- During the winter season there is a great surplus of water in the stream (The Little Walla Walla River) and I desire to appropriate sufficient for "winter irrigation" of the remainder of my 40 acre tract as above described.

(If more space required, attach separate sheet)

Power, Mining, Manufacturing or Transportation Purposes—

10. (a) Total amount of power to be developed.....horsepower.

(b) Total fall to be utilized.....feet.
(Head)

(c) The nature of the works by means of which the power is to be developed.....

(d) Such works to be located in.....of Sec.
(Legal subdivision)

Tp., R., W. M.
(No. N. or S.) (No. E. or W.)

(e) Is water to be returned to any stream?.....
(Yes or No)

(f) If so, name stream and locate point of return.....
.....Sec., Tp., R., W. M.
(No. N. or S.) (No. E. or W.)

(g) The use to which the power is to be applied is.....

(h) The nature of the mines to be served.....

Municipal Supply—

11. To supply the city of _____
_____ County, having a present population of _____ and an estimated
(Name of) population of _____ in 19 _____

12. Estimated cost of proposed works, \$ _____ Nothing _____

13. Construction work will begin on or before _____ Already complete _____

14. Construction work will be completed on or before _____ " _____

15. The water will be completely applied to the proposed use on or before _____ as _____
_____ soon as permit is issued _____

Duplicate maps of the proposed ditch or other works, prepared in accordance with the rules of the Board of Control, accompany this application.

F. W. Nessly
(Name of Applicant)

Signed in the presence of us as witnesses:

(1) N. A. Davis _____ Milton, Oregon _____
(Name) (Address of Witness)

(2) G. A. Cowl _____ Milton, Oregon _____
(Name) (Address of Witness)

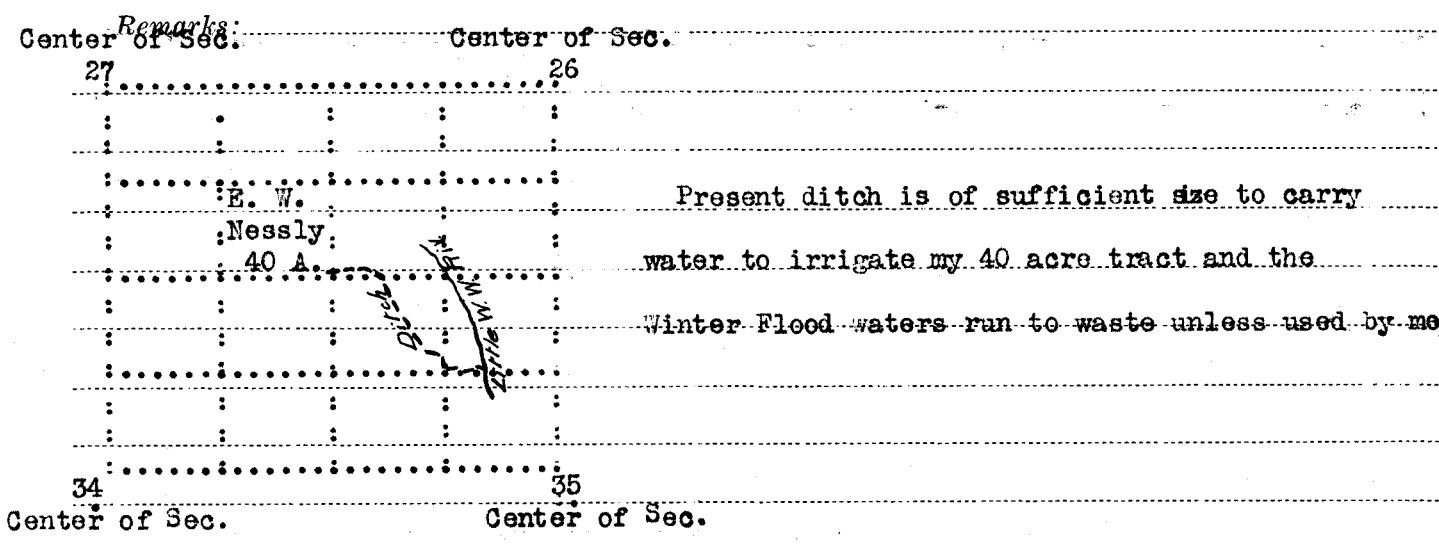

STATE OF OREGON, }
County of Marion } ss.

This is to certify that I have examined the foregoing application, together with the accompanying maps and data, and return the same for correction or completion, as follows:

In order to retain its priority, this application must be returned to the State Engineer with corrections, on or before _____, 19 _____

WITNESS my hand this _____ day of _____, 19 _____

State Engineer.

8

Application No. 1162

Permit No. 538

PERMIT

To appropriate the public waters of the State of Oregon

Division No. 2 District No.

This instrument was first received in the office of the State Engineer at Salem, Oregon,

on the 27 day of Dec.

19 10, at 8:00 o'clock A.M.

Returned to applicant for correction

Corrected application received

Approved

Feb. 6, 1911

Recorded in Book No. 2 of Permits on

Page 538

John H. Lewis

State Engineer

7.99

STATE OF OREGON,

County of Marion

} ss.

This is to certify that I have examined the foregoing application and do hereby grant the same, subject to the following limitations and conditions: The appropriation for irrigation

purposes shall be limited to one-eightieth of one cu. ft. per sec. for each

acre irrigated.

The amount of water appropriated shall be limited to the amount which can be applied to beneficial use and not to exceed 42/100 (0.42) cubic feet per second.

Actual construction work shall begin on or before Feb. 6, 1912

and shall thereafter be prosecuted with reasonable diligence and be completed on or before

Feb. 6, 1913

Complete application of the water to the proposed use shall be made on or before

Feb. 6, 1914

WITNESS my hand this 6th day of February, 1911.

John H. Lewis

State Engineer.

799