

STATE OF OREGON

COUNTY OF DOUGLAS

PERMIT TO APPROPRIATE THE PUBLIC WATERS

THIS PERMIT IS HEREBY ISSUED TO

KAREN VOLK
448 SE CHADWICK ST
ROSEBURG OR 97470

The specific limits and conditions of the use are listed below.

APPLICATION FILE NUMBER: S-88900

SOURCE OF WATER: NORTH UMPQUA RIVER, TRIBUTARY TO UMPQUA RIVER

PURPOSE OR USE: DOMESTIC USE EXPANDED FOR ONE HOUSEHOLD

MAXIMUM RATE: 0.01 CUBIC FOOT PER SECOND

PERIOD OF USE: JANUARY 1 THROUGH DECEMBER 31

DATE OF PRIORITY: DECEMBER 14, 2020

AUTHORIZED POINT OF DIVERSION:

Twp	Rng	Mer	Sec	Q-Q	Measured Distances
26 S	6 W	WM	23	NW NW	870 FEET SOUTH AND 1070 FEET EAST FROM NW CORNER, SECTION 23

AUTHORIZED PLACE OF USE:

Twp	Rng	Mer	Sec	Q-Q
26 S	6 W	WM	23	NE NW
26 S	6 W	WM	23	NW NW

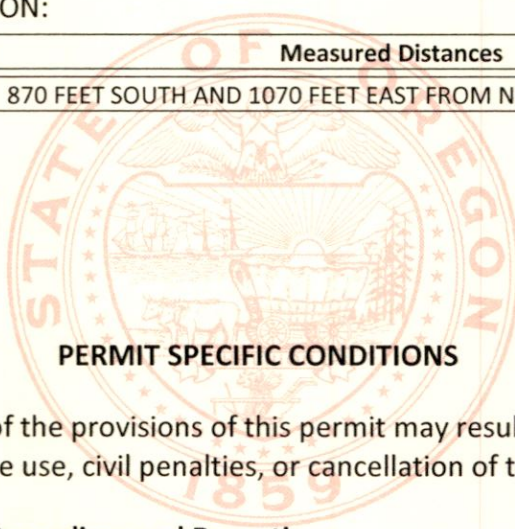

PERMIT SPECIFIC CONDITIONS

1. Failure to comply with any of the provisions of this permit may result in action including, but not limited to, restrictions on the use, civil penalties, or cancellation of the permit.
2. **Water Use Measurement, Recording, and Reporting:**
 - A. Before water use may begin under this permit, the permittee shall install an in-line flow restrictor at each point of diversion. The permittee shall maintain the device in good working order.

- B. The permittee shall allow the watermaster access to the device; provided however, where any device is located within a private structure, the watermaster shall request access upon reasonable notice.
- C. The Director may require the permittee to keep and maintain a record of the volume of water diverted, and may require the permittee to report water-use on a periodic schedule as established by the Director. In addition, the Director may require the permittee to report general water-use information, the periods of water use and the place and nature of use of water under the permit.
- D. The Director may provide an opportunity for the permittee to submit alternative measuring and reporting procedures for review and approval.

3. **In-Water Work:**

Any work related to construction, development, or maintenance of the proposed use shall be conducted during the preferred work period of July 15 through September 1, unless an alternate time period is approved by Oregon Department of Fish and Wildlife.

4. **Riparian Restoration:**

If the riparian area is disturbed in the process of developing a point of diversion, the permittee shall be responsible for restoration and enhancement of such riparian area in accordance with ODFW's Fish and Wildlife Habitat Mitigation Policy OAR 635-415. For purposes of mitigation, the ODFW Fish and Wildlife Habitat Mitigation Goals and Standards, OAR 635-415, shall be followed.

5. **Water Quality:**

The use may be restricted if the quality of the source stream or downstream waters decrease to the point that those waters no longer meet existing state or federal water quality standards due to reduced flows.

6. **Fish Passage:**

The permittee shall not construct, operate, or maintain any dam or artificial obstruction to fish passage across any waters of the state that are inhabited, or were historically inhabited, by native migratory fish (ORS 509.585) without obtaining approval for the artificial obstruction from the Oregon Department of Fish and Wildlife (ODFW). The permittee shall submit a proposal for fish passage to ODFW or apply for a fish passage waiver or exemption.

Approval of the proposed fish passage facility, waiver, or exemption shall be obtained **prior to construction** of any in-channel obstruction or **prior to diversion of water** that may create an artificial obstruction due to low flow.

The permittee shall submit proof to ODFW that fish passage has been implemented per the plan, waiver, or exemption **prior to diversion of water**. The permittee shall maintain adequate passage of native migratory fish at all times (ORS 509.610) as per the approved plan, waiver, or exemption.

The permittee is hereby directed to schedule a consultation with an ODFW Fish Passage Coordinator.

7. Fish Screen/By-Pass:

The permittee shall install, maintain, and operate fish screening and by-pass devices consistent with current Oregon Department of Fish and Wildlife (ODFW) standards. Fish screening is to prevent fish from entering the proposed diversion while by-pass devices provide adequate upstream and downstream passage for fish. The required screen and by-pass devices are to be in place and functional prior to diversion of any water. The permittee shall obtain written approval from ODFW that the installation of the required screen and by-pass devices meets the state's criteria or the permittee shall submit documentation that ODFW has determined screens and/or by-pass devices are not necessary.

STANDARD CONDITIONS

1. Where two or more water users agree among themselves as to the manner of rotation in the use of water and such agreement is placed in writing and filed by such water users with the watermaster, and such rotation system does not infringe upon such prior rights of any water user not a party to such rotation plan, the watermaster shall distribute the water according to such agreement.
2. This permit is for the beneficial use of water without waste. The water user is advised that new regulations may require the use of best practical technologies or conservation practices to achieve this end.
3. By law, the land use associated with this water use must be in compliance with statewide land-use goals and any local acknowledged land-use plan.
4. The use of water allowed herein may be made only at times when sufficient water is available to satisfy all prior rights, including prior rights for maintaining instream flows.

DEVELOPMENT AND COMPLETION TIMELINE REQUIREMENTS

1. Construction of the water system shall begin within five years of the date of permit issuance. The deadline to begin construction may not be extended. This permit is subject to cancellation proceedings if the begin construction deadline is missed.
2. Complete application of the water shall be made within five years of the date of permit issuance. If beneficial use of permitted water has not been made before this date, the permittee may submit an application for extension of time, which may be approved based upon the merit of the application.
3. Within one year after complete application of water to the proposed use, the permittee shall submit a claim of beneficial use, which includes a map and report, prepared by a Certified Water Rights Examiner.

Issued JUN 17 2022



Dwight French
Water Right Services Division Administrator, for
Thomas M. Byler, Director
Oregon Water Resources Department