

STATE OF OREGON

COUNTY OF WALLOWA

PERMIT TO APPROPRIATE THE PUBLIC WATERS

THIS PERMIT IS HEREBY ISSUED TO:

MICHAEL A. MONTOYA  
SHERYL L. SEIM-MONTOYA  
PO BOX 1004  
JOSEPH OR 97846

The specific limits and conditions of the use are listed below.

APPLICATION FILE NUMBER: S-88887

SOURCE OF WATER: WALLOWA LAKE RESERVOIR, CONSTRUCTED UNDER PERMIT R-347, TRIBUTARY TO WALLOWA RIVER

PURPOSE OR USE: DOMESTIC USE EXPANDED FOR ONE HOUSEHOLD

MAXIMUM VOLUME: 1.5 ACRE-FEET (OR AS FURTHER LIMITED BY CONTRACT)

PERIOD OF USE: JANUARY 1 THROUGH DECEMBER 31

DATE OF PRIORITY: OCTOBER 19, 2020

AUTHORIZED POINT OF DIVERSION:

Twp	Rng	Mer	Sec	Q-Q	Measured Distances
3 S	45 E	WM	5	NE NW	990 FEET SOUTH AND 60 FEET WEST FROM S1/4 CORNER, SECTION 32

AUTHORIZED PLACE OF USE:

Twp	Rng	Mer	Sec	Q-Q
3 S	45 E	WM	5	NE NW

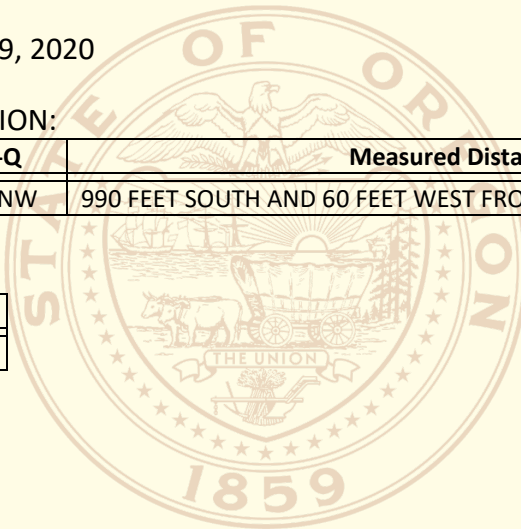

## PERMIT SPECIFIC CONDITIONS

1. Failure to comply with any of the provisions of this permit may result in action including, but not limited to, restrictions on the use, civil penalties, or cancellation of the permit.
2. **Water Use Measurement, Recording, and Reporting:**
  - A. The Director may require the permittee to install a totalizing flow meter at each point of diversion. If the Director notifies the permittee to install a measuring device, the permittee shall install such device within the period stated in the notice. Once installed, the permittee shall maintain the device in good working order, and shall allow the watermaster access to the device.
  - B. The Director may require the permittee to keep and maintain a record of the volume of water diverted, and may require the permittee to report water-use on a periodic schedule as established by the Director. In addition, the Director may require the permittee to report general water-use information, the periods of water use and the place and nature of use of water under the permit.
  - C. The Director may provide an opportunity for the permittee to submit alternative measuring and reporting procedures for review and approval.

### 3. **Fish Screen/Passage:**

The water user shall install, maintain, and operate fish screening and fish passage devices consistent with current Oregon Department of Fish and Wildlife (ODFW) standards. Fish screening is to prevent fish from entering the proposed diversion, while passage devices provide adequate upstream and downstream passage for fish. The required screen and passage devices are to be in place and functional, and approved in writing by ODFW prior to diversion of water. The water user may submit evidence in writing that ODFW has determined screens and/or passage devices are not necessary.

4. The use of water under this permit is subject to the terms and conditions of contract in the name of Michael A. Montoya and Sheryl L. Seim-Montoya, or a satisfactory replacement, between the Wallowa Lake Irrigation District and the permittee, a copy of which must be on file in the records of the Water Resources Department.

## STANDARD CONDITIONS

1. Where two or more water users agree among themselves as to the manner of rotation in the use of water and such agreement is placed in writing and filed by such water users with the watermaster, and such rotation system does not infringe upon such prior rights of any water user not a party to such rotation plan, the watermaster shall distribute the water according to such agreement.

2. This permit is for the beneficial use of water without waste. The water user is advised that new regulations may require the use of best practical technologies or conservation practices to achieve this end.
3. By law, the land use associated with this water use must be in compliance with statewide land-use goals and any local acknowledged land-use plan.
4. The use of water allowed herein may be made only at times when sufficient water is available to satisfy all prior rights, including prior rights for maintaining instream flows.

#### **DEVELOPMENT AND COMPLETION TIMELINE REQUIREMENTS**

1. Construction of the water system shall begin within five years of the date of permit issuance. The deadline to begin construction may not be extended. This permit is subject to cancellation proceedings if the begin construction deadline is missed.
2. Complete application of the water shall be made within five years of the date of permit issuance. If beneficial use of permitted water has not been made before this date, the permittee may submit an application for extension of time, which may be approved based upon the merit of the application.
3. Within one year after making complete application of water, the permittee shall submit a claim of beneficial use, which includes a map and report, prepared by a Certified Water Rights Examiner.

ISSUED JUNE 21, 2024

*Katherine Ratcliffe*

Katherine Ratcliffe  
Water Rights Section Manager, for  
Douglas E. Woodcock, Acting Director  
Oregon Water Resources Department

