

STATE OF OREGON

COUNTY OF LANE

PERMIT TO APPROPRIATE THE PUBLIC WATERS

THIS PERMIT IS HEREBY ISSUED TO

MICHELE TAYLOR
SILTCOOS LANDING, LLC
360 W 27TH PLACE
EUGENE OR 97405

The specific limits and conditions of the use are listed below.

APPLICATION FILE NUMBER: S-89372

SOURCE OF WATER: SILTCOOS LAKE, TRIBUTARY TO SILTCOOS RIVER

PURPOSE OR USE: HUMAN CONSUMPTION USE (INDOOR USE ONLY: COOKING, DRINKING AND SANITATION) FOR ONE HOUSEHOLD

MAXIMUM RATE: 0.005 CUBIC FOOT PER SECOND, FURTHER LIMITED TO 500 GALLONS PER DAY

PERIOD OF USE: JANUARY 1 THROUGH DECEMBER 31

DATE OF PRIORITY: JUNE 13, 2023

AUTHORIZED POINT OF DIVERSION:

Twp	Rng	Mer	Sec	Q-Q	Measured Distances
19 S	12 W	WM	27	SE NE	35 FEET NORTH AND 375 FEET WEST FROM E1/4 CORNER, SECTION 27

AUTHORIZED PLACE OF USE:

Twp	Rng	Mer	Sec	Q-Q
19 S	12 W	WM	27	SE NE

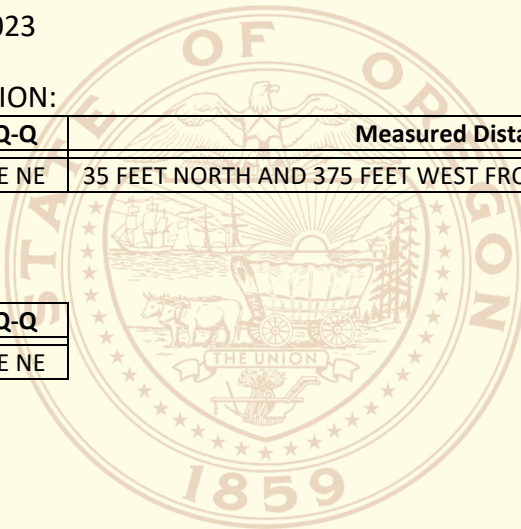

PERMIT SPECIFIC CONDITIONS

1. Failure to comply with any of the provisions of this permit may result in action including, but not limited to, restrictions on the use, civil penalties, or cancellation of the permit.
2. **Water Use Measurement, Recording, and Reporting:**
 - A. Before water use may begin under this permit, the permittee shall install a totalizing flow meter, or other suitable measuring device as determined by the watermaster, at each point of diversion. The permittee shall maintain the device in good working order.
 - B. The permittee shall allow the watermaster access to the device; provided however, where any device is located within a private structure, the watermaster shall request access upon reasonable notice.
 - C. The Director may require the permittee to keep and maintain a record of the volume of water diverted, and may require the permittee to report water-use on a periodic schedule as established by the Director. In addition, the Director may require the permittee to report general water-use information, the periods of water use and the place and nature of use of water under the permit.
 - D. The Director may provide an opportunity for the permittee to submit alternative measuring and reporting procedures for review and approval.

3. **Fish Screen:**

The permittee shall install, maintain, and operate fish screening consistent with current Oregon Department of Fish and Wildlife (ODFW) standards or submit documentation that ODFW has determined fish screening is not necessary or is exempted. Fish screening is to prevent fish from entering the proposed diversion. The required screen is to be in place and functional, and approved in writing by ODFW **prior to diversion of any water**. The permittee shall operate and maintain the fish screen consistent with ODFW's operation and maintenance standards. The permittee is hereby directed to schedule a consultation with an ODFW Fish Screen Coordinator.

4. **In-Water Work:**

Any in-water work related to construction, development, or maintenance of the proposed use shall be conducted during the preferred work period of July 1 through September 15, unless an alternate time period is approved by Oregon Department of Fish and Wildlife.

5. Riparian Area Restoration:

If the riparian area is disturbed in the process of developing a point of diversion, the permittee shall be responsible for restoration and enhancement of such riparian area in accordance with ODFW's Fish and Wildlife Habitat Mitigation Policy OAR 635-415. For purposes of mitigation, the ODFW Fish and Wildlife Habitat Mitigation Goals and Standards, OAR 635-415, shall be followed.

6. Water Quality:

All water use under this permit shall comply with state and federal water quality laws. The permittee shall not violate any state and federal water quality standards, shall not cause pollution of any waters of the state, and shall not place or cause to be placed any wastes in a location where such wastes are likely to escape or be carried into the waters of the state by any means. The use may be restricted if the quality of source stream or downstream waters decrease to the point that those waters no longer meet existing state or federal water quality standards. Permittee is responsible for obtaining any necessary state and federal permits.

STANDARD CONDITIONS

1. Where two or more water users agree among themselves as to the manner of rotation in the use of water and such agreement is placed in writing and filed by such water users with the watermaster, and such rotation system does not infringe upon such prior rights of any water user not a party to such rotation plan, the watermaster shall distribute the water according to such agreement.
2. This permit is for the beneficial use of water without waste. The water user is advised that new regulations may require the use of best practical technologies or conservation practices to achieve this end.
3. By law, the land use associated with this water use must be in compliance with statewide land-use goals and any local acknowledged land-use plan.
4. The use of water allowed herein may be made only at times when sufficient water is available to satisfy all prior rights, including prior rights for maintaining instream flows.

DEVELOPMENT AND COMPLETION TIMELINE REQUIREMENTS

1. Construction of the water system shall begin within five years of the date of permit issuance. The deadline to begin construction may not be extended. This permit is subject to cancellation proceedings if the begin construction deadline is missed.

2. Complete application of the water shall be made within five years of the date of permit issuance. If beneficial use of permitted water has not been made before this date, the permittee may submit an application for extension of time, which may be approved based upon the merit of the application.
3. Within one year after complete application of water to the proposed use, the permittee shall submit a claim of beneficial use, which includes a map and report, prepared by a Certified Water Rights Examiner.

ISSUED JUNE 7, 2024

Katherine Ratcliffe

Katherine Ratcliffe
Water Rights Section Manager, for
Douglas E. Woodcock, Acting Director
Oregon Water Resources Department

