

1398

RECEIVED  
MAY 8 1911  
SALEM - OREGON

# MAP SHOWING ALIGNMENT OF THE SCOTT-HARRIS DITCH ENLARGEMENT AND EXTENSION

T. 19 S. R. 43 E. W. 1/4  
Scale, 40 ft. = 1 in.

I, Edwin Johnson, of Vale Oregon hereby certify that this map was made from notes taken during an actual survey made by me on Nov. 21st 1910, and that it correctly represents the works described in the accompanying application, together with the location of streams in the immediate vicinity.

*J. Edwin Johnson*  
Engineer

MADE BY  
JOHN E. JOHNSON & SONS, E.E.  
Vale, Oregon  
Drain. Engs.

T. 19 S. R. 43 E. W. 1/4

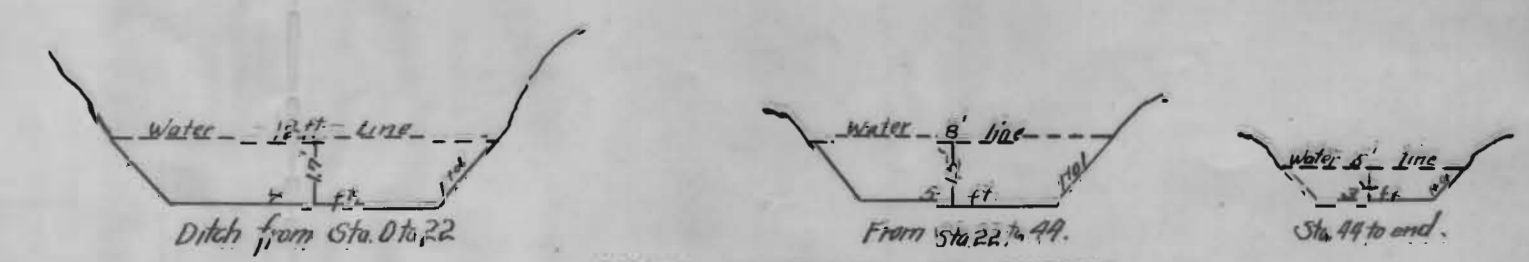
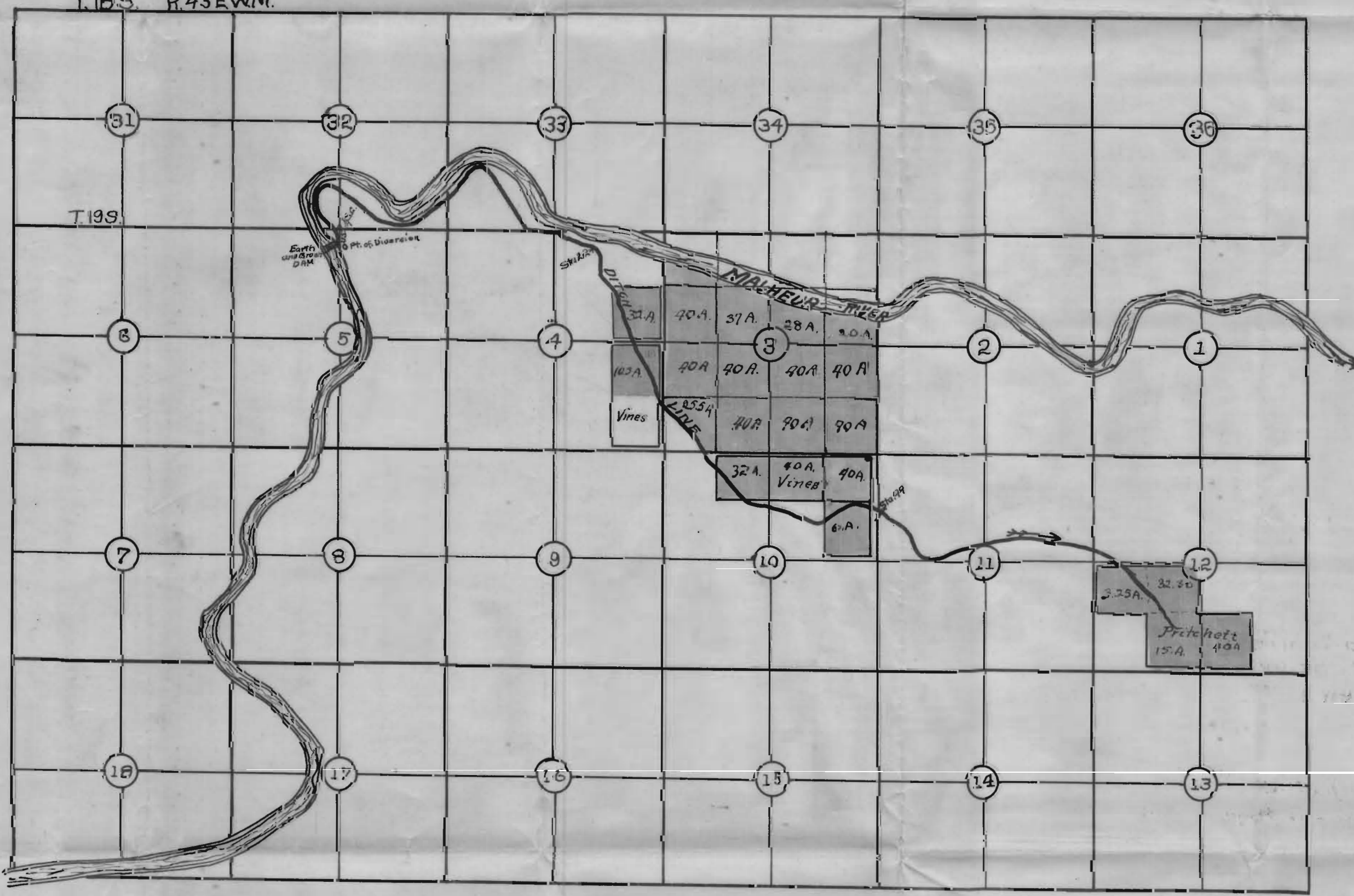

GROSS SECTIONS OF DITCH  
Scale 5 ft. to 1 in.  
Grade 0.2% per 100'

This Ditch was formerly 5 ft. on the bottom and extended to Sta. 44 only.  
Land in Red = Land Covered by old Ditch.  
" " Orange = " " extension.

RECEIVED  
MAY 8 1911  
SALEM - OREGON

Application No. 1398  
Enlargement Permit No. 103

1398

1398