

1878



858

OFFICE OF STATE ENGINEER

RECEIVED

NOV 22 1911

SALMON, OREGON

TP 7, S. R. 47, E. W. M.

Application No. 1878  
Enlargement Permit No. 126

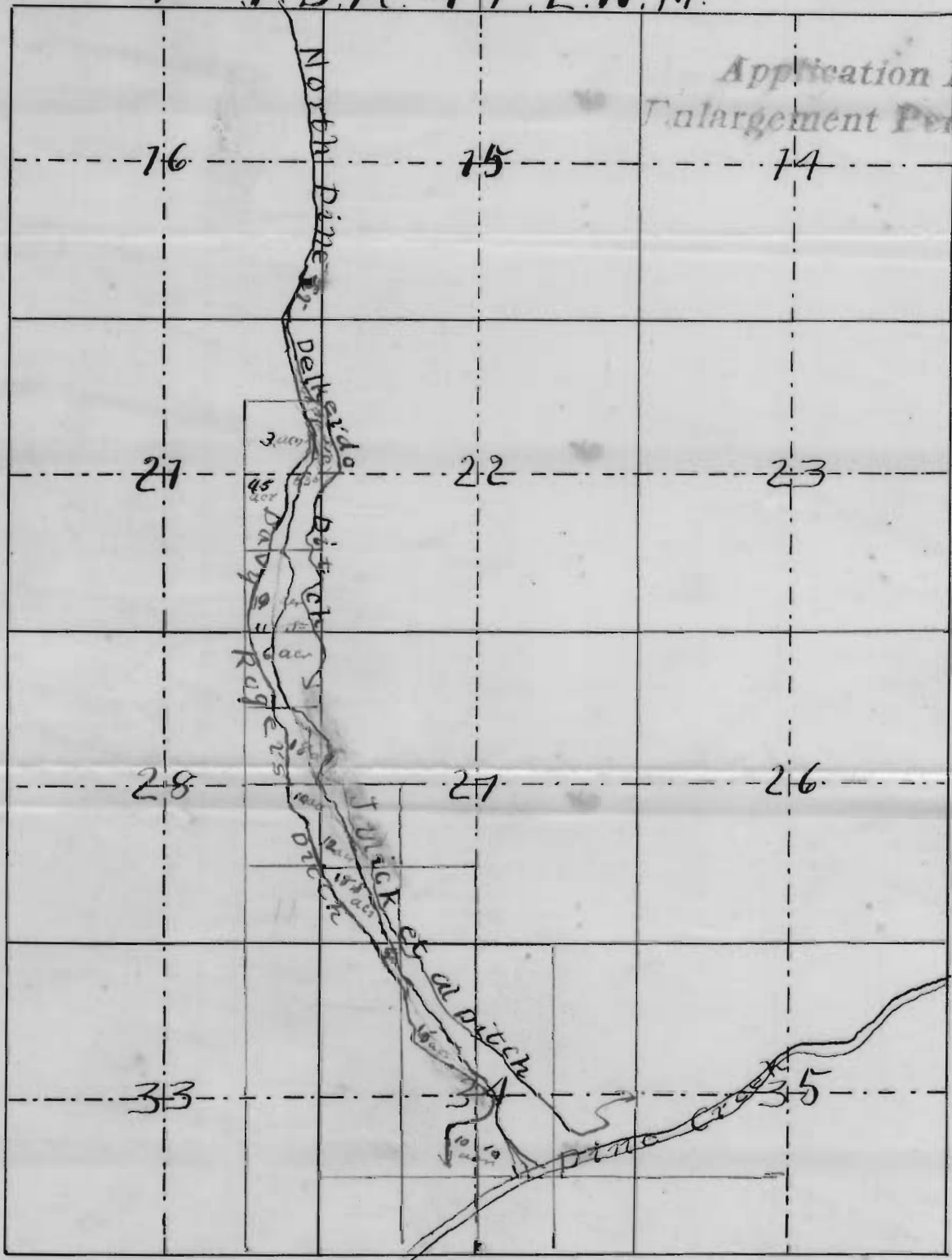

CERTIFICATE OF SURVEYOR

I Williard B Blakeslee of Homestead Oregon do hereby certify that this map was made from notes taken during an actual Survey made under my immediate supervision, on from October 16<sup>th</sup> to 23<sup>d</sup> 1911 and that it correctly represents the works described in the accompanying application, together with the location of streams and other ditches in the immediate vicinity, and has written there on the area in each smallest legal subdivision which it is proposed to irrigate

W B Blakeslee  
Surveyor.

Scale 2 inches to one mile