

MAP
 Accompanying W.H.H. Dufur's
 Application for permit to appropriate water
 BY
 C.F. Galligan

Scale 400ft = 1in

Application No. 154
 E. Permitt No. 154

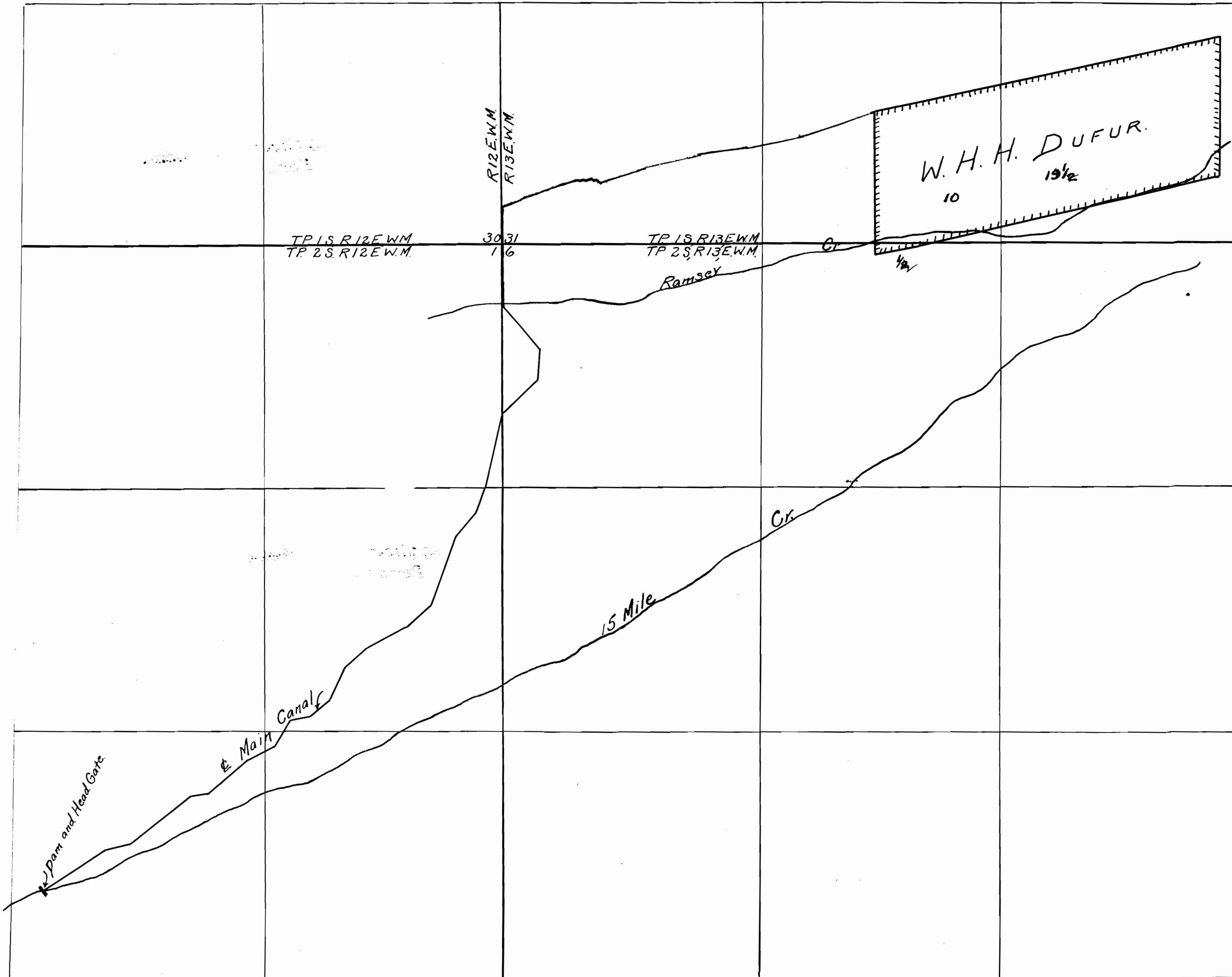

I, C.F. Galligan of The Dalles, Wasco County, Oregon do hereby certify that this Map was made from Notes taken during an actual survey made by me on Apr 8th to 14th 1912, and that it correctly represents the works described in the accompanying application together with the location of streams and other ditches in the immediate vicinity and has written thereon the Area in each smallest legal subdivision which it is proposed to irrigate.

C.F. Galligan
 Surveyor

Application No. 154
 Permit No.