

Map
 Showing Location
 of
 Proposed Extension
 of
 Irrigation Ditch
 of
LUKE RYAN
 Near Mouth of Big Butte Creek

Scale—2 in = 1 mi.

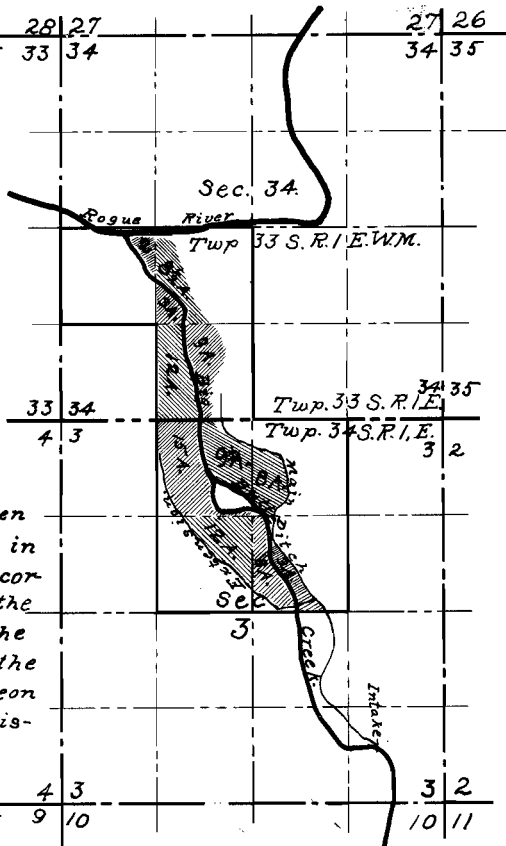

I, Ernest W. Smith, of Butte Falls, Oregon, do hereby certify that this map was made from notes taken during an actual survey made by me in Jan. 1912 and Mar. 5-7, 1913, and that it correctly represents the works described in the accompanying application, together with the location of streams and other ditches in the immediate vicinity, and has written thereon the area in each smallest legal subdivision which it is proposed to irrigate.

Ernest W. Smith 4 3 3 2
 9 10 10 11
 surveyor.

OFFICE OF STATE ENGINEER
 BUTTE FALLS, OREGON
 APR 15 1914

Application No. **2889**

Enlargement Permi 168