

74808

4808

OFFICE OF STATE ENGINEER  
RECEIVED  
OCT 31 1913  
SALEM, OREGON,

Application No. 3084  
Enlargement Permit No. 188

N

TOWNSHIP No. 38 South, Range No. 5 West. of the W. M.

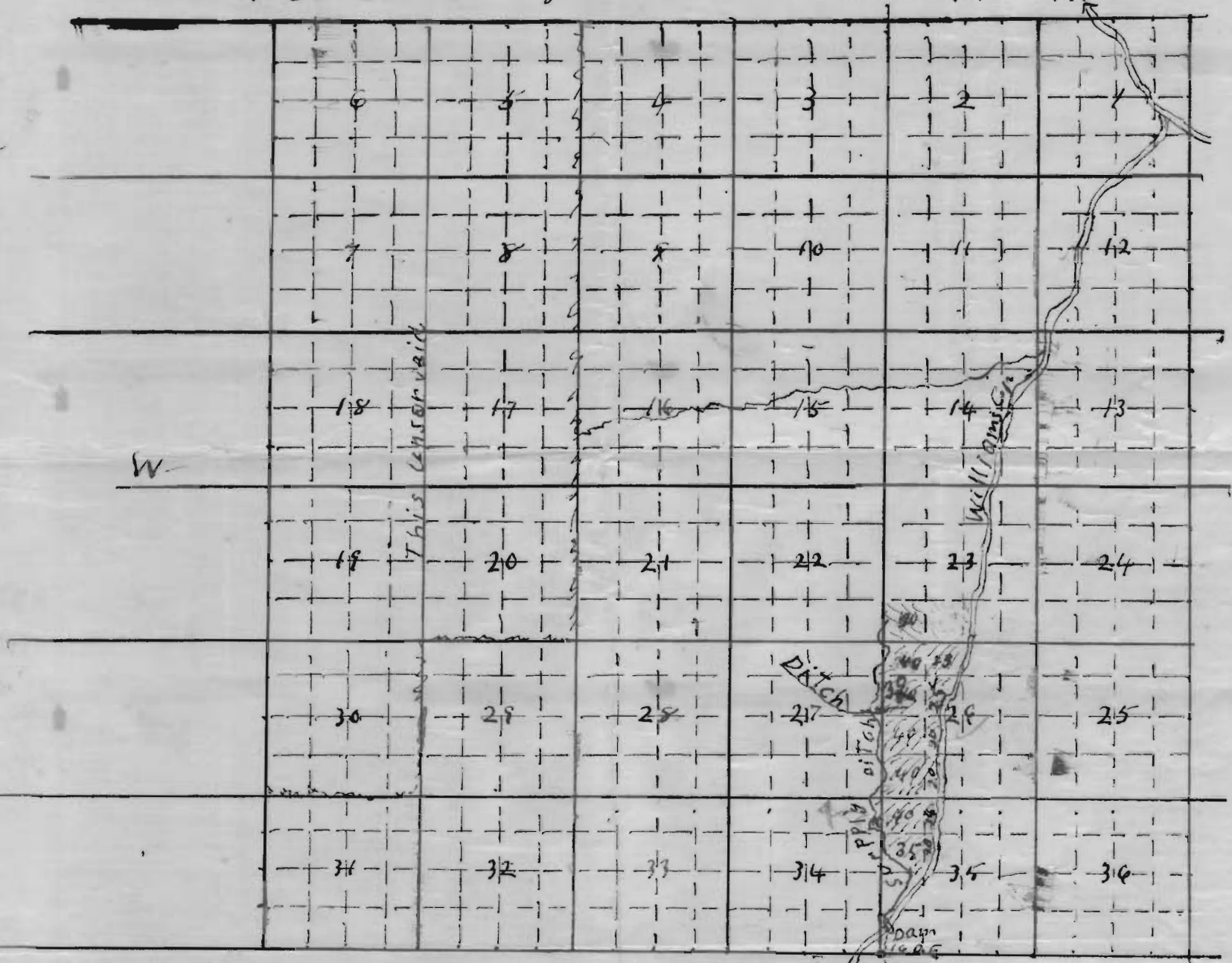

Geo. Sparlin Surveyor

I, George Sparlin, of Williams, Oregon do hereby certify  
-that this map was made from notes taken during an  
actual survey made by me on October 1913, and that  
it correctly represents the works described in the accompanying  
application together with the location of streams and other  
ditches in the immediate vicinity and has a plan thereon  
the area in each smallest legal subdivision which it is  
possible to irrigate.

George Sparlin  
Surveyor

74808

3084