

MAP  
 Showing  
 Lands Under Proposed Enlargement Application  
 of the  
 F. C. Howe Appl. No 3471, Permit No 1938

Scale: -1" = 800'

Aug. 28, 1914.

Interior Eng. Co.

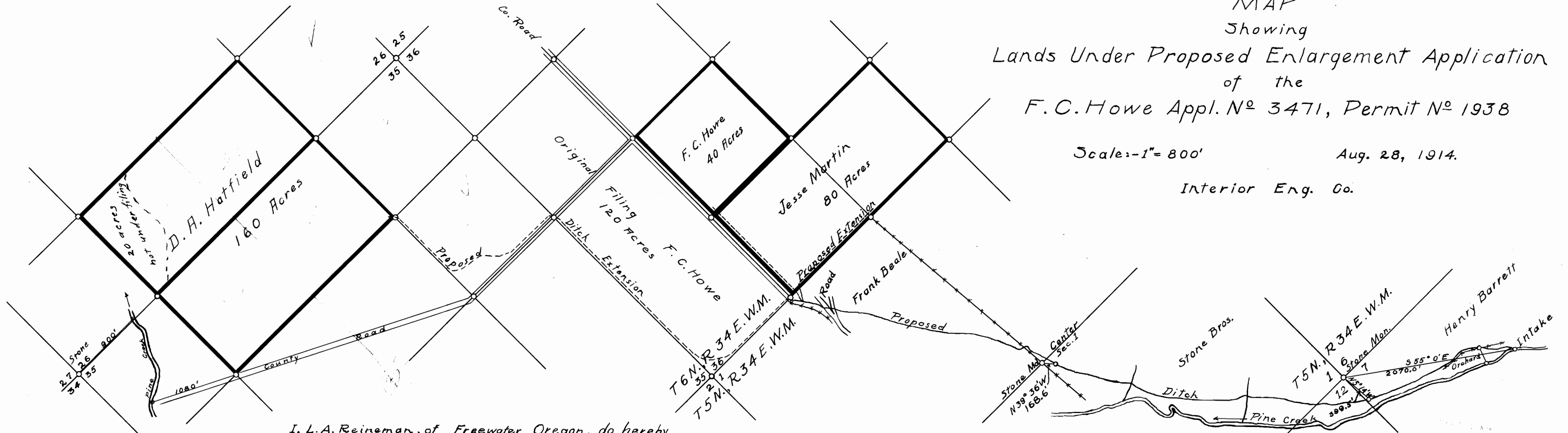

I, L.A. Reineman, of Freewater Oregon, do hereby certify that this map was made from notes taken during an actual survey made under my direction in Feb. 1914, and Aug. 26, and that it correctly represents the works described in the accompanying application, together with the location of streams and other ditches in the immediate vicinity, and has written thereon the area in each smallest legal subdivision which it is proposed to irrigate.

L. A. Reineman.

SALEM, OREGON.

3890

227