

**MAP**  
 OF THE  
**APPROPRIATION OF**  
**WATER**  
 TAKEN FROM THE  
**APPLEGATE RIVER**  
 IN  
 NE ¼ SEC. 31, TP. 36S RW. W.  
**JOSEPHINE COUNTY**  
**OREGON**

Showing extension to Red Bluff Ditch  
 Surveyed by Alex Watts in July 1910.

Scale 80 Rods to 1 inch.

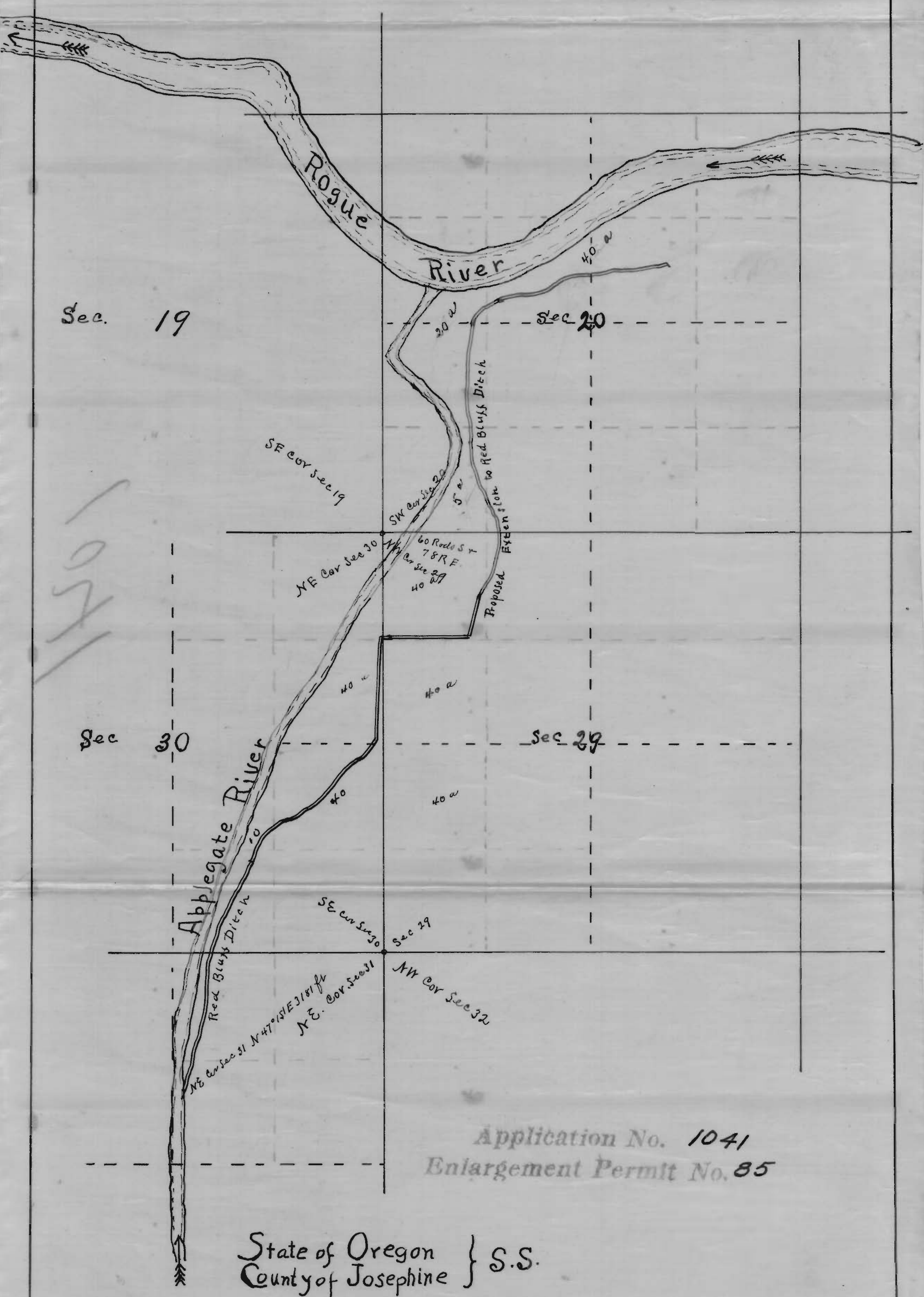

State of Oregon } S.S.  
 County of Josephine }

I, Alex Watts, of Murphy, Oregon, do hereby certify that this map was made from notes taken during an actual survey made by me on July 12, 13 and 14, 1910, and that it correctly represents the works described in the accompanying application, together with the location of streams and other ditches in the immediate vicinity, and has written thereon the area in each smallest legal subdivision which it is proposed to irrigate

*Alex Watts*

Surveyor.

107

107