

Map of Reservoir
Scale 1 in = 200 ft

- Notes:-
- Red indicates Transit Line.
 - Green .. Proposed Ditches
 - Black .. Old
 - Yellow .. Present ditches to be enlarged.
 - Blue .. Crooked River

I, C. L. White, of Fife, Oregon do hereby certify that this map was made from notes taken during an actual survey made by me Oct. 7-13, 1910, and that it correctly represents the marks described in the accompanying application, together with the location of streams and other ditches in the immediate vicinity, and has written thereon the area in each smallest legal subdivision which it is proposed to irrigate.

C. L. White,
Surveyor

Application No. 1184
Enlargement Permit No. 92

MAP
of
PROPOSED IRRIGATION SYSTEM
for
GILCHRIST BROS
T205~R22E
CROOK COUNTY, OREG.

Application No. 1186
Permit No. 561
RECORDED
OFFICE OF REGISTER

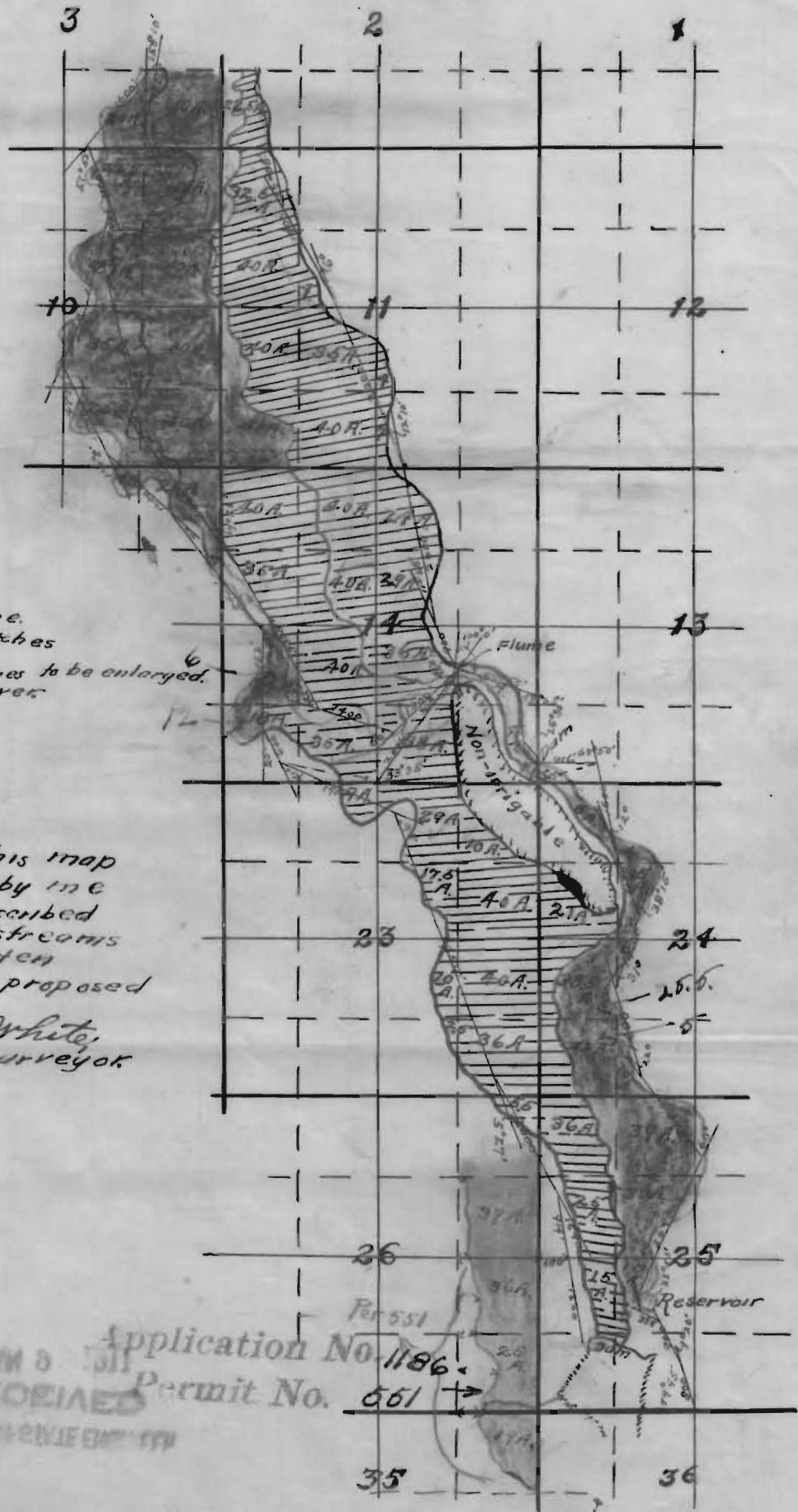

2 inches to the mile.