

ION

Application No. G-11051

Permit No. G10210

TOWNSHIP 27S, RANGE 17E, W.M.

RECEIVED

FEB 10 1983
WATER RESOURCES DEPT.
SALEM, OREGON

North

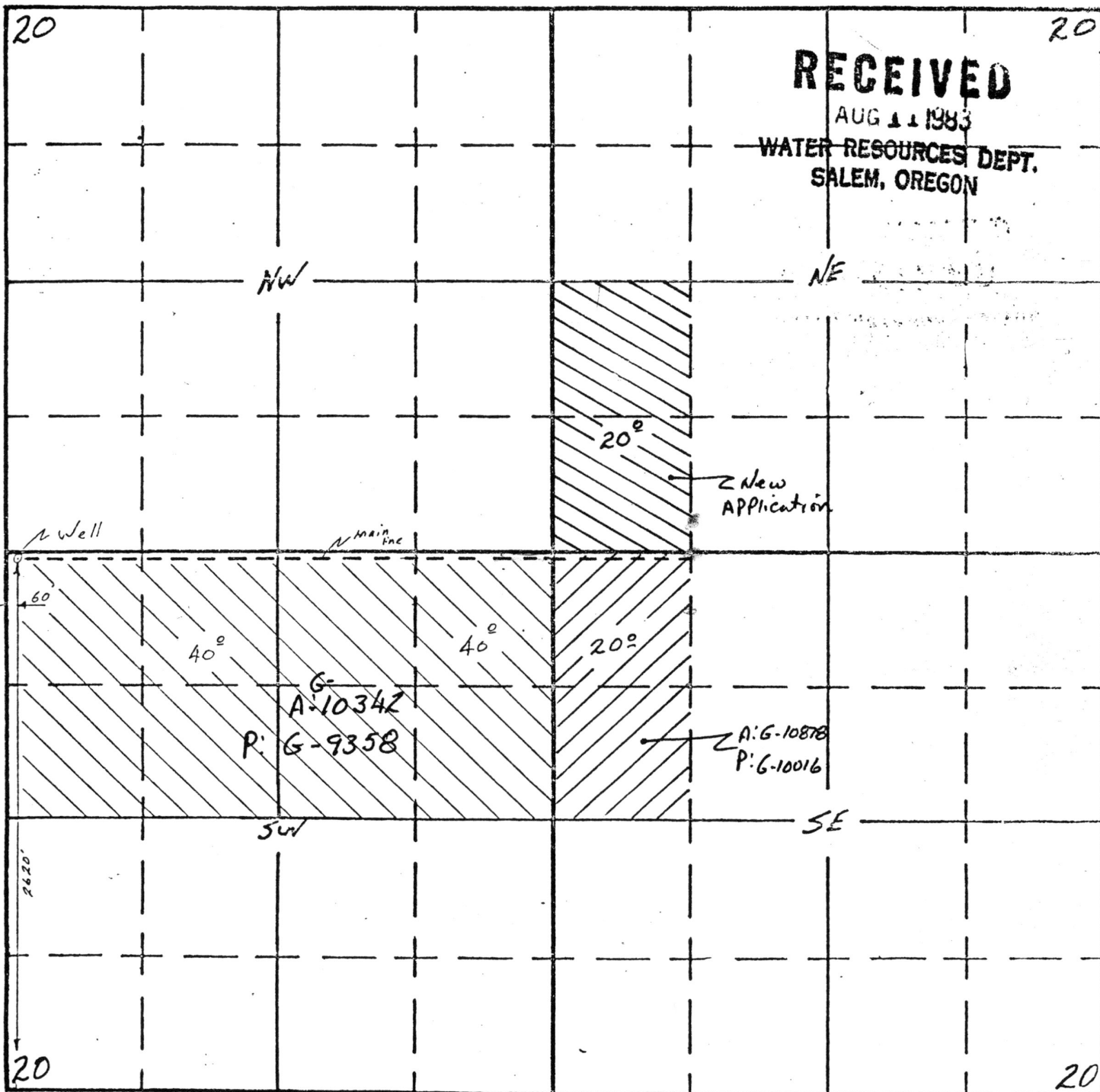

RECEIVED

AUG 11 1983

WATER RESOURCES DEPT.
SALEM, OREGON

NW

NE

New Application

A: 10342
P: G-9358

A: G-10878
P: G-10016

SW

SE

South

Scale - 8" = 1mi

This map prepared from information furnished by applicant

~~Application No. G-10878~~

~~Permit No. G10016~~

Nancy [Signature]
Applicant