

T. 38 S., R. 5 W., W. M.

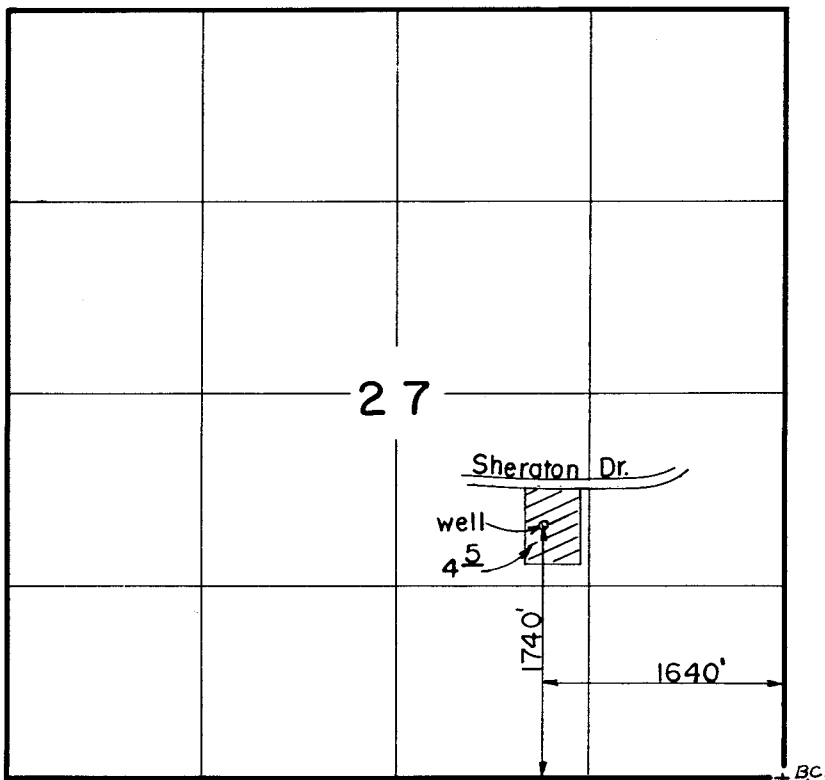

Scale: 1" = 1320'

RECEIVED

JUL 18 1991

WM. DIST. 14  
GRANTS PASS, ORE.

**FINAL PROOF SURVEY**  
UNDER

Application No. G-11153. Permit No. G-10269  
IN NAME OF

T. R. TRULL & CANDACE M. MORASCH

Surveyed AUG. 8. 1988, by B. S. JAMES.

41033-199-1072

LMS