

Section 24

TOWNSHIP 35 S, RANGE 10 E, W. M.

SCALE: 4 INCHES PER MILE
North

RECEIVED

JAN 11 1984
WATER RESOURCES DEPT.
SALEM, OREGON

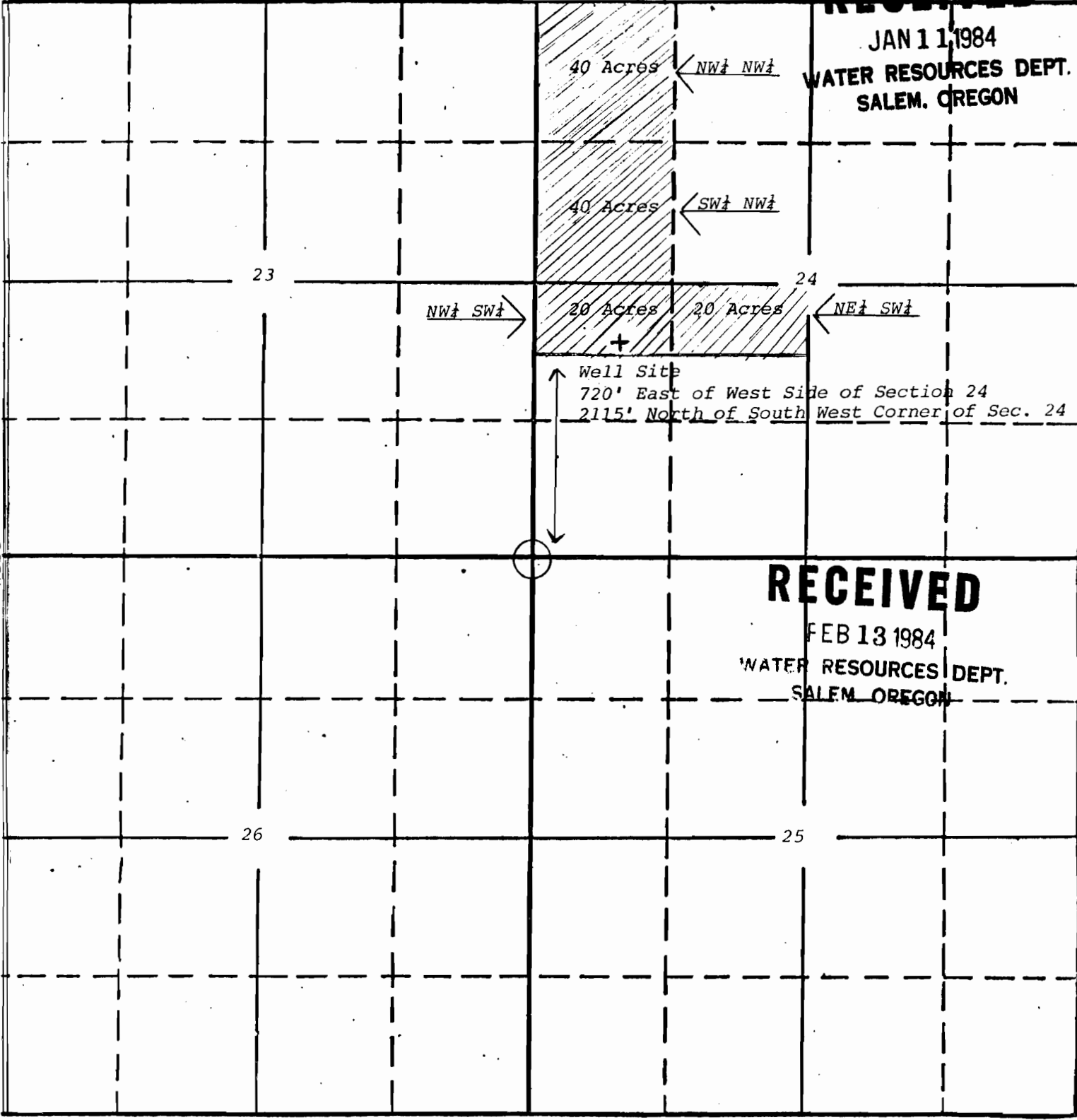

RECEIVED

FEB 13 1984
WATER RESOURCES DEPT.
SALEM, OREGON

South

APPLICATION No. 8-11069

PERMIT No.
G10344