

Section MAP

G-10397

Section 28-33 Township 25S Range 31E

County of Harney State of Ore

S 1/2 of SW 1/4 of Sec 28

28

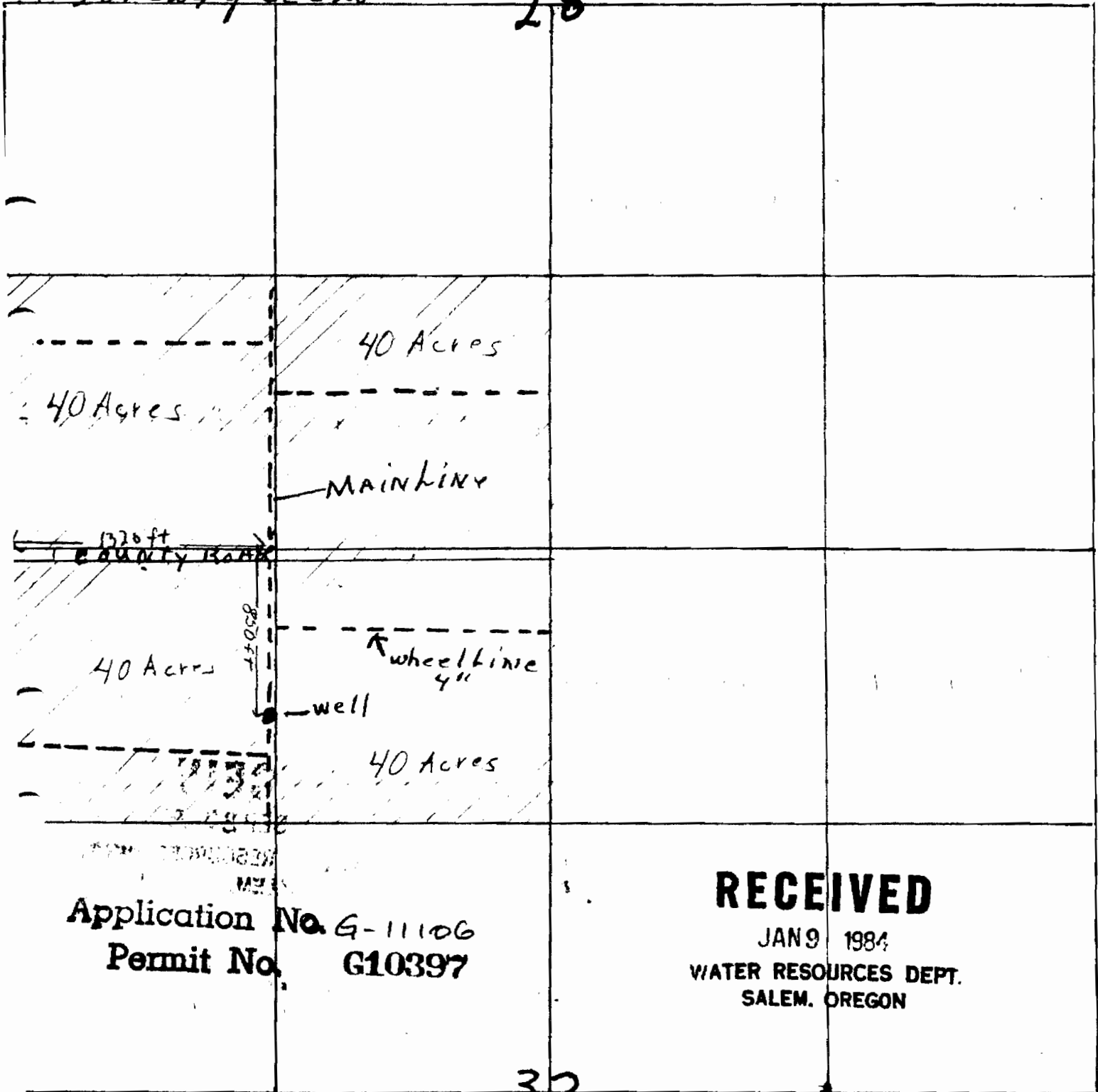

40 Acres

40 Acres

MAINLINE

1370 ft

COUNTY BANK

40 Acres

1700 ft

wheel line 4"

well

40 Acres

1130 ft

Application No. G-11106

Permit No. G10397

RECEIVED

JAN 9 1984

WATER RESOURCES DEPT.

SALEM, OREGON

N 1/2 of NW 1/4 of Sec 33

33