

T. 36S., R. 11,12E., W.M.

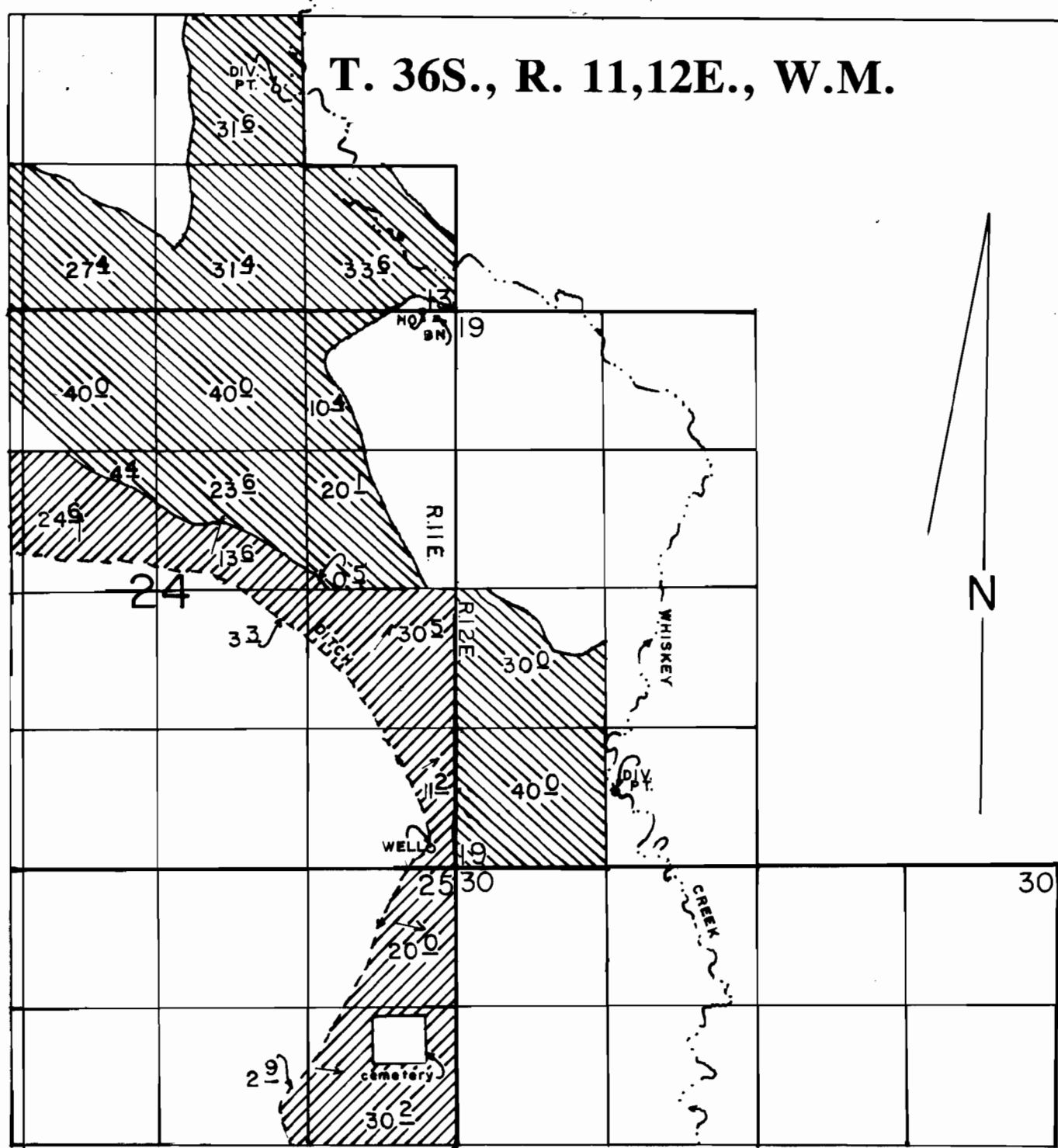

POD. LOC: 660' N & 1400' E FROM SW COR. OF SEC 19.

WELL LOC: 180' N & 220' W FROM SE COR. OF SEC 24.

FINAL PROOF SURVEY

UNDER

Application No. 58501 Permit No. 44119
G-11380 G-10498
 IN NAME OF

BRUCE S. AND VIRGINIA A. TOPHAM

Surveyed JUNE 28, 1994, by R.M. SUTTERFIELD

SCALE: 1" = 1320'

 PRIMARY FROM WELL
 PRIMARY FROM SURFACE WATER & SUPPLEMENTAL FROM WELL.