

T.4S.,R.12E.,W.M.

Original maps & field notes
in G-7182

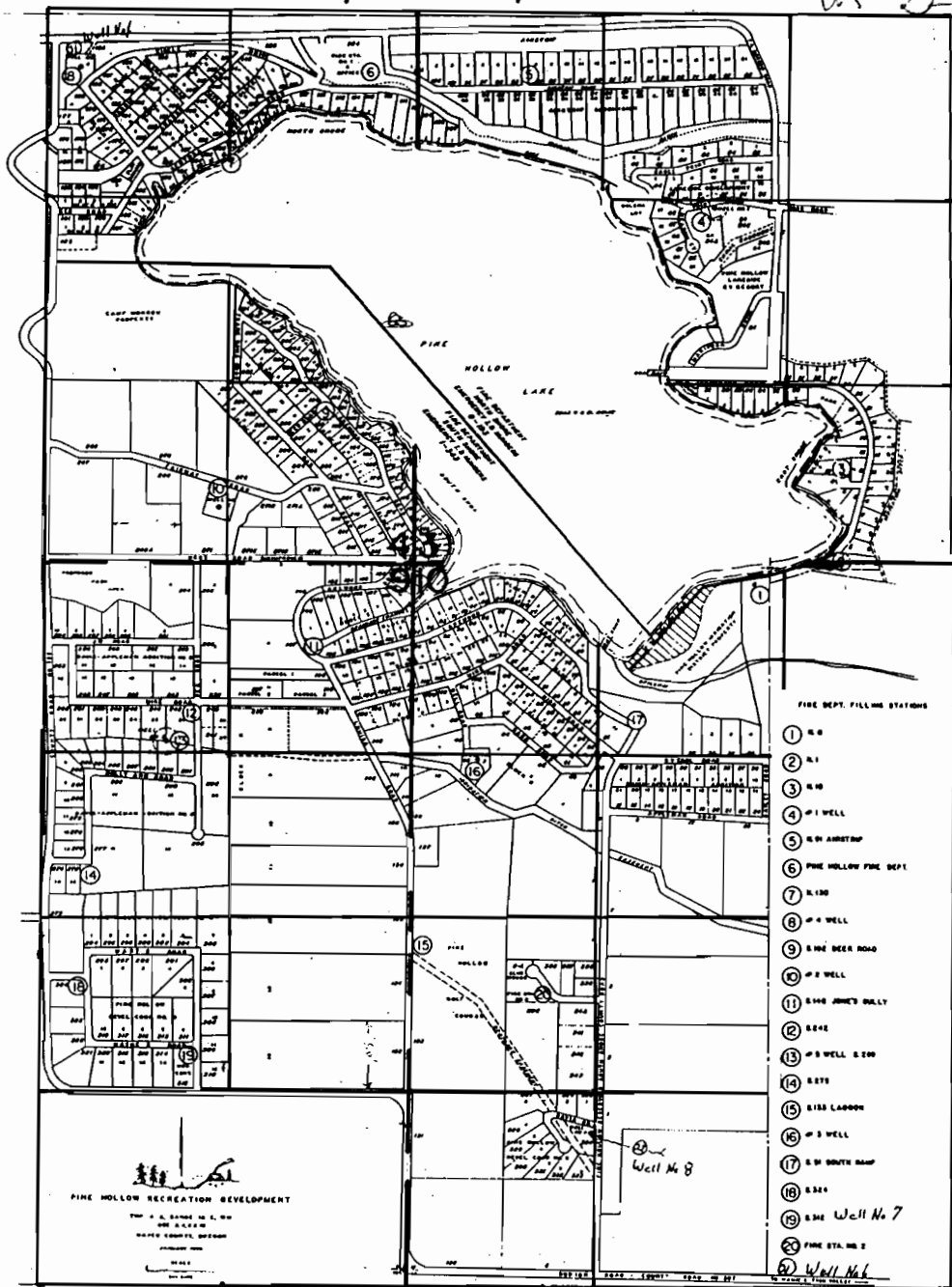

Copy

G-8953



SCALE: 1" = 1320'

FINAL PROOF SURVEY UNDER

G-7182 G-6803  PRIORITY, DEC.16,1975
 Application No. G-11127 Permit No. G-10507  PRIORITY, JULY12,1984
 IN NAME OF

PINE HOLLOW DEVELOPMENT CORP.

Surveyed JUNE 28 1995, by R.M.SUTTERFIELD

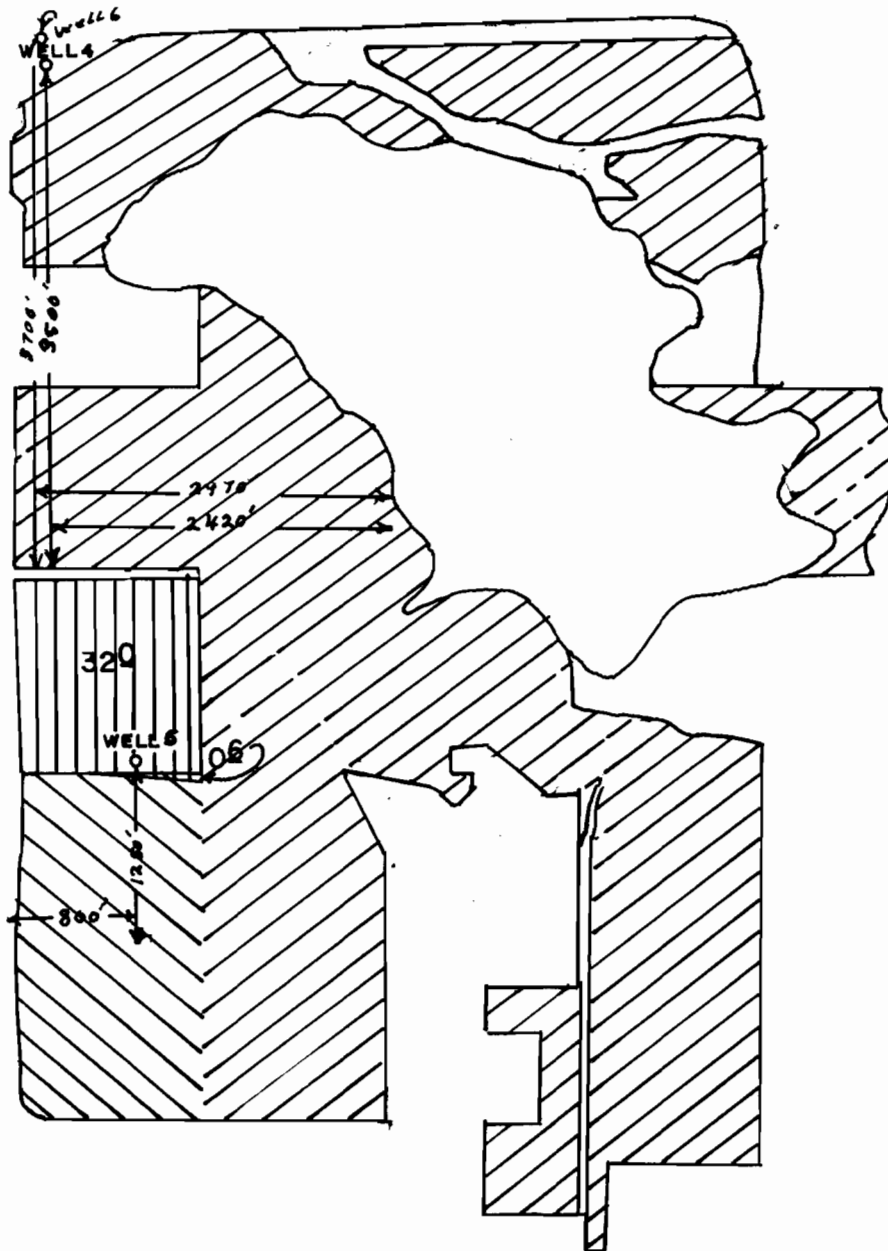

FINAL PROOF SURVEY

UNDER

G-8953
G-7182

G-8323
G-6803

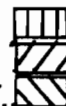

PRIORITY, SEPT. 28, 1978

Application No. G-11127 Permit No. G-10507

IN NAME OF

...PINE HOLLOW DEVELOPMENT CORP.

Surveyed 19....., by