

SE.1/4 Sec.7 T.10S. R.2W. WM
MARION COUNTY

7D 10 2W
1 10 2 07 4
1 10 2 18 1

1" = 200'

SEE MAP 7 10 2W

G-11525
0006010

APPLICATION MAP FOR
CHARLES C. HART.

WELLS LOCATED: HART'S WELL: 240 FT.
NORTH & 920 FT EAST, SMITH WELL: 600
FT NORTH & 66 FT EAST, BOTH FROM THE
S 1/4 Corner Section 7, T.10S, R.2W, WM

814 00 13

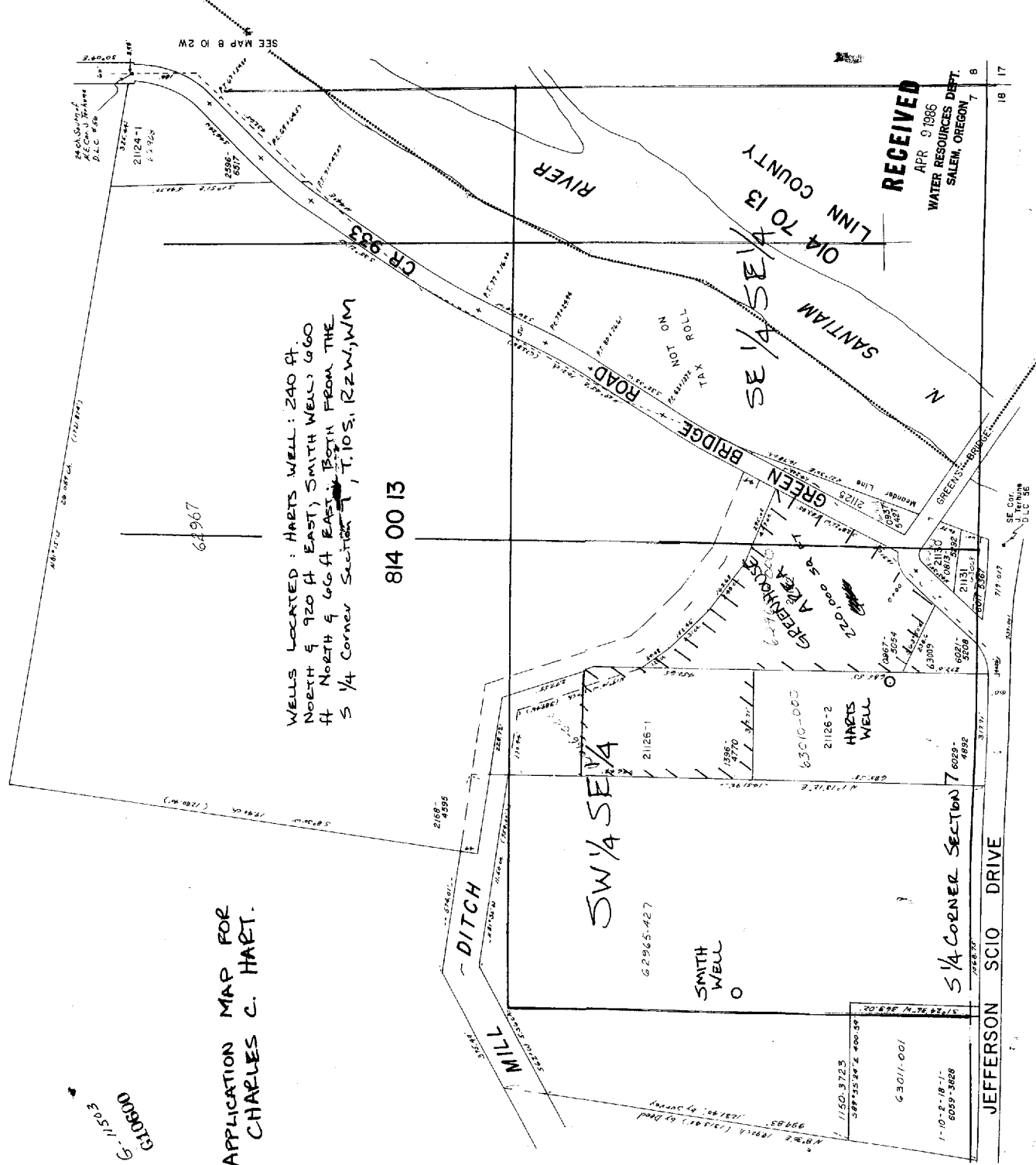

RECEIVED
APR 9 1986
WATER RESOURCES DEPT.
SALEM, OREGON